

ANNEXATION PLAT
LOCATED IN THE SOUTHEAST QUARTER OF SECTION 24,
TOWNSHIP 13 SOUTH, RANGE 9 EAST,
SALT LAKE BASE AND MERIDIAN
HELPER CITY, CARBON COUNTY, UTAH

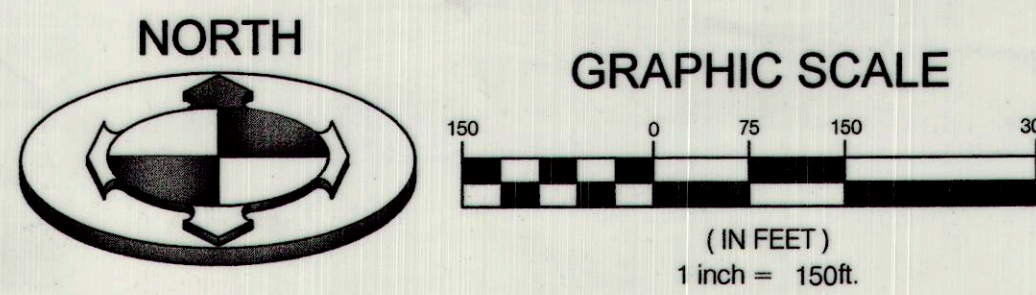

VICINITY MAP

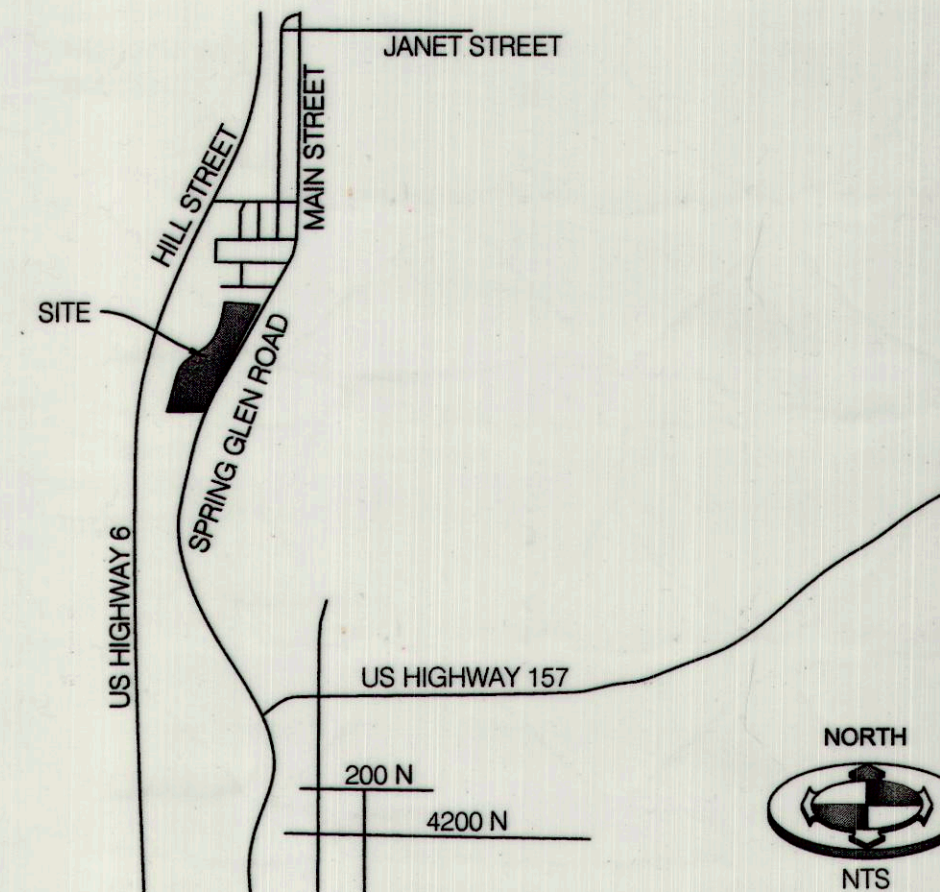

GENERAL NOTES

- 1) A FIELD SURVEY OF THE ANNEXATION AREA WAS NOT PERFORMED, THE PROPERTY DESCRIPTION WAS DETERMINED FROM THE RECORDS OF THE CARBON COUNTY SURVEYORS OFFICE, USING THE GENERALLY ACCEPTED UTAH STATE PLANE COORDINATES OF THE STANDARD SECTION CORNERS IN THE AREA.
- 2) PROPERTY PARCEL INFORMATION FROM THE CARBON COUNTY RECORDERS OFFICE WAS USED TO DETERMINE THE PRIVATE AND PUBLIC PROPERTY PARCELS SHOWN ON THIS ANNEXATION PLAT.
- 3) ALL BEARINGS AND DISTANCES ARE FROM CARBON COUNTY RECORDS.
- 4) NO PROPERTY CORNERS WERE SET FOR THIS ACTION.

PROPERTY DESCRIPTION

BEGINNING AT THE NORTHEAST CORNER OF THE SOUTHWEST QUARTER OF THE SOUTHEAST QUARTER OF SECTION 24, TOWNSHIP 13 SOUTH, RANGE 9 EAST, SALT LAKE BASE AND MERIDIAN, AND RUNNING THENCE SOUTH 644 FEET; THENCE WEST 350 FEET; THENCE NORTH 12 FEET; THENCE NORTH 3° WEST 320 FEET; THENCE NORTH 20°30' EAST 333 FEET; THENCE EAST 250 FEET TO THE PLACE OF BEGINNING.

ALSO, BEGINNING AT THE NORTHWEST CORNER OF THE SOUTHWEST QUARTER OF THE SOUTHEAST QUARTER OF SECTION 24, TOWNSHIP 13 SOUTH, RANGE 9 EAST, SALT LAKE BASE AND MERIDIAN, AND RUNNING THENCE SOUTH 382 FEET; THENCE NORTH 30°07' EAST ALONG THE WEST SIDE OF THE OLD STATE HIGHWAY 443.25 FEET, MORE OR LESS, TO THE NORTH LINE OF THE SOUTHEAST QUARTER OF THE SOUTHEAST QUARTER OF SAID SECTION 24; THENCE SOUTH 89°30' WEST ALONG SAID NORTH LINE 222.5 FEET TO THE PLACE OF BEGINNING.

EXCEPTING THEREFROM THE FOLLOWING DESCRIBED TRACT OF LAND, AS CONVEYED TO CARBON COUNTY, A BODY CORPORATION AND POLITIC OF THE STATE OF UTAH, IN THAT CERTAIN WARRANTY DEED RECORDED DECEMBER 11, 1922, AS ENTRY NO. 3865, IN BOOK 54, AT PAGE 378, RECORDS OF THE CARBON COUNTY RECORDER: BEGINNING 382 FEET SOUTH OF THE NORTHEAST CORNER OF THE SOUTHWEST QUARTER OF THE SOUTHEAST QUARTER OF SECTION 24, TOWNSHIP 13 SOUTH, RANGE 9 EAST, SALT LAKE BASE AND MERIDIAN, AND RUNNING THENCE SOUTH 29°45' WEST ALONG AN OLD FENCE LINE A DISTANCE OF 136 FEET; THENCE SOUTH 21° WEST A DISTANCE OF 155 FEET TO A POINT 644 FEET SOUTH OF THE NORTHEAST CORNER OF THE SOUTHWEST QUARTER OF THE SOUTHEAST QUARTER OF SAID SECTION 24; THENCE EAST 70 FEET, MORE OR LESS, TO THE DENVER AND RIO GRANDE RIGHT OF WAY; THENCE NORTHEAST ALONG SAID RIGHT OF WAY TO THE EAST LINE OF THE SOUTHWEST QUARTER OF THE SOUTHEAST QUARTER OF SAID SECTION 24; THENCE NORTH 150 FEET, MORE OR LESS, TO THE PLACE OF BEGINNING.

Ent 836249 W 883 P 243
Date: 25-APR-2017 1:31:05PM
For: Non-Filed By: CR
CARBON COUNTY RECORDER, Recorder
CARBON COUNTY CORPORATION
For: HELPER CITY

SURVEYOR'S CERTIFICATE

I, BRIAN A. LINAM, SALT LAKE CITY, UTAH, DO HEREBY CERTIFY THAT I AM A PROFESSIONAL LAND SURVEYOR AND THAT I HOLD LICENSE NO. 7240531 AS PRESCRIBED BY THE LAWS OF THE STATE OF UTAH; THAT I HAVE MADE A SURVEY OF THE FOLLOWING DESCRIBED PROPERTY, THAT THIS PLAT CORRECTLY SHOWS THE TRUE DIMENSIONS OF THE BOUNDARIES SURVEYED AND OF THE VISIBLE IMPROVEMENTS AFFECTING THE BOUNDARIES AND THEIR POSITION IN RELATIONSHIP TO SAID BOUNDARIES;



APPROVAL AS TO FORM

CITY ATTORNEY _____ DATE 4/25/17

HELPER CITY PLANNING COMMISSION APPROVAL

CHAIRPERSON _____ DATE 4/13/17

ATTEST: _____ DATE 4/13/17
APPROVAL BY COMMISSION SECRETARY

ACCEPTANCE BY LEGISLATIVE BODY:

THIS IS TO CERTIFY THAT WE, HAVE RECEIVED A PETITION SIGNED BY THE MAJORITY OF THE OWNERS OF THE TRACT OF LAND SHOWN HEREON REQUESTING THAT SAID TRACT BE ANNEXED INTO THE CITY OF HELPER AND THAT A COPY OF THE ORDINANCE HAS BEEN PREPARED FOR FILING HERewith ALL IN ACCORDANCE WITH THE UTAH CODE ANNOTATED 10-2-401 ET. SEQ. AS REVISED AND THAT WE HAVE EXAMINED AND DO HEREBY APPROVE AND EXCEPT THE ANNEXATION OF THE TRACT SHOWN AS A PART OF THE SAID CITY AND THAT SAID TRACT OF LAND IS KNOWN AS THE

Mountain States
DATED THIS 25TH DAY OF April 2017

MAYOR _____ COUNCILMAN _____

COUNCILMAN _____ COUNCILMAN _____

COUNCILMAN _____ COUNCILMAN _____

ATTEST: _____
RECORDER

BENCHMARK
ENGINEERING &
LAND SURVEYING
813 SOUTH STATE STREET SUITE #100
SANDY, UTAH 84070 (801) 542-7192
www.benchmarkcivil.com

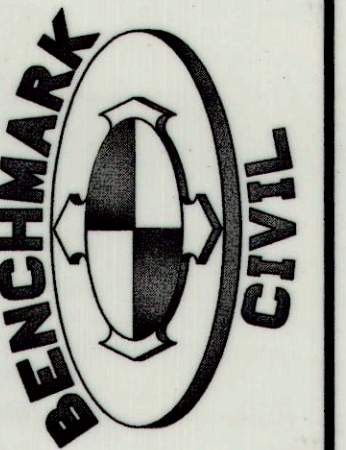

TOM LUND
STREET ADDRESS
HELPER CITY, UTAH

PROJECT NO. 1511192

ANNEXATION
PLAT

SVA.01
1 OF 1