

S.W.COR. SE  $\frac{1}{4}$  NW  $\frac{1}{4}$  SEC 21 T 14 S. R 10 E S. L. M.

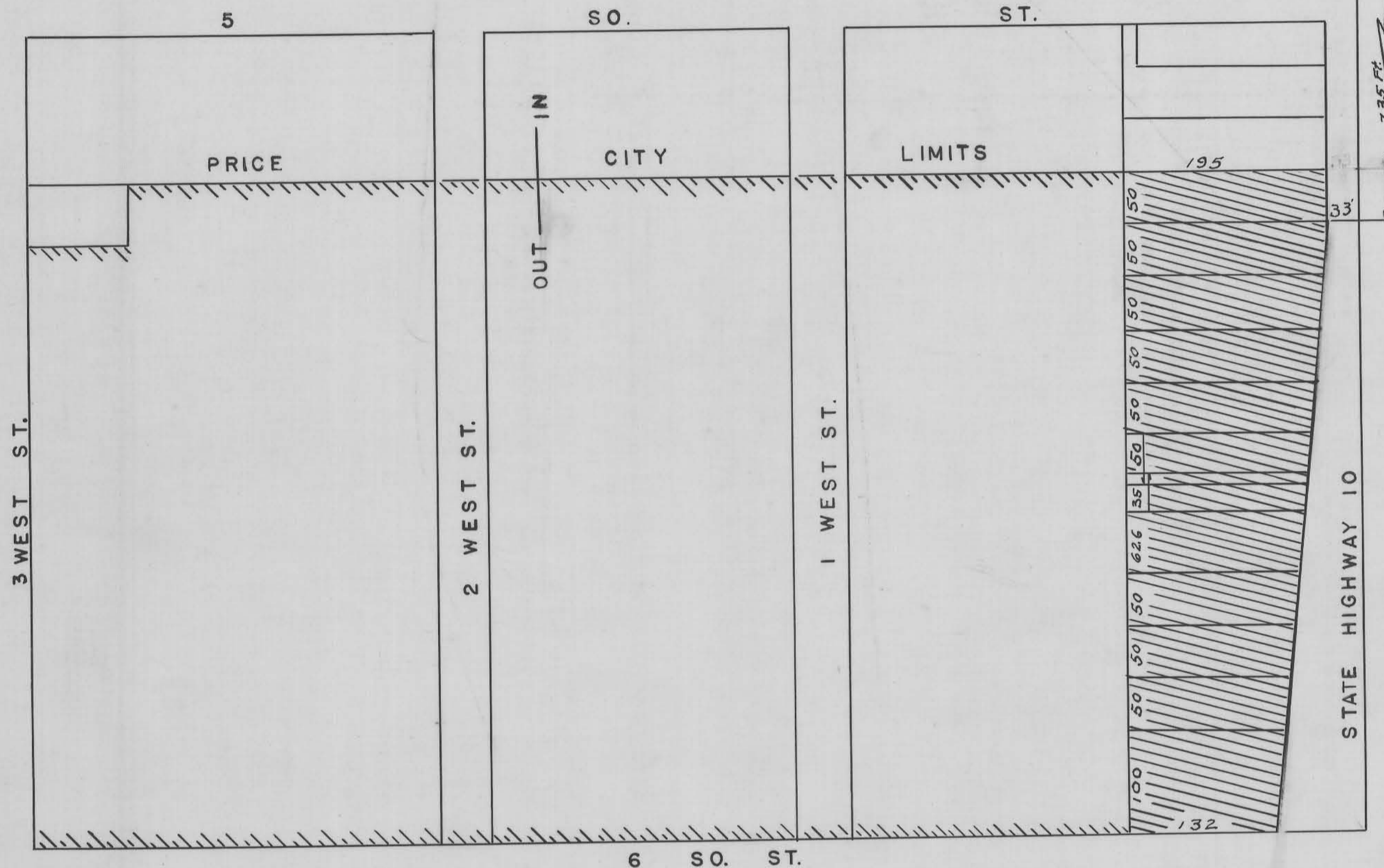

Entry No. 119124  
Indexed   
Abstracted   
Res. Fee

PLAT SHOWING LAND ANNEXED TO PRICE CITY BY ORDINANCE NO. - 1224-69-69  
SCALE 1 IN. = 100 FT.

ENGINEERS CERTIFICATE

Approved and accepted and ordered annexed to Price  
Municipal Corporation by Ordinance #1224-69 dated  
OCT. 13, 1969 adopted in regular session  
of the Council.

*Murray Mathis*  
MURRAY MATHIS, MAYOR

ATTEST:

*Kenneth T. Massey*  
KENNETH T. MASSEY, CITY RECORDER

(SEAL)

I, Dwight W. Wadleigh, by authority of the Mayor and Council of Price  
City, do hereby certify that this map is a true plat of the land to be  
annexed to the City of Price, Utah, by action of the City Council and  
Mayor by Ordinance #1224-69.

Said land is further described as follows:

Beginning at a point which is 735 ft. South and 33 ft. West of  
the Southwest corner of the SE  $\frac{1}{4}$  of the NW  $\frac{1}{4}$  of Section 21, Town-  
ship 14 South, Range 10 East, S.L.M., Thence North 50 ft. and  
running thence West along the present city limits of Price,  
Utah 195 ft; thence South 637.60 ft. more or less, to present  
corporate limits of Price City, Utah, thence East 132 ft.  
more or less to the West boundary line of Utah State Highway  
#10 and which is also designated locally as South Carbon Avenue;  
thence North easterly 590 ft. more or less along said highway  
boundary to the point of beginning.

*Dwight W. Wadleigh*  
DWIGHT W. WADLEIGH  
Acting City Engineer

*Luke Pappas*  
Luke Pappas, Notary Public  
Residing at Price, Utah  
My Commission expires APRIL 2, 1970