

CASTLEVIEW ANNEXATION - 1983

STATE OF UTAH
 COUNTY OF CARBON } 55
 FILED AND RECORDED FOR
 PRICE CITY
 Dec 30 1 34 PM '83
 BOOK 4 OF PLATS
 PAGE 250
 ANN O'BRIEN
 COUNTY RECORDER

ENGINEERS' CERTIFICATE

I, EVAN E. HANSEN, DO HEREBY CERTIFY THAT I AM A REGISTERED LAND SURVEYOR AND PROFESSIONAL ENGINEER AND THAT I HOLD CERTIFICATES No. 3115 No. 3354 RESPECTIVELY, AS PRESCRIBED UNDER THE LAWS OF THE STATE OF UTAH. I FURTHER CERTIFY THAT THIS IS A TRUE AND ACCURATE MAP OF THE TRACT OF LAND TO BE ANNEXED TO PRICE CITY, CARBON COUNTY, UTAH.

BOUNDARY DESCRIPTION

COMMENCING AT A POINT WHICH IS LOCATED SOUTH, 500 FT. AND WEST, 17.75 FT. FROM THE WEST 1/4 CORNER OF SECTION 17, TOWNSHIP 14 SOUTH, RANGE 10 EAST,

SALT LAKE BASE AND MERIDIAN; THENCE AS FOLLOWS:

COURSE	DISTANCE	REMARKS
EAST	287.34	Along North R-O-W Line Hospital Drive
NORTH	484.62	To West R-O-W Line Of Highway
S31°21'24"E	636.74	Along Highway R-O-W
N58°41'18"E	12.34	" " "
S29°19'53"E	882.21	" " "
WEST	795.17	" " "
S16°47'50"E	188.12	To West R-O-W Line Of A County Road
S73°12'10"W	90.00'	Along Said R-O-W
N16°47'50"W	116.80	Along Said R-O-W, On The Arc Of A 676.20 FT. Radius Curve To The Left, Through An Angle Of 18°29'26", Chord Bears N 26°02'33"W, 217.28 Ft.
NORTHWESTERLY	218.22'	To A Fence On The West Side Of A County Road.
S89°29'20"W	97.99'	Along Said Fence To Point Of Beginning
N0°34'39"W	721.80'	Containing 17.37 Acres More Or Less.

Basis Of Bearing Is Due North Between The Southwest Corner And The West 1/4 Corner Of Section 17, T14S, R10E, S.L.B.M.

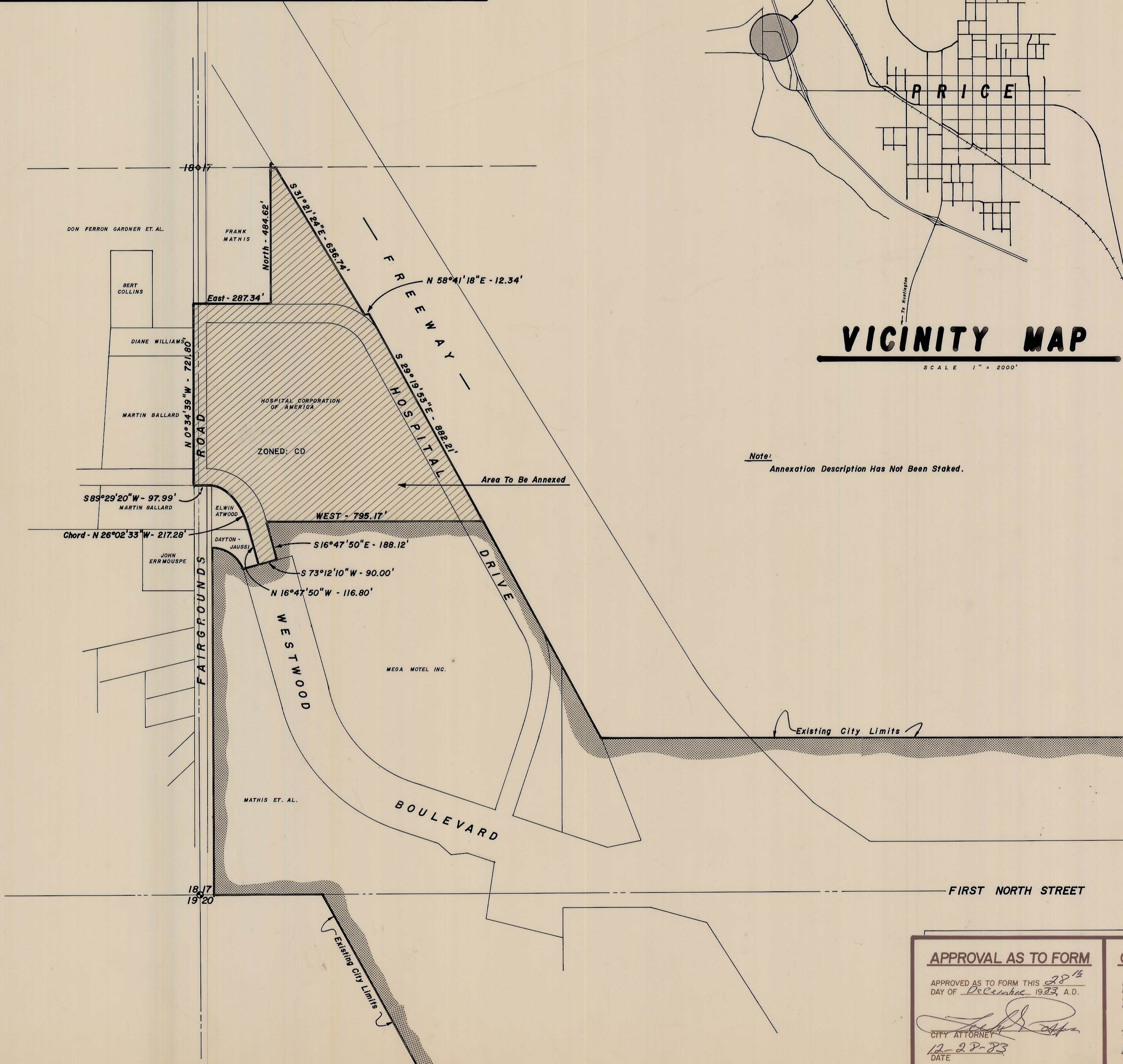
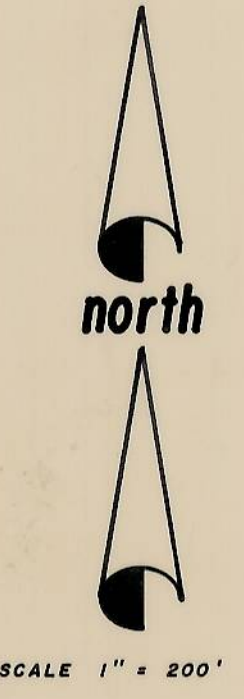
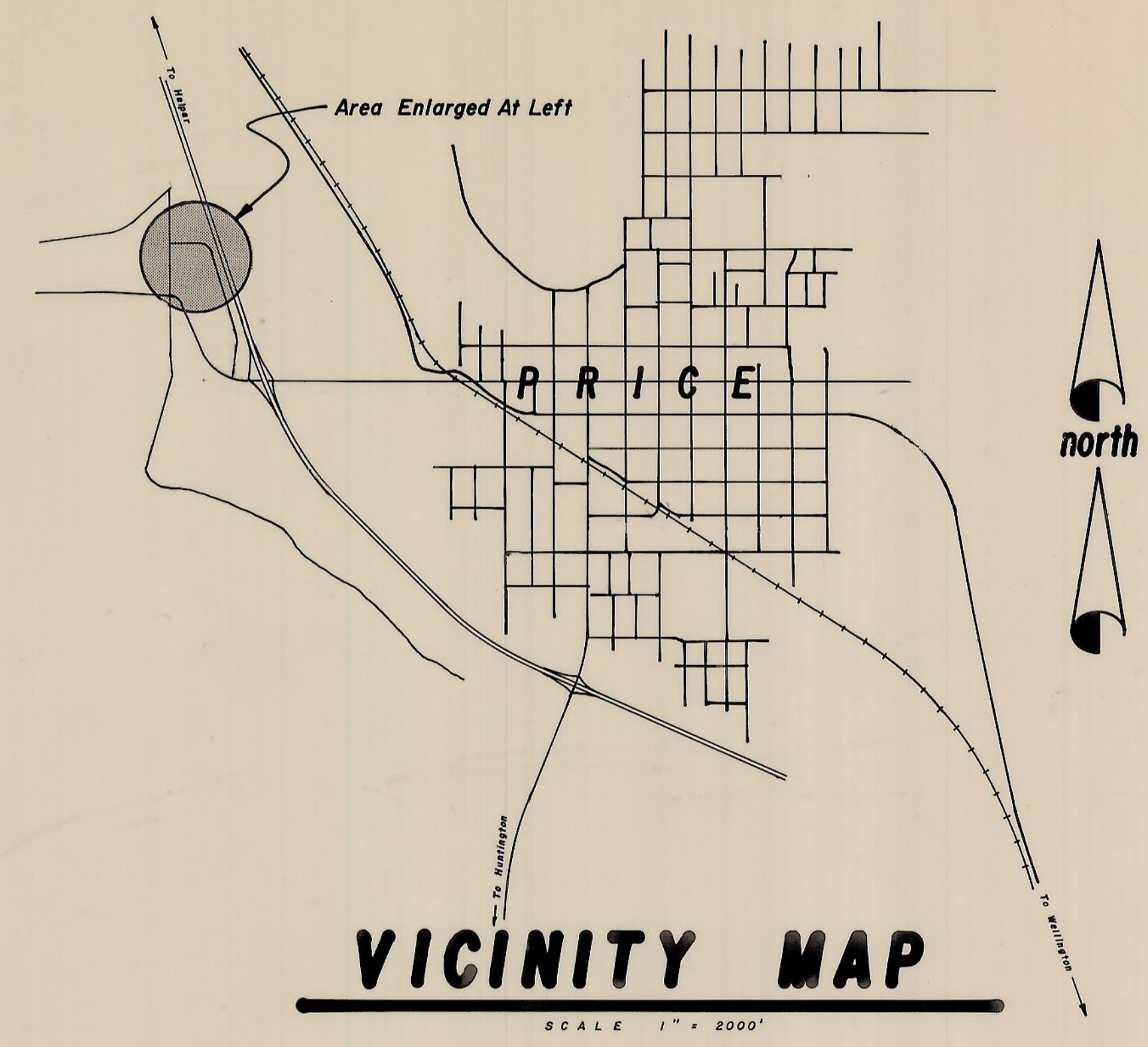

Note: Annexation Description Has Not Been Staked.

PETITION FOR ANNEXATION

THE OWNER(S) OF THE PROPERTY DESCRIBED ABOVE, NAMED HEREIN BELOW, HEREBY PETITION THE CITY COUNCIL OF PRICE, UTAH.

HOSPITAL CORPORATION OF AMERICA
 AGENT: DON LARSEN - ADMINISTRATOR, CASTLEVIEW HOSPITAL
 SIGNED THIS 5TH DAY OF OCTOBER 1983, A.D.

ACCEPTANCE BY LEGISLATIVE BODY
 THIS IS TO CERTIFY THAT WE, PRICE CITY COUNCIL, HAVE RECEIVED A PETITION SIGNED BY A MAJORITY OF THE OWNERS OF THE TRACT SHOWN HEREON REQUESTING THAT SAID TRACT BE ANNEXED TO THE CITY OF PRICE AND THAT A COPY OF THE ORDINANCE HAS BEEN PREPARED FOR A FILING HERewith ALL IN ACCORDANCE WITH THE UTAH CODE ANNOTATED (MAY 8, 1979) 10-2-401 THRU 423 AND THAT WE HAVE EXAMINED AND DO HEREBY APPROVE AND ACCEPT THE ANNEXATION OF THE TRACT AS SHOWN AS A PART OF SAID CITY AND THAT SAID TRACT OF LAND IS TO BE KNOWN HEREAFTER AS THE CASTLEVIEW ANNEXATION.

DATED THIS 28TH DAY OF DECEMBER 1983, A.D.
 PRICE CITY, A MUNICIPAL CORPORATION.
 BY: *Aut hee Matinea* CITY MAYOR
Thomas L. Jensen COUNCILMAN
Michael M. Frame COUNCILMAN
Paul Denison COUNCILMAN
Thurmond Spadec COUNCILMAN
Samuel Williams COUNCILMAN

ATTEST: *Janet M. ...* RECORDER
 RECORDERS SEAL

APPROVAL AS TO FORM
 APPROVED AS TO FORM THIS 28TH DAY OF December 1983, A.D.
...
 CITY ATTORNEY
 DATE: 12-28-83

CITY ENGINEERS' CERTIFICATE
 I HEREBY CERTIFY THAT I HAVE HAD THIS PLAT EXAMINED BY THIS OFFICE AND THAT IT IS CORRECT AND IN ACCORDANCE WITH INFORMATION ON FILE IN THIS OFFICE.
...
 CITY ENGINEER
 DATE: Dec. 28, 1983

EMPIRE ENGINEERING
 86 NORTH 200 EAST
 PRICE, UTAH 84501 PHONE (801) 637-7498
ANNEXATION PLAT
Castleview Annexation - 1983
 DRAWN BY: B.L.P. APPROVED BY: DRAWING NO.:
 SCALE: AS NOTED DATE: 12/23/83 EESD - 031 D