

**MINOR SUBDIVISION**  
**COUNTY PLANNING & ZONING COMMISSION**  
**APPROVAL & ACCEPTANCE**

PRESENTED TO THE CARBON COUNTY PLANNING & ZONING COMMISSION THIS 19 DAY OF Sept, 1996 AT WHICH TIME THIS PETITION FOR WAS APPROVED AND ACCEPTED, AS A MINOR SUBDIVISION.

*Robert W. Y. Cobb*  
 PLANNING & ZONING COMMISSION CHAIRMAN

**COUNTY ENGINEERS CERTIFICATE**

I HEREBY CERTIFY THAT THIS OFFICE HAS EXAMINED THIS PLAT AND IT IS CORRECT IN ACCORDANCE WITH THE INFORMATION ON FILE IN THIS OFFICE.

*Nick Hansen* Sept. 17, 1996  
 ASST. CARBON COUNTY ENGINEER DATE

**PROPERTY OWNER**

I HAVE REVIEWED AND DO HEREBY APPROVE.

*Tracie Coleman* Sept 18, 96  
 PROPERTY OWNER DATE

NEILCO CONTRACTORS INC.

NEIL & VONDA FRANSDEN

DANNY G. COLEMAN

DANNY COLEMAN

DUANE A. FRANSDEN

DANNY & TRACIE COLEMAN

**LOT 1**  
 2.5 ACRES

**DANNY COLEMAN MINOR SUBDIVISION**

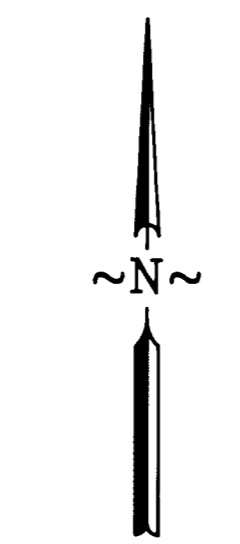

SCALE: 1" = 30'

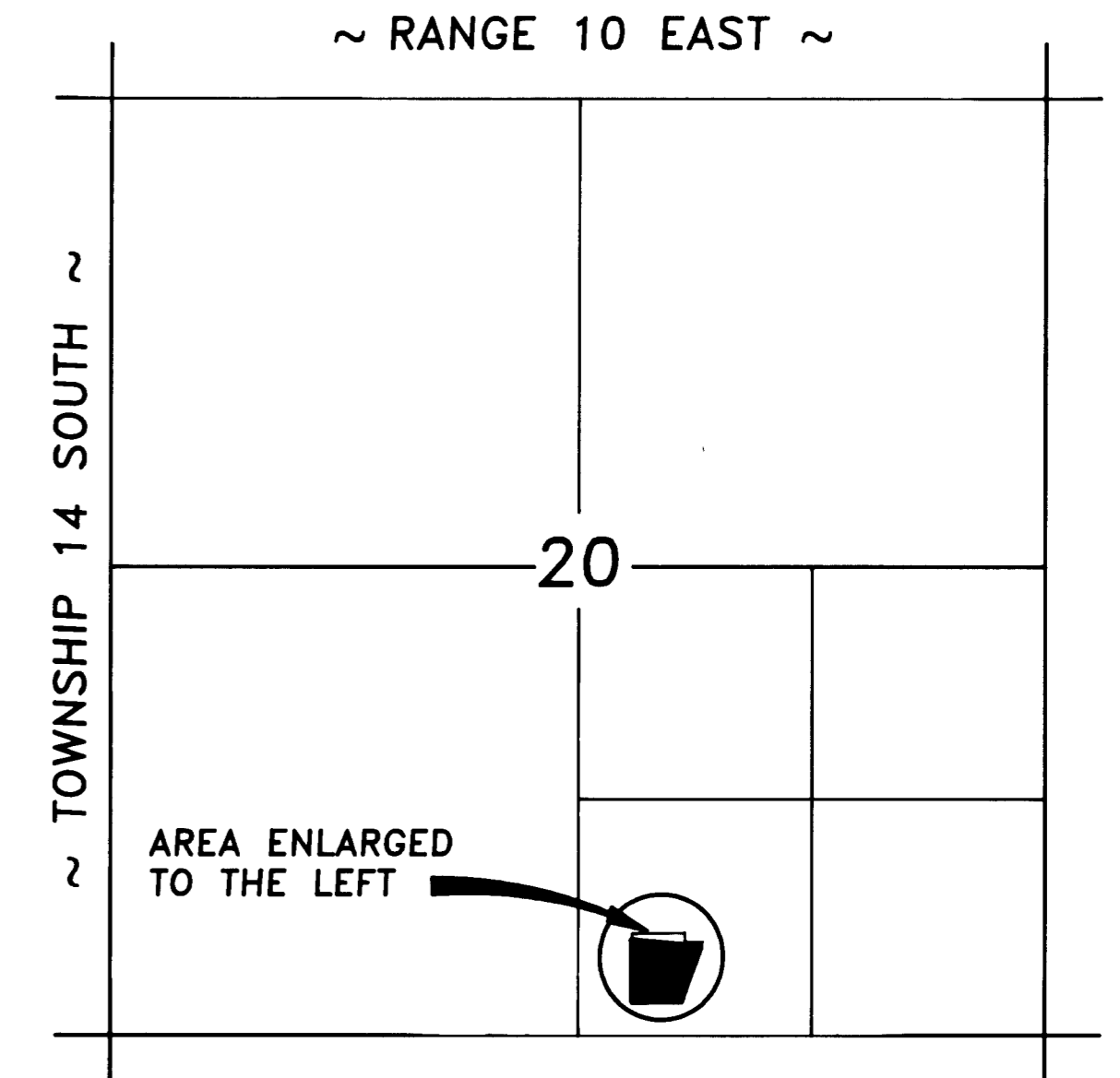

**VICINITY MAP**



**LEGEND**

- SECTION CORNER
- PROPERTY LINE
- 5/8" x 24" REBAR SET WITH CAP

**DESCRIPTION LOT 1**

A PARCEL OF LAND LOCATED IN CARBON COUNTY, STATE OF UTAH, WHICH IS IN THE SOUTHWEST QUARTER OF THE SOUTHEAST QUARTER OF SECTION 20, TOWNSHIP 14 SOUTH, RANGE 10 EAST, SALT LAKE BASE AND MERIDIAN, BEING FURTHER DESCRIBED AS FOLLOWS WITH A BEARING OF N 89°22'27" E BETWEEN THE SOUTH QUARTER CORNER AND THE SOUTHEAST CORNER OF SAID SECTION 20 USED AS THE BASIS OF BEARING.

BEGINNING AT A POINT WHICH IS LOCATED N 89°22'27" E, 806.45 FEET ALONG THE SECTION LINE AND N 0°30'55" W, 1072.28 FEET FROM THE SOUTH QUARTER CORNER OF SECTION 20, TOWNSHIP 14 SOUTH, RANGE 10 EAST, SALT LAKE BASE AND MERIDIAN; AND RUNNING THENCE S 84°45'46" E, 280.75 FEET; THENCE S 82°17'42" E, 111.75 FEET; THENCE S 20°00'56" W, 318.53 FEET; THENCE S 89°29'08" W, 278.19 FEET; THENCE N 00°30'55" W, 342.41 FEET TO THE POINT OF BEGINNING.

CONTAINS 2.50 ACRES, MORE OR LESS.

**ALSO ROAD DESCRIPTION**

BEGINNING AT A POINT WHICH IS LOCATED NORTH 89°22'27" EAST, 1196.34 FEET ALONG THE SECTION LINE AND NORTH 0°30'55" WEST, 1072.42 FEET FROM THE SOUTH QUARTER CORNER OF SECTION 20, TOWNSHIP 14 SOUTH, RANGE 10 EAST, SALT LAKE BASE AND MERIDIAN; SAID POINT OF BEGINNING IS THE NORTHEAST CORNER OF A 2.5 ACRE PARCEL OF LAND BELONGING TO DANNY G. AND TRACIE C. COLEMAN; AND RUNNING THENCE NORTH 20°00'56" EAST, 78.50 FEET TO THE RIGHT-OF-WAY LINE OF A COUNTY ROAD (FAIRGROUNDS ROAD); THENCE SOUTH 58°03'00" EAST, 35.77 FEET ALONG THE SOUTH RIGHT-OF-WAY LINE OF SAID COUNTY ROAD; THENCE SOUTH 20°00'56" WEST, 104.10 FEET; THENCE NORTH 69°59'04" WEST, 35.00 FEET; THENCE NORTH 20°00'56" EAST, 35.00 FEET TO THE POINT OF BEGINNING.

CONTAINS 0.087 ACRES, MORE OR LESS.

**ENGINEER'S CERTIFICATE**

I, EVAN E. HANSEN, DO HEREBY CERTIFY THAT I AM A REGISTERED LAND SURVEYOR AND PROFESSIONAL ENGINEER HOLDING CERTIFICATE NO. 145656 AS PRESCRIBED UNDER THE LAWS OF THE STATE OF UTAH. I FURTHER CERTIFY THAT I HAVE MADE A SURVEY OF THE TRACT OF GROUND SHOWN AND THAT IT IS TRUE AND CORRECT TO THE BEST OF MY KNOWLEDGE.

*Evan E. Hansen* APRIL 10, 1997  
 EVAN E. HANSEN DATE

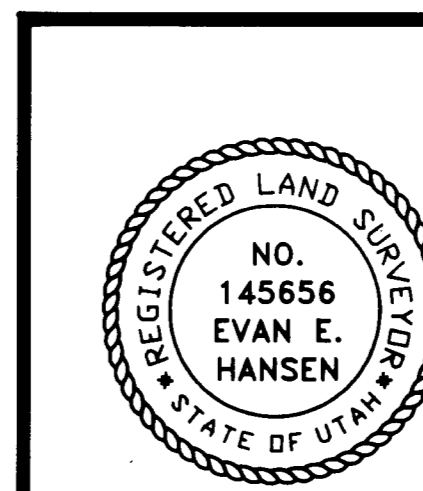

SW1/4 SE1/4 SECTION 20, T 14 S, R 10 E, S.L.B.		
<b>Empire Engineering &amp; Land Sur</b>		
1665 E. Sagewood Rd. Price, Utah 84501 Phone (801)		
Property Survey For: MINOR SUBDIVISION PLAT FOR DANNY COLEMAN		
Drawn By: THK	Approved By: EEH	Approved By:
Date: 6/17/96	Scale: 1" = 30'	EESD-

20-14-10

DANNY COLEMAN