

Fox Meadows Subdivision

File: 842738-B-91P-741
 Date: 23-AUG-2018 9:27:35AM
 Feet: 635.00 Check: Filed By: CR
 CARBON COUNTY RECORDER, Recorder
 CARBON COUNTY CORPORATION
 Fort VERA JEAN GERRARD TR.

NARRATIVE
 THE PURPOSE OF THIS SURVEY IS TO LOCATE AND SUBDIVIDE PARCEL 02-0750-0001.
 THE BASIS OF BEARING USED FOR THIS SURVEY IS SOUTH 00°31'54" EAST BETWEEN THE WEST QUARTER CORNER AND THE SOUTHWEST CORNER OF SECTION 7, TOWNSHIP 14 SOUTH, RANGE 10 EAST, SALT LAKE BASE AND MERIDIAN.
 A RECORD OF SURVEY BY JOHANSEN & TUTTLE ENGINEERING RECORDED AS ENTRY 840798, BOOK 903, PAGE 596 IN THE OFFICIAL RECORDS OF THE CARBON COUNTY RECORDER WAS USED AS A REFERENCE IN PREPARING THIS PLAT.

CERTIFICATE OF SURVEY
 I, M. CODY WARE, DO HEREBY CERTIFY THAT I AM A PROFESSIONAL LAND SURVEYOR, LICENSE NO. 4940688 AS PRESCRIBED BY THE LAWS OF THE STATE OF UTAH. I FURTHER CERTIFY THAT BY AUTHORITY OF THE OWNERS(S), I HAVE MADE A SURVEY OF THE TRACT OF LAND SHOWN ON THIS PLAT AND DESCRIBED BELOW, AND SUBDIVIDED SAID TRACT OF LAND INTO LOT(S), HEREAFTER TO BE KNOWN AS THE:

FOX MEADOWS SUBDIVISION

AND THAT THE SAME HAS BEEN CORRECTLY SURVEYED AND STAKED ON THE GROUND AS SHOWN HEREON.

BOUNDARY DESCRIPTION

BEGINNING AT A POINT WHICH LIES 888.46 FEET SOUTH 00°31'54" EAST ALONG SECTION LINE AND 1625.92 FEET EAST FROM THE WEST QUARTER CORNER OF SECTION 7, TOWNSHIP 14 SOUTH, RANGE 10 EAST, SALT LAKE BASE AND MERIDIAN, AND RUNNING THENCE EAST 600.89 FEET; THENCE SOUTH 420.22 FEET; THENCE SOUTH 88°36'40" WEST 118.08 FEET TO A POINT OF CURVATURE OF A 55.00 FOOT RADIUS, NON-TANGENT CURVE TO THE LEFT; THENCE SOUTHWESTERLY 205.03 FEET ALONG THE ARC OF SAID CURVE THROUGH A CENTRAL ANGLE OF 213°35'18" (CHORD BEARS: S71°49'12"W 105.31'); THENCE NORTH 88°47'28" WEST 71.27 FEET; THENCE NORTH 55°24'39" WEST 26.53 FEET; THENCE NORTH 01°13'03" WEST 143.84 FEET; THENCE SOUTH 86°21'19" WEST 287.23 FEET; THENCE NORTH 313.83 FEET TO THE POINT OF BEGINNING.
 CONTAINS 5.00 ACRES.
 RESERVING THEREFROM A 20.00 FOOT WIDE ACCESS EASEMENT FOR THE PURPOSE OF INGRESS AND EGRESS FOR THE CURRENT OWNERS OF PARCEL 02-0750-0001 ONLY, AND BEING 10.00 FEET ON EACH SIDE OF THE FOLLOWING DESCRIBED CENTERLINE:
 BEGINNING AT A POINT WHICH LIES 888.46 FEET SOUTH 00°31'54" EAST ALONG SECTION LINE AND 1625.92 FEET EAST AND 201.37 FEET SOUTH FROM THE WEST QUARTER CORNER OF SECTION 7, TOWNSHIP 14 SOUTH, RANGE 10 EAST, SALT LAKE BASE AND MERIDIAN, AND RUNNING THENCE EAST 327.34 FEET; THENCE SOUTH 00°11'48" WEST 179.90 FEET; THENCE SOUTH 66°53'57" EAST 54.96 FEET AND TERMINATING.

[Signature]
 M. CODY WARE
 DATE: Aug 20, 2018

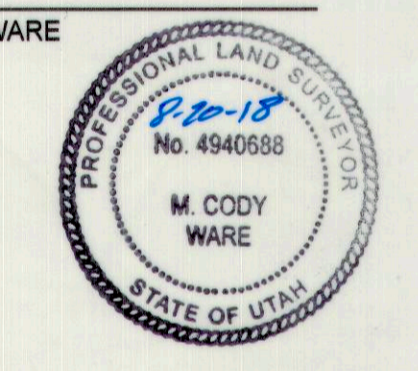

ACKNOWLEDGMENT AND DEDICATION
 KNOW ALL MEN BY THESE PRESENTS, THAT _____ THE _____ UNDERSIGNED OWNER(S) OF THE ABOVE DESCRIBED TRACT OF LAND, HAVING CAUSED THE SAME TO BE SUBDIVIDED INTO LOT(S) TO BE HEREAFTER KNOWN AS THE:

FOX MEADOWS SUBDIVISION

DO HEREBY APPROVE THIS PLAT AND DEDICATE FOR THE PERPETUAL USE OF THE PUBLIC THE ROADS SHOWN HEREON.

IN WITNESS WHEREOF WE HAVE HEREUNTO SET OUR HANDS THIS 23 DAY OF August, 2018.

Vera Jean Seward Justice By *Lori A Peterson*

STATE OF UTAH } S.S.
 COUNTY OF CARBON }
 ON THE 23 DAY OF AUGUST, 2018 PERSONALLY APPEARED BEFORE ME THE SIGNERS OF THE FOREGOING DEDICATION WHO DULY ACKNOWLEDGED TO ME THAT THEY DID EXECUTE THE SAME.

[Signature]
 NOTARY PUBLIC
 MY COMMISSION EXPIRES 03/04/2020



VICINITY MAP
 TOWNSHIP 14 SOUTH, RANGE 10 EAST, S.L.B.&M.

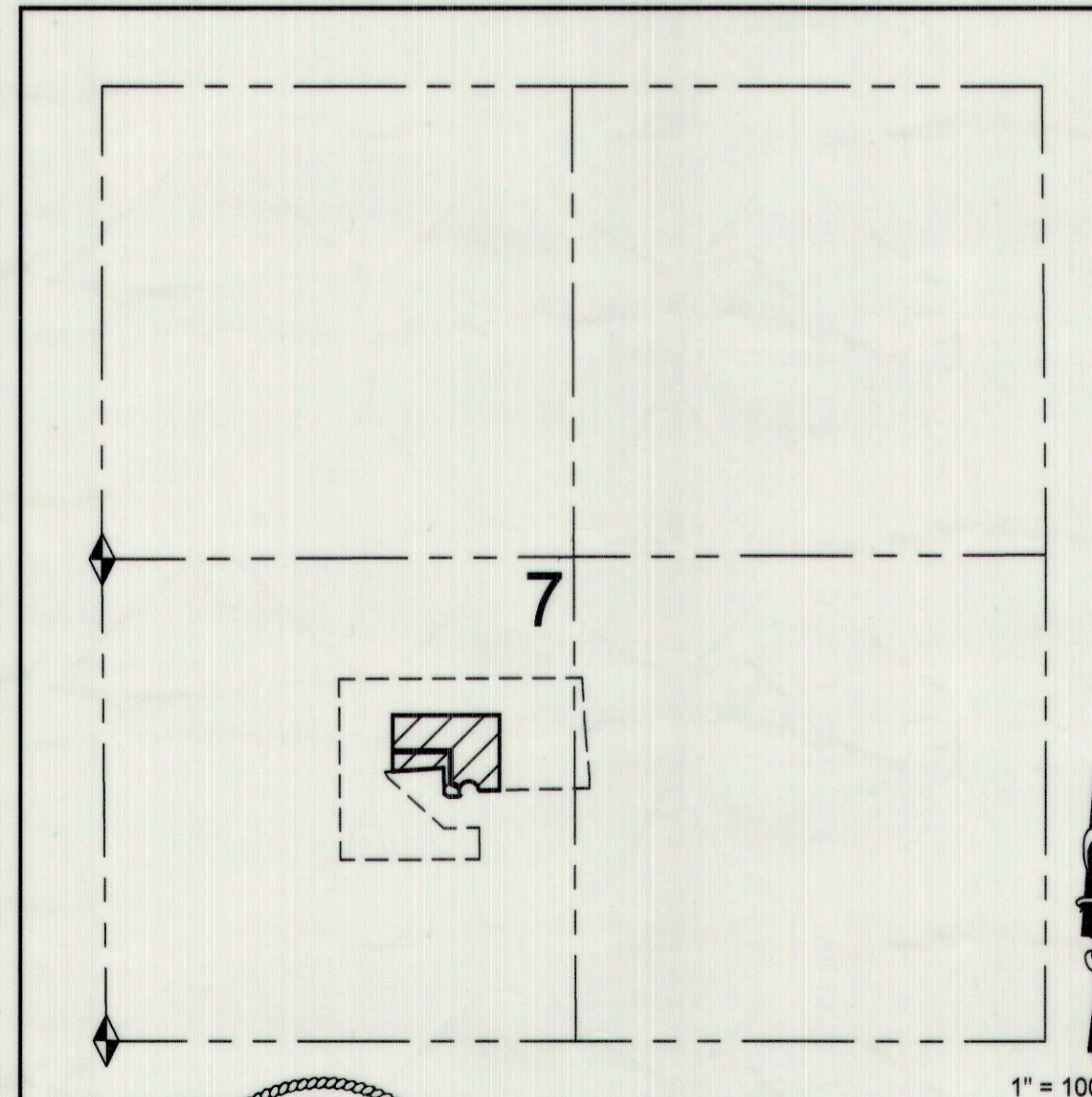

- LEGEND**
- SUBDIVISION/LOT BOUNDARY
 - - - SECTION LINE
 - - - - - PARCEL LINE
 - x - x - FENCE LINE
 - SET 5/8" REBAR & CAP
 - FOUND PROPERTY CORNER/MONUMENT
 - ◆ FOUND SECTION MONUMENT

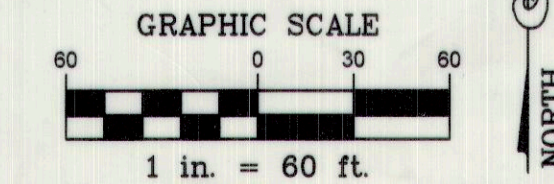

CARBON COUNTY ATTORNEY <i>[Signature]</i> GENE STRATE DATE: <u>8/20/18</u>	CARBON COUNTY PLANNING COMMISSION <i>[Signature]</i> RICHARD TATTON, CHAIRMAN DATE: <u>8-20-18</u>	CONTRACT CARBON COUNTY SURVEYOR <i>[Signature]</i> DATE: <u>8/22/18</u>	CARBON COUNTY RECORDER COUNTY OF CARBON, RECORDED AND FILED AT THE REQUEST OF: <i>[Signature]</i> BOOK <u>912</u> PAGE <u>741</u> Laurie Trvon
---	---	---	--

NO.	DATE	DESCRIPTION	BY
1	07-26-18	PLOTTED FOR REVIEW	M.C.W.
2	08-20-18	ADDED EASEMENT, PLOTTED MYLAR	M.C.W.

WARE SURVEYING, L.L.C.
 Phone: 435-820-4335
 Email: waresurveying@emerytelcom.net
 1344 North 1000 West
 Price, Utah 84501