

00062603 Bk00005 Pg00026-00026

ANN B. O'BRIEN-COUNTY OF CARBON  
1997 OCT 29 09:55 AM FEE \$ .00 BY  
REQUEST: EAST CARBON CITY

SURVEYOR'S CERTIFICATE

I, VAL J. HAWS DO HEREBY CERTIFY THAT I AM A REGISTERED LAND SURVEYOR, AND THAT I HOLD CERTIFICATE No. 158367, AS PRESCRIBED UNDER THE LAWS OF THE STATE OF UTAH. I FURTHER CERTIFY THAT BY AUTHORITY OF THE OWNERS, I HAVE MADE A SURVEY OF THE ROADWAY SHOWN ON THIS PLAT AND DESCRIBED BELOW, HEREAFTER TO BE KNOWN AS:

INDUSTRIAL AVENUE

ROADWAY DESCRIPTION

BEGINNING AT A POINT NORTH 792.29 FEET AND EAST 1,993.58 FEET FROM THE WEST 1/4 CORNER OF SECTION 10, TOWNSHIP 15 SOUTH, RANGE 13 EAST, S.L.B.&M.; SAID POINT BEING ON THE SOUTH RIGHT-OF-WAY LINE OF UTAH STATE HIGHWAY 123; THENCE ALONG SAID SOUTH RIGHT-OF-WAY LINE, N80°15'00"E, 60.03 FEET; THENCE S11°27'08"E, 476.75 FEET; THENCE S11°28'31"E, 364.56 FEET TO A POINT ON THE CENTER SECTION LINE OF SAID SECTION 10; THENCE S13°02'50"E, 159.89 FEET; THENCE S12°08'05"E, 321.14 FEET; THENCE S11°43'13"E, 314.49 FEET; THENCE S16°38'35"E, 86.68 FEET; THENCE S28°26'01"E, 61.20 FEET; THENCE S34°26'00"E, 44.26 FEET; THENCE S45°41'53"E, 23.74 FEET; TO A POINT ON THE NORTH RIGHT-OF-WAY LINE OF THE D. & R.G.W. RAILROAD; THENCE N82°07'22"W, 88.94 FEET ALONG SAID RIGHT-OF-WAY LINE; THENCE NORTH WESTERLY ALONG THE EAST LINE OF PACIFIC CENTRAL PROPERTY THE FOLLOWING CALLS: N28°26'01"W, 81.41 FEET; THENCE N16°38'55"W, 95.45 FEET; THENCE N11°43'13"W, 316.86 FEET; THENCE N12°08'05"W, 61.81 FEET TO A POINT ON THE NORTH LINE OF PACIFIC CENTRAL PROPERTY; THENCE N12°08'05"W, 258.63 FEET; THENCE N13°02'50"W, 173.82 FEET TO A POINT ON THE EAST/WEST CENTER SECTION LINE OF SAID SECTION 10; THENCE N11°24'53"W, 359.71 FEET; THENCE N11°27'07"W, 478.56 FEET TO A POINT ON THE SOUTH RIGHT-OF-WAY LINE OF STATE HIGHWAY 123 AND THE POINT OF BEGINNING. CONTAINING 2.53 ACRES MORE OR LESS.

Aug. 7 1997  
DATE:

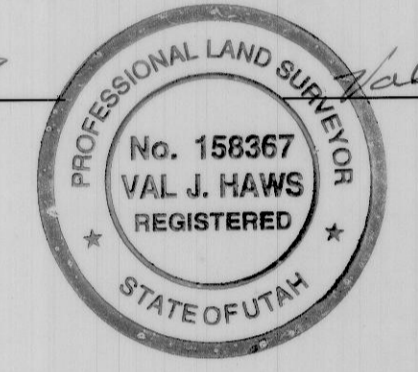

CREAMER & NOBLE, INC.  
435 EAST TABERNACLE  
ST. GEORGE, UTAH 84770  
VAL J. HAWS LS #158367

OWNER'S DEDICATION

KNOW ALL MEN BY THESE PRESENTS THAT THE UNDERSIGNED OWNER(S) OF THE ABOVE DESCRIBED ROADWAY, TO BE HEREAFTER KNOWN AS:

INDUSTRIAL AVENUE

DO HEREBY DEDICATE AND CONVEY TO THE CITY OF EAST CARBON FOR PERPETUAL USE OF THE PUBLIC ALL PARCELS OF LAND SHOWN ON THIS PLAT AS PUBLIC STREETS AND EASEMENTS. IN WITNESS I HAVE HEREUNTO SET MY HAND THIS 28th DAY OF Oct, 1997.

BY: L. Paul Clark  
EAST CARBON CITY: L. PAUL CLARK (MAYOR)  
BY: Jaylene F. Marakis  
ATTEST: JAYLENE F. MARAKIS (RECORDER)

ACKNOWLEDGMENT

STATE OF UTAH }  
COUNTY OF CARBON } S.S.  
ON THIS 28th DAY OF Oct, 1997, PERSONALLY APPEARED BEFORE ME, L. PAUL CLARK, WHO BEING BY ME DULY SWORN, DID SAY THAT HE IS THE MAYOR OF EAST CARBON CITY, AND THAT HE EXECUTED THE FOREGOING ROADWAY DEDICATION ON BEHALF OF SAID EAST CARBON CITY, BY AUTHORITY OF A RESOLUTION OF ITS CITY COUNCIL, AND HE DID ACKNOWLEDGE TO ME THAT EAST CARBON CITY EXECUTED THE SAME FOR THE USES AND PURPOSES STATED THEREIN.

MY COMMISSION EXPIRES: 9/24/98  
WADALENE C. WILLIAMS  
NOTARY PUBLIC - STATE OF UTAH  
CARBON COUNTY  
120 EAST MAIN  
PRICE, UT 84501  
COMM. EXP. 9-21-98

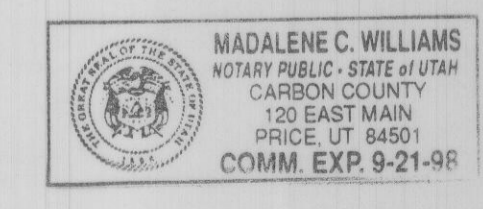

ROADWAY DEDICATION PLAT  
INDUSTRIAL AVENUE

RECORDED No. 62603  
STATE OF UTAH, COUNTY OF CARBON  
RECORDED AND FILED AT THE REQUEST OF: East Carbon City  
DATE: Oct. 29, 1997 TIME: 9:55 AM BOOK: 506 PLATS PAGE: 26  
FEE \$ .00  
Val B. O'Brien  
COUNTY RECORDER

EAST 1,993.58'

UTAH STATE HIGHWAY 123  
N80°15'00"E  
60.03'

P.O.B.

SECTION LINE  
NORTH 796.29'

EAST CARBON CITY

EAST CARBON CITY

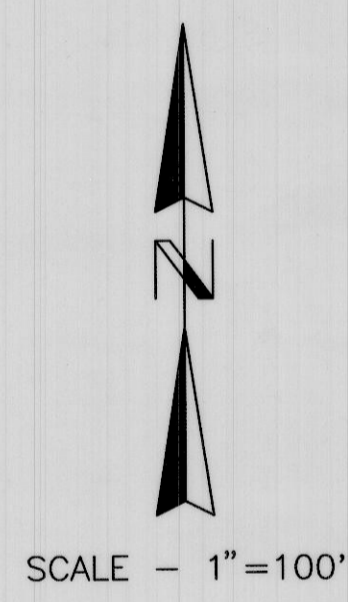

LEGEND

- ◆ FOUND SECTION CORNER MONUMENT
- SET 16"x1/2" REBAR WITH YELLOW CAP MARKED: "CREAMER & NOBLE"

FOUND ALUMINUM CAP  
WEST 1/4 CORNER,  
SEC. 10, T15S, R13E, SLB&M.

FOUND ALUMINUM CAP  
NW CORNER, NE 1/4, SW 1/4,  
SEC. 10, T15S, R13E, SLB&M.

S89°32'00"E 808.65'  
CENTER SECTION LINE

S89°32'00"E 1,349.64' (BASIS OF BEARING)  
BLM SURVEY 1983

PACIFIC CENTRAL  
RECORD OF SURVEY  
CREAMER & NOBLE INC.  
3/6/97

U.S.A.  
B.L.M. ADMINISTERED

PROPERTY LINE AS SHOWN  
ON A RECORD OF SURVEY  
CARBON COUNTY ENGINEERING  
DEPARTMENT (4/30/96)

(RECORD SO'44'08"W 1,321.50') MEASURED SO'44'40"W 1,321.20'

FOUND ALUMINUM CAP  
SW CORNER, NE 1/4, SW 1/4,  
SEC. 10, T15S, R13E, SLB&M.

D. & R. G. W. RAIL ROAD

CREAMER & NOBLE ENGINEERS  
ST. GEORGE, UTAH  
DRAWN BY: DRL CHECKED BY: VJH DATE: JULY 1997

PLANNING COMMISSION  
APPROVED THIS DAY OF A.D. 19 BY THE CITY PLANNING COMMISSION.  
CHAIRMAN, PLANNING COMMISSION

CITY ENGINEER'S CERTIFICATE  
I HEREBY CERTIFY THAT THIS OFFICE HAS EXAMINED THIS PLAT AND IT IS CORRECT IN ACCORDANCE WITH INFORMATION ON FILE IN THIS OFFICE.  
DATE CITY ENGINEER

APPROVAL AS TO FORM  
APPROVED AS TO FORM THIS DAY OF A.D. 19  
CITY ATTORNEY

ACCEPTANCE  
PRESENTED TO THE EAST CARBON CITY COUNCIL ON THE DAY OF A.D. 1997 AT WHICH TIME THIS PLAT WAS APPROVED AND ACCEPTED.  
CITY RECORDER

