

SURVEYOR'S CERTIFICATE

I, ART F. BARKER DO HEREBY CERTIFY THAT I AM A REGISTERED LAND SURVEYOR, AND THAT I HOLD CERTIFICATE NO. 162812, AS PRESCRIBED BY THE LAWS OF THE STATE OF UTAH, I FURTHER CERTIFY THAT BY AUTHORITY OF THE OWNERS, I HAVE MADE A SURVEY OF THE TRACT OF LAND SHOWN ON THIS PLAT AND DESCRIBED BELOW, AND SUBDIVIDED SAID TRACT OF LAND INTO LOTS AND STREETS, HEREAFTER TO BE KNOWN AS:

JENSEN SUBDIVISION HIGHWAY 10 SOUTH

AND THAT THE SAME HAS BEEN CORRECTLY SURVEYED AND STAKED ON THE GROUND AS SHOWN ON THIS PLAT.

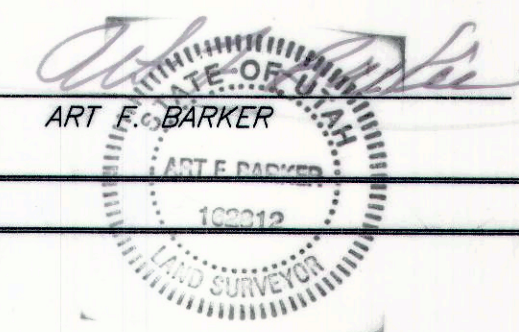

ART F. BARKER

DATE

BOUNDARY DESCRIPTION

BEGINNING AT A POINT S00°33'47"E 933.81 FEET ALONG THE SECTION LINE AND N89°17'09"E 22.00 FEET FROM THE WEST QUARTER CORNER OF SECTION 28 TOWNSHIP 14 SOUTH RANGE 10 EAST OF THE SALT LAKE BASE & MERIDIAN, SAID POINT BEING ON THE EASTERLY RIGHT OF WAY LINE OF HIGHWAY 10 THENCE ALONG SAID LINE S00°33'47"E 150.00 FEET; THENCE N89°17'09"E 255.62 FEET; THENCE S00°33'47"E 255.62 FEET TO THE 40 ACRE LINE; THENCE ALONG SAID LINE N89°17'09"E 1048.69 FEET; THENCE N00°31'38"W 420.60 FEET; THENCE S53°39'21"W 197.32 FEET; THENCE S75°30'00"W 360.00 FEET; THENCE N66°00'00"W 390.00 FEET; THENCE N43°30'00"W 30.93 FEET; THENCE S89°17'09"E 419.32 FEET TO THE POINT OF BEGINNING.

ALSO A EASEMENT AND RIGHT OF WAY BEGINNING AT THE NORTHEAST CORNER OF SOUTHWEST QUARTER OF THE SOUTHWEST QUARTER OF SECTION 28 TOWNSHIP 14 SOUTH RANGE 10 EAST OF THE SALT LAKE BASE AND MERIDIAN, THENCE SOUTH 2 RODS; THENCE WEST 80 RODS; THENCE NORTH 2 RODS THENCE EAST 80 RODS TO THE POINT OF BEGINNING.

OWNERS DEDICATION

KNOW ALL MEN BY THESE PRESENTS THAT THE UNDERSIGNED OWNERS () OF THE ABOVE DESCRIBED TRACT OF LAND, HAVING CAUSED THE SAME TO BE SUBDIVIDED IN TO LOTS AND TO HERE AFTER KNOWN AS THE

JENSEN SUBDIVISION HIGHWAY 10 SOUTH

DO HERE BY DEDICATE FOR PERPETUAL USE OF THE PUBLIC ALL PARCELS OF LAND SHOWN ON THIS PLAT AS INTENDED FOR PUBLIC USE.

2nd DAY OF August A.D. 2012

Laura J. Jensen
Phyllis Jensen

John W. Tomadakis
Donna J. Tomadakis

ACKNOWLEDGEMENT

STATE OF UTAH S.S.
County of Carbon City of Price
On the 2nd day of August A.D. 2012, personally appeared before me, the undersigned Notary Public, in and for said County of Carbon, City of Price, in said State of Utah, the signer(s) of the above Owner's Dedication, in number, who duly acknowledged to me that they signed it freely and voluntarily and for the uses and purposes therein mentioned.

MY COMMISSION EXPIRES Jan 13, 2014

RESIDING IN Carbon County, UT

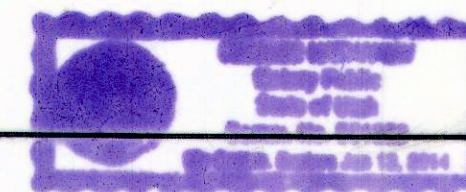

HIGHWAY No. 10

JENSEN SUBDIVISION HIGHWAY 10 SOUTH

VICINITY MAP

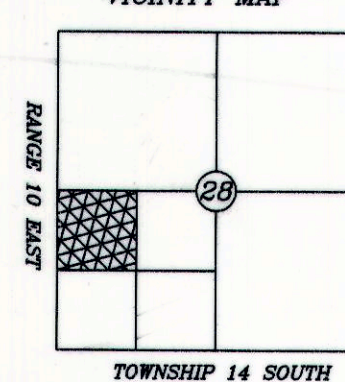

SCALE 1"=60'

WEST 1/4 CORNER
OF SECTION 28
T-14-S R-10-E
S.L.B&M.
(POSITION SET BY REFERENCE MONUMENTS)

S00°33'47"E 933.81 FEET
HIGH WAY RIGHT OF WAY LINE

N89°17'09"E 22.00'
P.O.B.

S00°33'47"E 150.00'

S00°33'47"E 2678.85' (BASIS OF BEARING)

LOT 1
2.60 ACRES

N89°17'09"E 255.62'

S00°33'47"E 255.62'

N89°17'09"E 156.30'

N43°30'00"W 30.93'

9.06'

N66°00'00"W 70.91'

60.81'

N66°00'00"W 390.00'

N66°00'00"W 319.09'

N01°46'58"W 253.02'

N01°46'58"W 280.04'

N88°05'45"E 44.78'

S01°46'58"E 88.37'

N89°17'09"E 1048.69'

N89°17'09"E 892.39'

N00°31'38"W 420.60'

S53°39'21"W 197.32'

S75°30'00"W 360.00'

N66°00'00"W 390.00'

N43°30'00"W 30.93'

S89°17'09"E 419.32'

N89°17'09"E 255.62'

S00°33'47"E 255.62'

N89°17'09"E 156.30'

N89°17'09"E 1048.69'

N89°17'09"E 892.39'

N00°31'38"W 420.60'

S53°39'21"W 197.32'

S75°30'00"W 360.00'

N66°00'00"W 390.00'

N43°30'00"W 30.93'

S89°17'09"E 419.32'

N89°17'09"E 255.62'

S00°33'47"E 255.62'

N89°17'09"E 156.30'

N89°17'09"E 1048.69'

N89°17'09"E 892.39'

N00°31'38"W 420.60'

S53°39'21"W 197.32'

S75°30'00"W 360.00'

N66°00'00"W 390.00'

N43°30'00"W 30.93'

S89°17'09"E 419.32'

N89°17'09"E 255.62'

S00°33'47"E 255.62'

N89°17'09"E 156.30'

N89°17'09"E 1048.69'

N89°17'09"E 892.39'

N00°31'38"W 420.60'

S53°39'21"W 197.32'

S75°30'00"W 360.00'

N66°00'00"W 390.00'

N43°30'00"W 30.93'

S89°17'09"E 419.32'

N89°17'09"E 255.62'

S00°33'47"E 255.62'

N89°17'09"E 156.30'

N89°17'09"E 1048.69'

N89°17'09"E 892.39'

N00°31'38"W 420.60'

S53°39'21"W 197.32'

S75°30'00"W 360.00'

N66°00'00"W 390.00'

N43°30'00"W 30.93'

S89°17'09"E 419.32'

N89°17'09"E 255.62'

S00°33'47"E 255.62'

N89°17'09"E 156.30'

N89°17'09"E 1048.69'

N89°17'09"E 892.39'

N00°31'38"W 420.60'

S53°39'21"W 197.32'

S75°30'00"W 360.00'

N66°00'00"W 390.00'

N43°30'00"W 30.93'

S89°17'09"E 419.32'

N89°17'09"E 255.62'

S00°33'47"E 255.62'

N89°17'09"E 156.30'

N89°17'09"E 1048.69'

N89°17'09"E 892.39'

N00°31'38"W 420.60'

S53°39'21"W 197.32'

S75°30'00"W 360.00'

N66°00'00"W 390.00'

N43°30'00"W 30.93'

S89°17'09"E 419.32'

N89°17'09"E 255.62'

S00°33'47"E 255.62'

N89°17'09"E 156.30'

N89°17'09"E 1048.69'

N89°17'09"E 892.39'

N00°31'38"W 420.60'

S53°39'21"W 197.32'

S75°30'00"W 360.00'

N66°00'00"W 390.00'

N43°30'00"W 30.93'

S89°17'09"E 419.32'

N89°17'09"E 255.62'

S00°33'47"E 255.62'

N89°17'09"E 156.30'

N89°17'09"E 1048.69'

N89°17'09"E 892.39'

N00°31'38"W 420.60'

S53°39'21"W 197.32'

S75°30'00"W 360.00'

N66°00'00"W 390.00'

N43°30'00"W 30.93'

S89°17'09"E 419.32'

N89°17'09"E 255.62'

S00°33'47"E 255.62'

N89°17'09"E 156.30'

N89°17'09"E 1048.69'

N89°17'09"E 892.39'

N00°31'38"W 420.60'

S53°39'21"W 197.32'

S75°30'00"W 360.00'

N66°00'00"W 390.00'

N43°30'00"W 30.93'

S89°17'09"E 419.32'

N89°17'09"E 255.62'

S00°33'47"E 255.62'

N89°17'09"E 156.30'

N89°17'09"E 1048.69'

N89°17'09"E 892.39'

N00°31'38"W 420.60'

S53°39'21"W 197.32'

S75°30'00"W 360.00'

N66°00'00"W 390.00'

N43°30'00"W 30.93'

S89°17'09"E 419.32'

N89°17'09"E 255.62'

S00°33'47"E 255.62'

N89°17'09"E 156.30'

N89°17'09"E 1048.69'

N89°17'09"E 892.39'

N00°31'38"W 420.60'

S53°39'21"W 197.32'

S75°30'00"W 360.00'

N66°00'00"W 390.00'

N43°30'00"W 30.93'

S89°17'09"E 419.32'

N89°17'09"E 255.62'

S00°33'47"E 255.62'

N89°17'09"E 156.30'

N89°17'09"E 1048.69'

N89°17'09"E 892.39'

N00°31'38"W 420.60'

S53°39'21"W 197.32'

S75°30'00"W 360.00'

N66°00'00"W 390.00'

N43°30'00"W 30.93'

S89°17'09"E 419.32'

N89°17'09"E 255.62'

S00°33'47"E 255.62'

N89°17'09"E 156.30'

N89°17'09"E 1048.69'

N89°17'09"E 892.39'

N00°31'38"W 420.60'

S53°39'21"W 197.32'

S75°30'00"W 360.00'

N66°00'00"W 390.00'

N43°30'00"W 30.93'

S89°17'09"E 419.32'

N89°17'09"E 255.62'

S00°33'47"E 255.62'

N89°17'09"E 156.30'

N89°17'09"E 1048.69'

N89°17'09"E 892.39'

N00°31'38"W 420.60'

S53°39'21"W 197.32'

S75°30'00"W 360.00'

N66°00'00"W 390.00'

N43°30'00"W 30.93'

S89°17'09"E 419.32'

N89°17'09"E 255.62'

S00°33'47"E 255.62'

N89°17'09"E 156.30'

N89°17'09"E 1048.69'

N89°17'09"E 892.39'

N00°31'38"W 420.60'

S53°39'21"W 197.32'

S75°30'00"W 360.00'

N66°00'00"W 390.00'

N43°30'00"W 30.93'

S89°17'09"E 419.32'

N89°17'09"E 255.62'

S00°33'47"E 255.62'

N89°17'09"E 156.30'

N89°17'09"E 1048.69'

N89°17'09"E 892.39'

N00°31'38"W 420.60'

S53°39'21"W 197.32'

S75°30'00"W 360.00'

N66°00'00"W 390.00'

N43°30'00"W 30.93'

S89°17'09"E 419.32'

N89°17'09"E 255.62'