

KEY TO PROPERTY OWNERS IN THE ANNEXATION AREA

- STATE OF UTAH 2-647-9S
- COLLEGE OF EASTERN UTAH 2-899
- STATE OF UTAH 2-647-10S
- PRICE CITY 2-899-3
- HENRY CHAPMAN SMITH 1-1664
- PRICE CITY 2-647-2
- PRICE CITY 2-898
- USA 2-647-9F
- SHERIFF'S POSSE 2-902
- USA 2-647-10F
- PRICE CITY 2-902-A
- STATE OF UTAH 2-647-10S
- ALASKA WESTERN INC. 1-1663
- BOYD J. & DEANN MORTENSEN 1-1660-4
- JAMES R. & LINDA C. BOUD, TR. 2-908
- E.L. PIERCE 2-908-1
- E.L. PIERCE 2-908-3
- E.L. PIERCE 2-908-5
- PRICE CITY 1-2309
- CORP. OF EPISCOPAL CHURCH IN UTAH 1-2308
- E.L. PIERCE 1-2308
- TWO G GROUP & DOUBLE O LLC 1-2646
- JAMES R. & LINDA C. BOUD, TR. 2-1520
- E.L. PIERCE, ETAL 2-1520-1
- CONVEYOR SERVICES CORP. 2-1520-5
- CONVEYOR SERVICES CORP. 2-1520-3
- JACK A. LEAUTAUD 2-1520-2
- JTJJ ENTERPRISES, LTD 2-1520-2
- LOUIS P. TONC ETAL 1-2308-1
- CASTLE HEIGHTS SUBDIVISION PLAT III AMENDED
- E.L. PIERCE 1-2310
- JERRY CARLSON PROP., CCL 1-2525
- RICK L. KROMPEL 1-2517
- DAVID CUNNINGHAM ETAL 2-1525-3
- BOYD & MARY L. THAYNE TR. 2-1525-2
- ALBERT & LEONA F. LEAUTAUD 2-1525
- LINDA C. VARNER 2-905
- SHARON HACKNEY 2-904-3
- PAT C. & JOYCE L. WORLEY 2-904-2
- TED & ALVERTA BIANCO 2-904-1
- ALBERT & LEONA F. LEAUTAUD, TR. 2-904
- CLIFFORD SHAWN BAKER ETAL 2-904-4
- CASTLE HEIGHTS IV SUBDIVISION

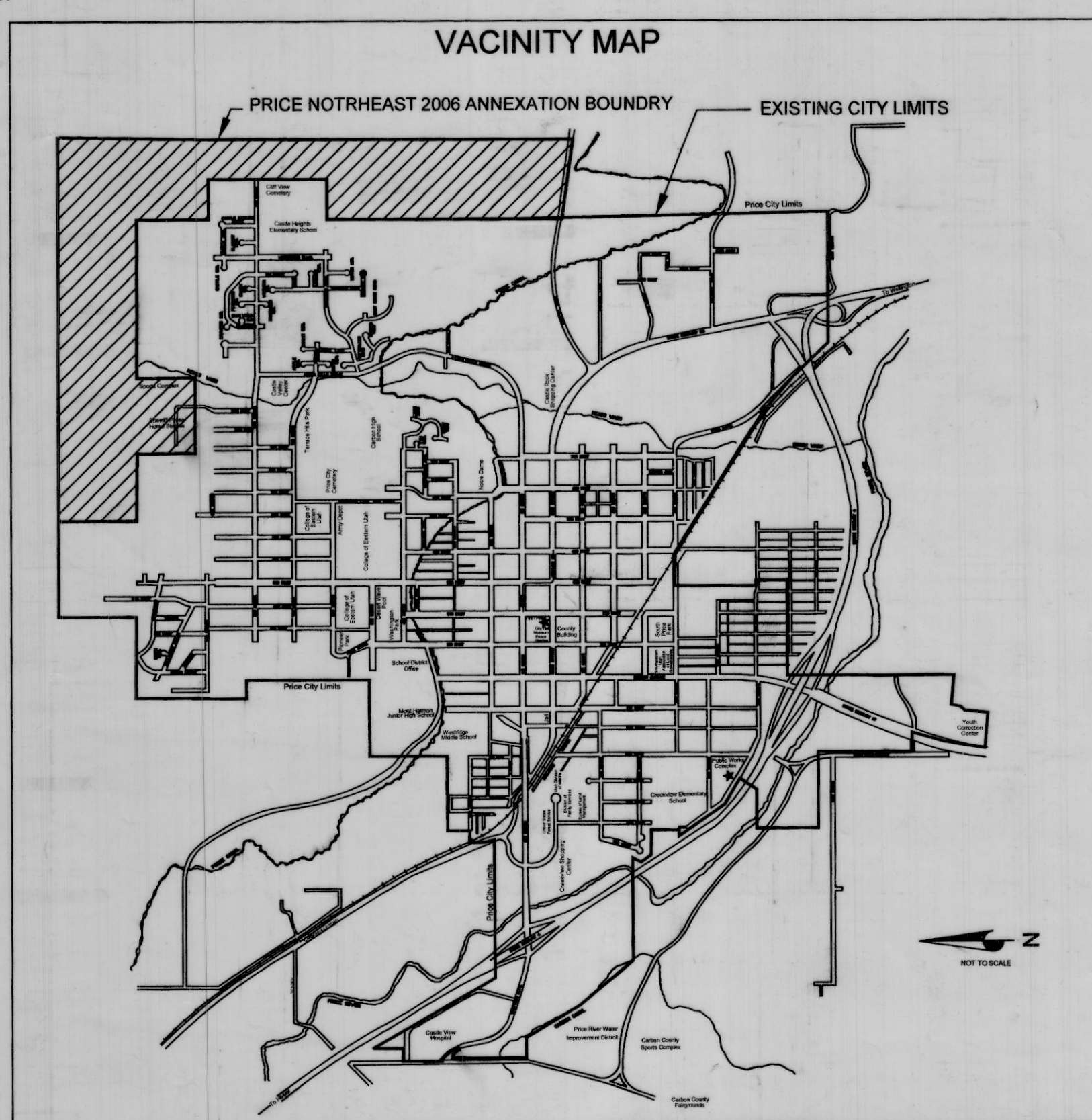
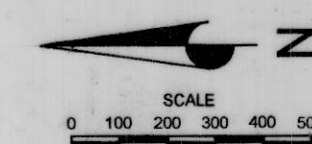

PETITION FOR ANNEXATION

THE OWNERS (NAMED BELOW) OF THE PROPERTY DESCRIBED IN THIS ANNEXATION PLAT HEREBY PETITION THE CITY COUNCIL OF PRICE, UTAH TO ANNEX SAID PROPERTY

SIGNED THIS 8TH DAY OF SEPTEMBER 20 06, A.D.

PROPERTY DESCRIPTION

BEGINNING AT THE NORTHEAST CORNER OF SECTION 15, TOWNSHIP 14 SOUTH, RANGE 10 EAST, SALT LAKE BASE & MERIDIAN AND RUNNING THENCE: S00°37'04"E ALONG THE SECTION LINE, 2657.37' TO THE EAST QUARTER CORNER OF SECTION 15, THENCE S00°39'13"E ALONG THE SECTION LINE 2651.72' TO THE SOUTHEAST CORNER OF SAID SECTION 15, THENCE S00°38'52"E ALONG THE EAST SECTION LINE OF SECTION 22 807.09' TO THE SOUTH RIGHT-OF-WAY LINE OF AIRPORT ROAD, THENCE ALONG THE SOUTH RIGHT-OF-WAY LINE OF SAID AIRPORT ROAD N82°58'00"W 1343.95' TO THE EXISTING PRICE CITY LIMITS, THENCE N00°42'44"W ALONG SAID CITY LIMITS 632.71' TO THE SOUTH LINE OF SECTION 15, THENCE N00°39'57"W ALONG SAID CITY LIMITS 2645.41' TO THE CENTER LINE OF SAID SECTION 15, THENCE N00°39'23"W ALONG SAID CITY LIMITS 663.07', THENCE N89°15'07"E ALONG SAID CITY LIMITS 666.81', THENCE N00°38'14"W ALONG SAID CITY LIMITS 1991.00' TO THE NORTH SECTION LINE OF SECTION 15, THENCE S89°04'41"W ALONG SAID SECTION LINE, WHICH IS ALSO THE EXISTING CITY LIMITS 667.49', THENCE N00°07'22"E ALONG SAID CITY LIMITS 1342.80', THENCE S89°17'26"W ALONG SAID CITY LIMITS 1331.91', THENCE S89°16'43"W ALONG SAID CITY LIMITS 1318.41', THENCE S00°11'25"W ALONG SAID CITY LIMITS 1019.74', THENCE S89°20'37"W 1325.69' TO THE WEST LINE OF SECTION 10, THENCE N01°16'46"W ALONG SAID SECTION LINE 1018.16', THENCE S89°50'46"W 1312.74', THENCE N00°34'33"W 1351.70' TO THE CENTER LINE OF SECTION 9, THENCE ALONG THE CENTER LINE OF SAID SECTION 9 N89°33'45"E 1296.09' TO THE WEST LINE OF SECTION 10, THENCE ALONG THE CENTER LINE OF SAID SECTION 10 N89°30'16"E 5363.99' TO THE EAST QUARTER CORNER OF SAID SECTION 10, THENCE S00°00'17"E ALONG THE EAST LINE OF SAID SECTION 10 2675.61' TO THE POINT OF BEGINNING, CONTAINING 432.3 ACRES MORE OR LESS.

- NOTES:
- A FIELD SURVEY OF THE ANNEXATION AREA WAS NOT PERFORMED. THE PROPERTY DESCRIPTION WAS DETERMINED FROM THE RECORDS OF THE CARBON COUNTY SURVEYOR'S OFFICE, USING THE GENERALLY ACCEPTED UTAH STATE PLANE COORDINATES OF THE STANDARD SECTION CORNERS IN THE AREA.
 - PROPERTY PARCEL INFORMATION FROM THE CARBON COUNTY RECORDERS OFFICE WAS USED TO DETERMINE THE PRIVATE AND PUBLIC PROPERTY PARCELS SHOWN ON THIS ANNEXATION PLAT.
 - ALL BEARINGS AND DISTANCES ARE FROM CARBON COUNTY RECORDS.
 - THE BASIS OF BEARING IS UTAH STATE PLANE GRID NORTH.
 - NO PROPERTY CORNERS WERE SET FOR THIS ACTION.

SURVEYOR'S CERTIFICATION:

I, BENJAMIN A. GRIMES, A REGISTERED PROFESSIONAL SURVEYOR, HOLDING CERTIFICATE 167246, STATE OF UTAH, DO HEREBY CERTIFY THAT THE INFORMATION ON THIS PLAT IS A TRUE AND ACCURATE REPRESENTATION OF THE PROPERTIES SHOWN ACCORDING TO THE OFFICES OF THE CARBON COUNTY SURVEYOR, AND CARBON COUNTY RECORDER AS OF AUGUST 29, 2005.

BENJAMIN A. GRIMES P.L.S. # 167246 DATE 11/14/06

CITY ENGINEER'S CERTIFICATE:

I HEREBY CERTIFY THAT THIS OFFICE HAS EXAMINED THIS PLAT AND IT IS CORRECT IN ACCORDANCE WITH INFORMATION ON FILE IN THIS OFFICE.

GARY D. SONNTAG, REGISTERED PROFESSIONAL ENGINEER, STATE OF UTAH, LICENSE NO. 165493, DATE 11/17/06

APPROVAL AS TO FORM:

WILL SAMPSON, CITY ATTORNEY, DATE 11/17/06

PRICE CITY PLANNING COMMISSION APPROVAL:

CHAIRPERSON: [Signature] DATE 11/13/06
 ATTEST: APPROVAL BY COMMISSION SECRETARY: [Signature] DATE 11/13/06

ACCEPTANCE BY LEGISLATIVE BODY:

THIS IS TO CERTIFY THAT PRICE CITY HAS RECEIVED A PETITION SIGNED BY A MAJORITY OF THE OWNERS OF THE TRACT SHOWN HEREON REQUESTING THAT SAID TRACT BE ANNEXED TO THE CITY OF PRICE, UTAH, AND THAT A COPY OF THE ORDINANCE HAS BEEN PREPARED FOR A FILING HERE WITH ALL IN ACCORDANCE WITH UTAH CODE ANNOTATED (MAY 8, 1979) 10-2-401 THRU 423, AND THAT WE HAVE EXAMINED AND DO HEREBY APPROVE AND ACCEPT THE ANNEXATION OF THE TRACT AS SHOWN AS A PART OF SAID CITY, AND THAT SAID TRACT OF LAND IS TO BE KNOWN HEREAFTER AS THE PRICE NORTH 2006 ANNEXATION.

PRICE CITY, A MUNICIPAL CORPORATION, CITY MAYOR: [Signature] DATE 13 November 2006
 ATTEST: APPROVAL BY CITY COUNCIL SECRETARY: [Signature] DATE 11/13/06