

CURVE TABLE					
CURVE	LENGTH	RADIUS	DELTA	CHORD BEARING	CHORD LENGTH
C1	51.83	50.00	59°23'34"	N60°51'08"W	49.54
C2	122.36	60.00	116°50'43"	S89°34'48"E	102.23
C3	78.53	60.00	74°59'26"	N05°29'52"W	73.04
C4	49.80	60.00	47°33'20"	N66°46'15"W	48.38
C5	250.70	60.00	239°23'51"	N29°09'08"E	104.24

Ent 118697 & P5 Pg 133
Date: 02-AUG-2006 11:59AM
Feet: None
Filed By: KR
SHARON MURDOCK, Recorder
CARBON COUNTY CORPORATION
For: PRICE CITY

Ent 118697 & P5 Pg 228
Date: 02-AUG-2006 11:59AM
Feet: None
Filed By: KR
SHARON MURDOCK, Recorder
CARBON COUNTY CORPORATION
For: PRICE CITY

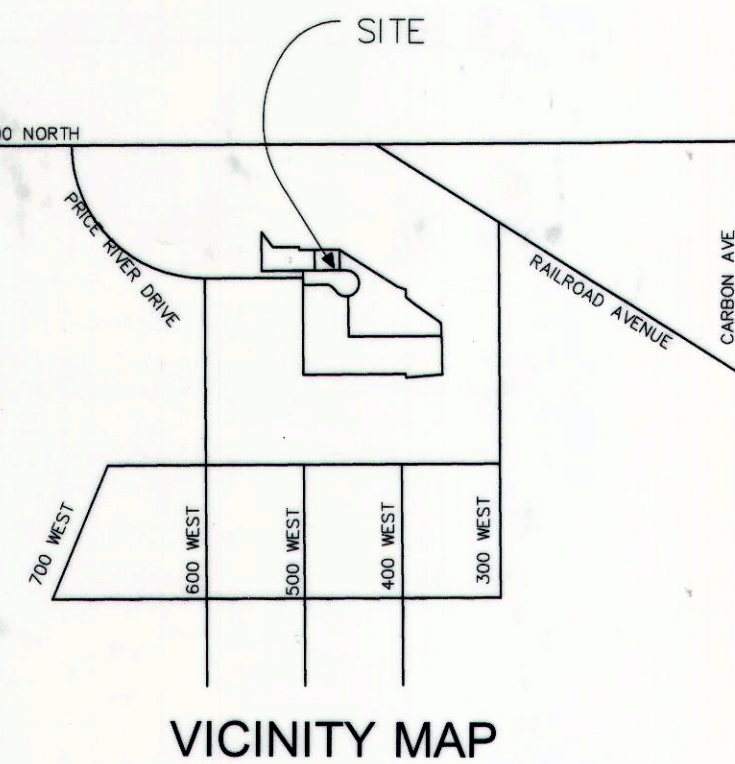
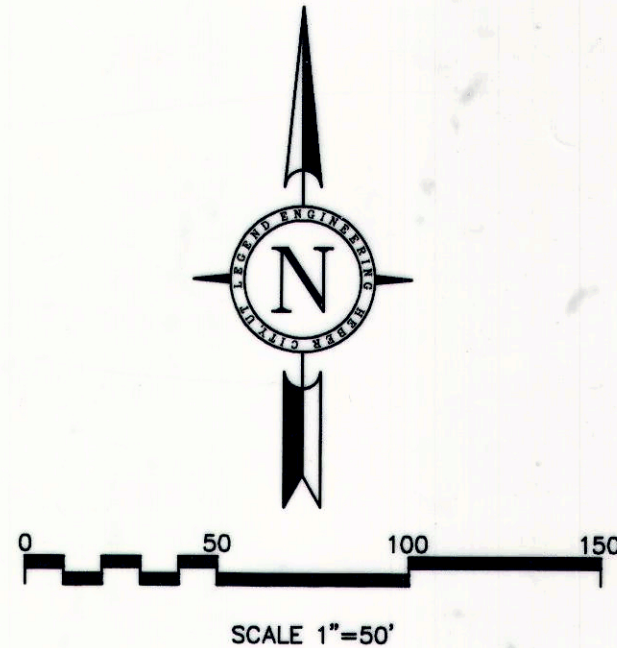

SURVEYOR'S CERTIFICATE

SURVEYOR'S CERTIFICATE
I, GARY G. CHRISTENSEN, DO HERBY CERTIFY THAT I AM A PROFESSIONAL LAND SURVEYOR, HOLDING CERTIFICATE NUMBER 515261Z, AS PRESCRIBED BY THE LAWS OF THE STATE OF UTAH. I FURTHER CERTIFY THAT BY THE AUTHORITY OF THE OWNER(S) A SURVEY WAS MADE UNDER MY DIRECTION OF THE LAND SHOWN HEREON AND DESCRIBED BELOW, AND THE SAME HAS BEEN CORRECTLY SURVEYED ON THE GROUND AS SHOWN ON THIS PLAT, AND THAT THIS PLAT IS TRUE AND CORRECT.

BOUNDARY DESCRIPTION

A parcel of land situate in the Northeast Corner of Section 20, Township 14 South, Range 10 East, Salt Lake Base and Meridian, located in Price City, Carbon County, Utah, being more particularly described as follows:

Commencing at the Northeast Corner of Section 20, Township 14 East, Range 10 South, Salt Lake Base and Meridian, and running South 0°32' 55" East 947.13 feet along the Section Line; thence West 169.55 feet to the Point of beginning; thence South 84°51'05" West 169.81 feet; thence North 02°07'35" West 15.43 feet; thence South 89°27'05" West 826.31 feet; thence North 00°32'55" West 399.19 feet to a point of curvature; thence 23.56 feet along the arc of a 15 foot radius curve to the right (through a central angle of 90°00'44", chord bears North 44°27'05" East a distance of 21.21 feet) to a point of tangency; thence North 89°27'05" East 452.45 feet to a point of curvature; thence 51.83 feet along the arc of a 50 foot radius curve to the right (through a central angle of 59°23'48", chord bears South 60°51'01" East a distance of 49.54 feet); thence 250.70 feet along the arc of a 60 foot radius curve to the left (through a central angle of 239°23'51", chord bears North 29°09'07" East a distance of 104.24 feet); thence South 89°27'05" West 400.96 feet; thence North 00°32'55" West 177.08 feet; thence South 37°29'55" East 86.15 feet; thence South 89°27'05" East 122.00 feet; thence South 00°32'55" East 13.00 feet; thence North 89°27'05" East 187.38 feet; thence South 02°13'56" West 3.63 feet; thence North 89°00'58" East 2.25 feet; thence South 58°12'06" East 252.92 feet; thence South 57°54'34" East 60.47 feet; thence South 70°56'48" East 32.52 feet; thence South 70°36'55" East 9.23 feet; thence South 00°32'55" East 34.00 feet; thence South 52°03'55" East 47.52 feet; thence South 54°30'08" East 154.21 feet; thence South 03°16'15" East 105.71 feet; thence South 00°16'37" East 61.14 feet; South 01°37'09" East 57.33 feet; thence South 00°32'55" East 13.26 feet to the Point of beginning.

Contains 5 Lots and 10.10 acres.

OWNER'S DEDICATION

KNOW ALL MEN BY THESE PRESENTS THAT WE, ALL THE UNDERSIGNED OWNERS OF ALL THE PROPERTY DESCRIBED IN THE SURVEYOR'S CERTIFICATE HEREON AND SHOWN ON THE MAP, AND SUBJECT TO ANY CONDITIONS AND RESTRICTIONS STATED HEREON, HAVE CAUSED THE SAME TO BE SUBDIVIDED INTO LOTS, BLOCKS, STREETS AND EASEMENTS. AND DO HEREBY DEDICATE THE STREETS AND OTHER PUBLIC PARCELS OF LAND AS INDICATED FOR THE PERPETUAL USE OF THE PUBLIC.

IN WITNESS WHEREOF WE HAVE HEREUNTO SET OUR HANDS THIS 7th DAY OF July, A.D. 2006

Mark Markley
Mark Markley, Manager
Mark

ACKNOWLEDGEMENT (L.L.C.)

STATE OF UTAH
COUNTY OF CARBON
ON THE 7th DAY OF July, A.D. 2006, PERSONALLY APPEARED BEFORE ME, Mark Markley AND WHO BEING BY ME DULY SWORN DID SAY, EACH FOR HIMSELF, THAT HE, THE SAID Mark Markley IS THE PRESIDENT AND HE THE SAID Mark Markley IS THE SECRETARY OF Price II LLC CORPORATION, AND THAT THE WITHIN AND FOREGOING INSTRUMENT WAS SIGNED IN BEHALF OF SAID CORPORATION BY AUTHORITY OF A RESOLUTION OF ITS BOARD OF DIRECTORS AND SAID Mark Markley, AND EACH DULY ACKNOWLEDGED TO ME THAT SAID CORPORATION EXECUTED THE SAME AND THAT THE SEAL AFFIXED IS THE SEAL OF SAID CORPORATION.

MY COMMISSION EXPIRES 2-1-10

ACCEPTANCE BY LEGISLATIVE BODY

THE CITY COUNCIL OF PRICE CITY, STATE OF UTAH, COUNTY OF CARBON, HEREBY APPROVES THIS SUBDIVISION SUBJECT TO CONDITIONS AND RESTRICTIONS STATED HEREON, AND HEREBY ACCEPTS THE DEDICATION OF ALL STREETS, EASEMENTS AND OTHER PARCELS OF LAND INTENDED FOR PUBLIC AREAS AS INDICATED FOR PERPETUAL USE OF THE PUBLIC THIS 24th DAY OF July, A.D. 2006

MAYOR: *[Signature]*
ATTEST: *[Signature]* PRICE CITY RECORDER

PLANNING COMMISSION APPROVAL

APPROVED THIS 24th DAY OF April, A.D. 2006, BY THE PLANNING COMMISSION OF PRICE CITY.

Laurie Tynes
DIRECTOR-SECRETARY

Gary P. Brown
CHAIRMAN, PLANNING COMMISSION

Sharon Murdock
CLERK-RECORDER

CITY ATTORNEY'S CERTIFICATE

THIS PLAT HAS BEEN APPROVED BY THE PRICE CITY ATTORNEY ON THIS 20th DAY OF July, A.D. 2006

Mark Markley
(PRICE CITY ATTORNEY)

CITY ENGINEER'S CERTIFICATE

Gary G. Christensen
AS PRICE CITY ENGINEER HAVE INSPECTED THE FOREGOING PLAT AND BOUNDARY DESCRIPTION AND FIND THEM TO BE CORRECT IN ACCORDANCE WITH INFORMATION ON FILE AND DO HEREBY GIVE APPROVAL OF SAID PLAT ON THIS 20th DAY OF July, A.D. 2006
Gary G. Christensen
PRICE CITY ENGINEER

SURVEYOR'S SEAL

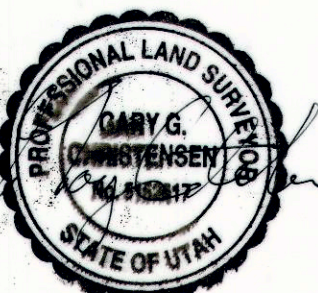

NOTARY PUBLIC SEAL



CITY ENGINEER SEAL

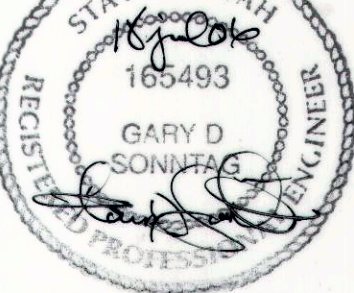

CLERK-RECORDER SEAL



PRICE RIVER DRIVE
BUSINESS PARK II SUBDIVISION
PRICE CITY, UTAH

LEGEND ENGINEERING, LLC

P.O. BOX 475
PRICE CITY, UT 84032
PHONE: 801-641-4047
TOLL FREE FAX: 1-866-310-0972
www.legendengineering.com



SHEET:

1

PROJECT ID:

FILE NAME: SCALE: 1"=50'