

SCOFIELD MOUNTAIN ESTATES - PHASE V
LOCATED IN SECTION 5, TOWNSHIP 12 SOUTH, RANGE 7 EAST, SLB&M
CARBON COUNTY, UTAH 2022

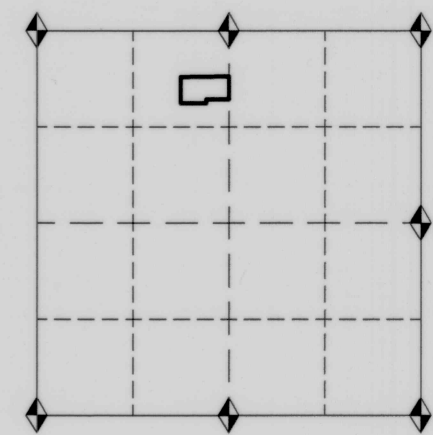

Ent 865944 Bl 1056 Pl 206
Date: 21-AUG-2023 3:27:08PM
Fees: \$36.00 Charge Filed By: RO
KARLA MEDLEY, Recorder
CARBON COUNTY CORPORATION
For: NETRO NATIONAL TITLE



VICINITY MAP:
SECTION 5, TOWNSHIP 12 SOUTH, RANGE 7 EAST
NOT TO SCALE

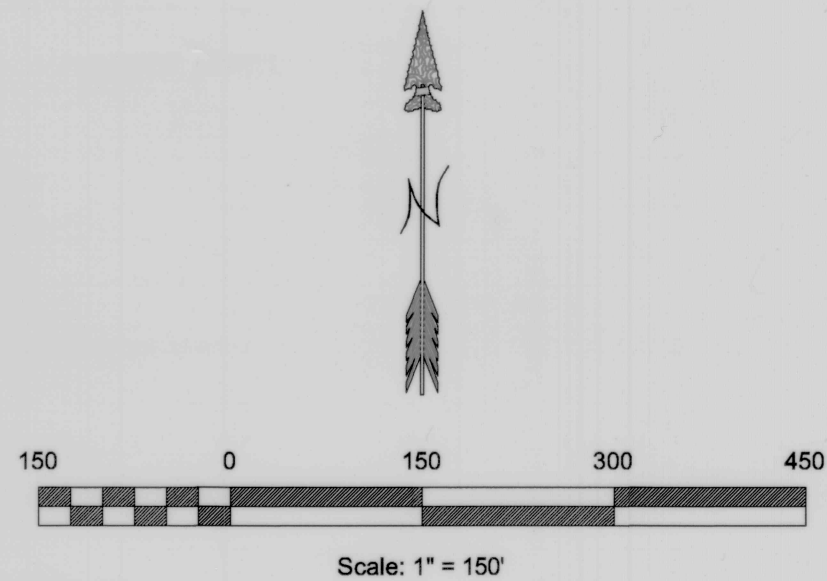

LEGEND	
	SUBDIVISION BOUNDARY
	SUBDIVISION LOT LINES
	7.00 FOOT P.U.E.
	ADJOINING BOUNDARIES
	EXISTING ROAD
	SECTION LINE
	QUARTER SECTION LINE
	40 ACRE LINE
	FOUND SECTION MONUMENT
	FOUND SURVEY MONUMENT
	DENOTES A #5 REBAR WITH A 1 1/2" RED PLASTIC CAP SET ON TOP MARKED WRA J&T ENGINEERING 11179291

ADDITIONAL NOTE:
A 7.00 FOOT PUBLIC UTILITY EASEMENT IS RESERVED ON ALL SIDES OF EACH LOT SHOWN.

SURVEYOR'S CERTIFICATE

I, WACEY R. ALLRED, A PROFESSIONAL LAND SURVEYOR, HOLDING UTAH CERTIFICATE NO. 11179291, DO HEREBY CERTIFY THAT THE PLAT SHOWN HEREON HAS BEEN PREPARED FROM A FIELD SURVEY MADE UNDER MY DIRECTION AND CORRECTLY SHOWS THE DIMENSIONS AND MONUMENTS OF THE PROPERTY DESCRIBED TO THE BEST OF MY KNOWLEDGE AND BELIEF. I FURTHER CERTIFY THAT BY AUTHORITY OF THE OWNERS(S), I HAVE MADE A SURVEY OF THE TRACT OF LAND SHOWN ON THIS PLAT AND DESCRIBED BELOW, AND SUBDIVIDED TRACT OF LAND INTO LOT(S), HEREAFTER TO KNOW AS THE:

SCOFIELD MOUNTAIN ESTATES SUBDIVISION - PHASE V

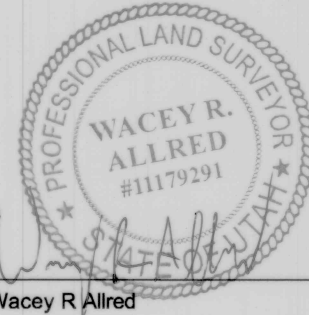

5-11-23
Date

SCOFIELD MOUNTAIN ESTATES SUBDIVISION - PHASE V DESCRIPTION:

BEGINNING AT A POINT WHICH IS LOCATED N 89°48'55" W, 671.59 FEET ALONG THE SECTION LINE TO THE NORTHEAST CORNER OF THE SCOFIELD MOUNTAIN ESTATES SUBDIVISION, PHASE IV, OFFICIAL RECORDS OF THE CARBON COUNTY RECORDER AND S 00°15'00" E, 636.61 FEET ALONG THE EAST LINE OF SAID SUBDIVISION FROM THE NORTH QUARTER CORNER OF SECTION 5, TOWNSHIP 12 SOUTH, RANGE 7 EAST, SLB&M; THENCE S 00°15'00" E, 367.41 FEET ALONG SAID EAST LINE; THENCE N 89°53'44" E, 353.12 FEET; THENCE N 00°15'00" W, 50.10 FEET; THENCE N 89°53'44" E, 315.49 FEET TO THE NORTH-SOUTH QUARTER SECTION LINE; THENCE N 00°04'17" W, 317.31 FEET ALONG SAID QUARTER SECTION LINE; THENCE S 89°53'44" W, 669.60 FEET TO THE POINT OF BEGINNING. CONTAINING 5.28 ACRES, MORE OR LESS.

SURVEYORS NARRATIVE:

SURVEYED AT THE REQUEST OF MATT BROWN TO SUBDIVIDE AND DESCRIBE THE PROPERTY SHOWN HEREON FOR THE PURPOSE OF CREATING THE SCOFIELD MOUNTAIN ESTATES SUBDIVISION - PHASE V.

THE SURVEY WAS BASED INSTRUCTIONS IN THE FIELD BY MR. BROWN, THE OFFICIAL PLATS OF THE SCOFIELD MOUNTAIN ESTATES SUBDIVISION PHASE III AND PHASE IV, FOUND SURVEY MONUMENTS AND FOUND SECTION MONUMENTS. THE SECTION WAS SUBDIVIDED IN ACCORDANCE WITH THE 2009 BLM MANUAL OF SURVEYING INSTRUCTIONS.

BASIS OF BEARING

N 89°48'55" W, BETWEEN THE NORTH QUARTER CORNER AND THE NORTHWEST CORNER OF SECTION 5, TOWNSHIP 12 SOUTH, RANGE 7 EAST, SLB&M.

ACKNOWLEDGEMENT AND DEDICATION

KNOW ALL MEN BY THESE PRESENTS THAT I THE UNDERSIGNED OWNER OF ALL OF THE PROPERTY DESCRIBED HEREON AND SHOWN ON THIS PLAT, HAVE CAUSED THE SAME TO BE SUBDIVIDED INTO LOTS, STREETS, AND EASEMENTS HEREAFTER KNOWN AS THE SCOFIELD MOUNTAIN ESTATES SUBDIVISION - PHASE V, AND DO HEREBY DEDICATE THE STREETS AND OTHER AREAS AS DEDICATED HEREIN FOR THE PERPETUAL USE OF THE PUBLIC.

IN WITNESS WHEREOF I HAVE HEREUNTO SET MY HAND THIS 16th DAY OF August, 2023.

SCOFIELD ESTATES, LC

By: Matt Brown Title: Manager Date: 8/18/2023

ACKNOWLEDGMENT

STATE OF UTAH)
COUNTY OF Davis) ss

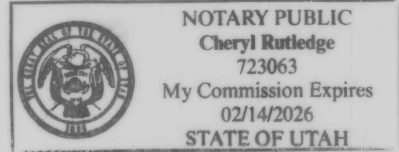

ON THE 18th DAY OF August, 2023 PERSONALLY APPEARED BEFORE ME, MATT BROWN, WHO STATES THAT HE IS THE Manager OF SCOFIELD ESTATES, LC, AND WITH AUTHORITY OF SAID SCOFIELD ESTATES, LC, THE SIGNER OF THE FOREGOING APPROVAL, WHO DULY ACKNOWLEDGED TO ME THAT HE EXECUTED THE SAME.

Cheryl Rutledge
Notary Public

NAME OF SUBDIVISION:
SCOFIELD MOUNTAIN ESTATES
SUBDIVISION - PHASE V

PREPARED FOR:
Matt Brown

PREPARED BY:
Johansen & Tuttle ENGINEERING INC.

P.O. Box 487, Castle Dale, UT 84513
(435) 381-2523 Fax (435) 381-2522, e-mail jt@etv.net

DRAWN BY: WRA DATE: 3/12/2023 SCALE: 1" = 150' FILE: T:\PPS\2022\Matt Brown

CARBON COUNTY ATTORNEY'S OFFICE	
Christian Bryner	8/1/2023
CHRISTIAN BRYNER	DATE
DIRECTOR OF PLANNING	
Todd Thorne	8-1-23
TODD THORNE	DATE
CONTRACT CARBON COUNTY SURVEYOR	
M. Cody Ware	5/17/23
M. CODY WARE	DATE
CARBON COUNTY RECORDER	
STATE OF UTAH, COUNTY OF CARBON, RECORDED AND FILED AT THE REQUEST OF:	
DATE	TIME
BOOK	PAGE
KARLA MEDLEY	