



Ent 825563 Bk 827 Pg 411
Date: 21-AUG-2014 4:15:45PM
Fee: None
Filed By: VB
VIKKI BARNETT, Recorder
CARBON COUNTY CORPORATION
For: CARBON COUNTY

NARRATIVE

AT THE REQUEST OF THE SIX-COUNTY INFRASTRUCTURE COALITION, JONES & DEMILLE ENGINEERING, INC. HAS PREPARED A RECORD OF SURVEY DELINEATING AND DESCRIBING THE OVERALL BOUNDARY OF THE FOLLOWING SIX COUNTIES IN THE STATE OF UTAH: CARBON, DAGGETT, DUCHESNE, EMERY, SAN JUAN, AND UTAH.

THE BOUNDARY DESCRIBED ON THIS MAP HAS BEEN CREATED FROM THE COUNTY DESCRIPTIONS AS MAINTAINED BY THE LIEUTENANT GOVERNOR.

THIS MAP PROVIDES A GENERAL GRAPHIC LOCATION OF THE BOUNDARY WITHOUT BEING TIED TO THE GROUND USING THE PUBLIC LAND SURVEY SYSTEM.

IF MORE ACCURATE INFORMATION IS NEEDED, A GROUND SURVEY IS REQUIRED.

DESCRIPTION

THE GEOGRAPHIC BOUNDARIES OF THE SIX-COUNTY INFRASTRUCTURE COALITION ARE DESCRIBED AS FOLLOWS:

[illegible]

ACCEPTANCE BY COUNTY COMMISSION

THE CARBON COUNTY COMMISSION HAS REVIEWED THE ABOVE SIX-COUNTY INFRASTRUCTURE COALITION PLAN AND HEREBY ACCEPTS IT WITH ALL THE COMMITMENTS AND OBLIGATIONS PERTAINING HERETO.

COMMISSIONER

8-21-14
DATE

SURVEYOR'S CERTIFICATE

I, CLAY TOLBERT, PROFESSIONAL LAND SURVEYOR, AS PRESCRIBED BY THE LAWS OF THE STATE OF UTAH AND HOLDING LICENSE NO. 354381 DO HEREBY CERTIFY THAT THIS MAP WAS PREPARED BY ME OR UNDER MY DIRECTION TOGETHER WITH THE BEST INFORMATION AVAILABLE. THAT DUE CARE WAS EXERCISED IN PREPARING THIS MAP: THAT THIS MAP IS A GEOGRAPHIC REPRESENTATION OF THE SIX-COUNTY INFRASTRUCTURE COALITION BOUNDARY TO THE BEST OF MY KNOWLEDGE AND CONVICTION.

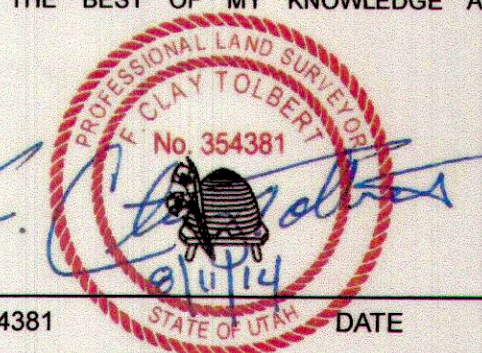

F. CLAY TOLBERT, L.S. #354381

DATE _____

COUNTY SURVEYOR'S CERTIFICATE

I, BENJAMIN A. GRIMES, PROFESSIONAL LAND SURVEYOR AND CARBON COUNTY SURVEYOR, AS PRESCRIBED BY THE LAWS OF THE STATE OF UTAH AND HOLDING LICENSE NO. 167246 DO HEREBY CERTIFY THAT I HAVE EXAMINED THIS PLAT AND FIND IT TO BE CORRECT AND IN ACCORDANCE WITH THE INFORMATION ON FILE IN THIS OFFICE.

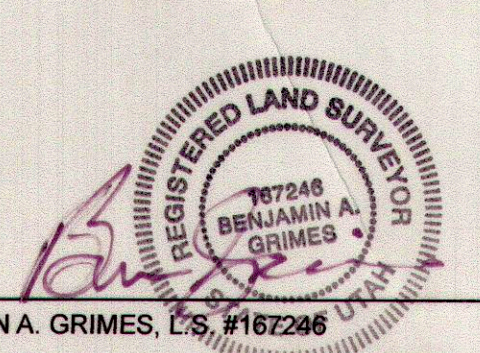



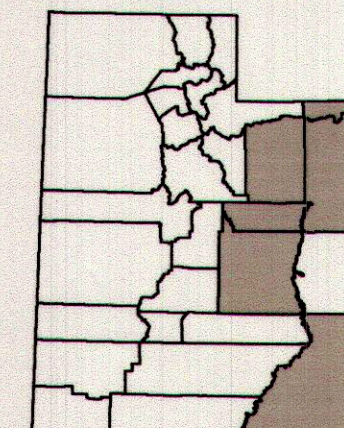

BENJAMINA GRIMES I S #167246

DATE 8/4/14

Location Map



Legend

-  Six-County Infrastructure Coalition Boundary
-  State Boundaries
-  County Boundaries
-  Interstates
-  US Highways

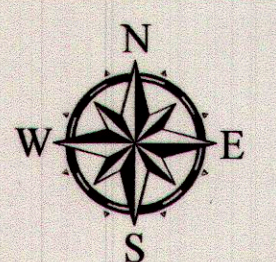

SCALE: 1" = 12.5 miles

0 10 20 Miles

COUNTY RECORDER

VIKKI BARNETT
CARBON COUNTY RECORDER

Project Number: 1407-302

Map Name: H:\ID\Proj\1407-302\Design\GIS\Map\Six County Boundary Map_R1W.mxd

Drawn by: ALP 07-14

Checked by: F. Clay Tolbert, PLS

Last Edit: 08/11/2014

Plotted: 08/11/2014

Sources: Esri, USGS, NOAA