

**Descriptions**

**Parcel No. 1**

Beginning at a point South 00°21'51" East along the Section line 160.99 feet from the Northwest Corner of the Southwest Quarter of Section 3 Township 12 South Range 7 East of the Salt Lake Base and Meridian. Running thence South 00°21'51" East along the said Section line 98.33 feet; Thence East 65.51 feet to the Westerly Right of way line of Highway No.96; thence North 02°27'13" West along said fence 138.17 feet; thence South 56°35'47" West 72.14 feet to the point of beginning.

**Parcel No. 2**

Beginning at a point South 00°21'51" East along the Section Line 298.22 feet and West 28.0 feet from the Northeast corner of the Southeast Quarter of Section 4 Township 12 South Range 7 East of the Salt Lake Base and Meridian. Running thence South 57°13' West 34.68 feet; thence South 32°47' East 51.55 feet; thence North 01°08'50" East 102.14 feet to the point of beginning.

**Parcel No. 3**

Beginning at a point South 00°21'51" East along the Section line 361.20 feet and East 68.48 feet from the Northwest Corner of the Southwest Quarter of Section 3 Township 12 South Range 7 East of the Salt Lake Base and Meridian. Running thence South 00°21'51" East 34.03 feet; thence South 32°47' East 3.37 feet; thence South 57°13' West 11.13 feet; thence South 01°08'50" West 21.17 feet; thence East 100.87 feet to a point on said right of way fence; thence along said fence line North 02°01'31" West 30.02 feet to the point of beginning.

**Parcel No. 4**

Beginning at a point South 00°21'51" East along the Section line 162.25 feet from the Northeast corner of the Southeast Quarter of Section 4, Township 12, Range 7 East of the Salt Lake Base & Meridian. Running thence South 00°21'51" East 34.03 feet, thence South 57°35' West 75.81 feet; thence North 31.77 feet; thence North 56°35'47" East 77.89 feet to the point of beginning.

**Parcel No. 5**

Beginning at the Northeast corner of the Southeast Quarter of Section 4, Township 12 South Range 7 East of the Salt Lake Base and Meridian; thence North 89°34'33" East 54.04 feet to the Westerly right-of-way line of Highway #96; thence along said line South 02°10' East 123.44 feet; thence South 56°35'47" West 146.98 feet; thence North 203.40 feet; thence North 89°34'33" East 64.0 feet to the point of beginning.

**Surveyors Certification**

I Art F. Barker do hereby depose and say that I am a Registered Land Surveyor as prescribed by the laws of the state of Utah and that I hold license number 162812, I further certify that I have made the survey as shown herewith.

Art F. Barker  date: R.P. 10/26/95

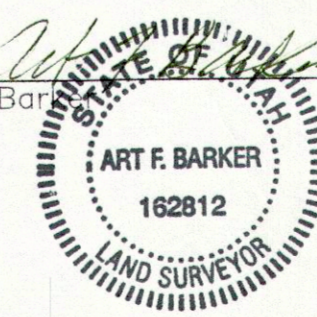

PROJECT:	PROPERTY SURVEY		95010
PREPARED BY:	Bob and Peggy Hennings Donald M. and Galda B. Winward 13680 South 1700 West Riverton, Utah 84065 (801) 254-3386	ART F. BARKER & ASSOCIATES SURVEYING & ENGINEERING 36 WEST MAIN STREET WELLINGTON, UTAH 84542 (801) 637-2394 (95010)	