

**DESCRIPTION**

A PARCEL OF LAND LOCATED IN THE WEST ONE-HALF OF SECTION 36, TOWNSHIP 14 SOUTH, RANGE 10 EAST, SALT LAKE BASE AND MERIDIAN, AND THE NORTHWEST ONE-QUARTER OF SECTION 1, TOWNSHIP 15 SOUTH, RANGE 10 EAST, SALT LAKE BASE AND MERIDIAN, WITH THE UTAH STATE PLANE COORDINATE SYSTEM USED AS THE BASIS OF BEARING BEING FURTHER DESCRIBED AS FOLLOWS, TO-WIT:

BEGINNING AT THE WEST QUARTER CORNER OF SECTION 36, TOWNSHIP 14 SOUTH, RANGE 10 EAST, SALT LAKE BASE AND MERIDIAN; AND RUNNING THENCE N 1° 13' 10" W, 335.26 FEET ALONG THE WEST LINE OF THE NORTHWEST QUARTER OF SAID SECTION 36; THENCE N 48° 26' 13" E, 126.93 FEET TO THE WEST CORNER OF LOT 45 OF AMENDED HILLCREST ESTATES PLAT 'B'; THENCE ALONG THE SOUTHWEST BOUNDARY OF THE AMENDED HILLCREST ESTATES PLAT 'B' ACCORDING TO THE FOLLOWING PARTICULAR COURSES AND DISTANCES TO-WIT: THENCE S 18° 43' 26" E, (RECORDED S 17° 30' 16" E), 278.91 FEET; THENCE S 25° 14' 05" E, (RECORDED S 24° 00' 55" E), 1252.34 FEET; THENCE S 69° 56' 05" E, (RECORDED S 68° 42' 55" E), 783.57 FEET; TO THE SOUTHEAST CORNER OF LOT 36 OF AMENDED HILLCREST ESTATES PLAT 'B'; THENCE S 74° 43' 21" E, 46.17 FEET; THENCE N 89° 29' 16" E, 865.00 FEET; THENCE N 67° 14' 50" E, 230.00 FEET; THENCE S 14° 56' 03" W, 366.70 FEET; THENCE S 0° 50' 13" E, 196.61 FEET; THENCE N 89° 14' 01" E, 231.56 FEET TO THE EAST LINE OF THE SOUTHWEST QUARTER OF SAID SECTION 36; THENCE S 0° 50' 13" E, 923.30 FEET TO THE SOUTH QUARTER CORNER OF SAID SECTION 36; THENCE S 0° 26' 22" E, 331.46 FEET ALONG THE EAST LINE OF LOT 3 OF SECTION 1, TOWNSHIP 15 SOUTH, RANGE 10 EAST; THENCE S 89° 18' 01" W, 1331.97 FEET TO THE WEST LINE OF SAID LOT 3; THENCE N 0° 35' 40" W, 329.90 FEET TO THE SOUTHWEST CORNER OF THE SOUTHWEST QUARTER OF THE SOUTHWEST QUARTER OF SECTION 36, TOWNSHIP 14 SOUTH, RANGE 10 EAST, SALT LAKE BASE AND MERIDIAN; THENCE N 1° 01' 44" W, 1328.71 FEET TO THE NORTHWEST CORNER OF THE SOUTHWEST QUARTER OF SAID SECTION 36; THENCE S 89° 29' 02" W, 1337.34 FEET TO THE SOUTHWEST CORNER OF THE NORTHWEST QUARTER OF THE SOUTHWEST QUARTER OF SAID SECTION 36; THENCE N 1° 13' 10" W, 1334.58 FEET ALONG THE WEST LINE OF THE NORTHWEST QUARTER OF THE SOUTHWEST QUARTER OF SAID SECTION 36 TO THE POINT OF BEGINNING.

CONTAINS 71.762 ACRES, MORE OR LESS.

**NOTE:** TO DETERMINE ACCURATE ACREAGE A SURVEY SHOULD BE MADE.

**LEGEND**

- INDICATES 5/8" x 24" REBAR SET
- INDICATES ANGLE POINTS

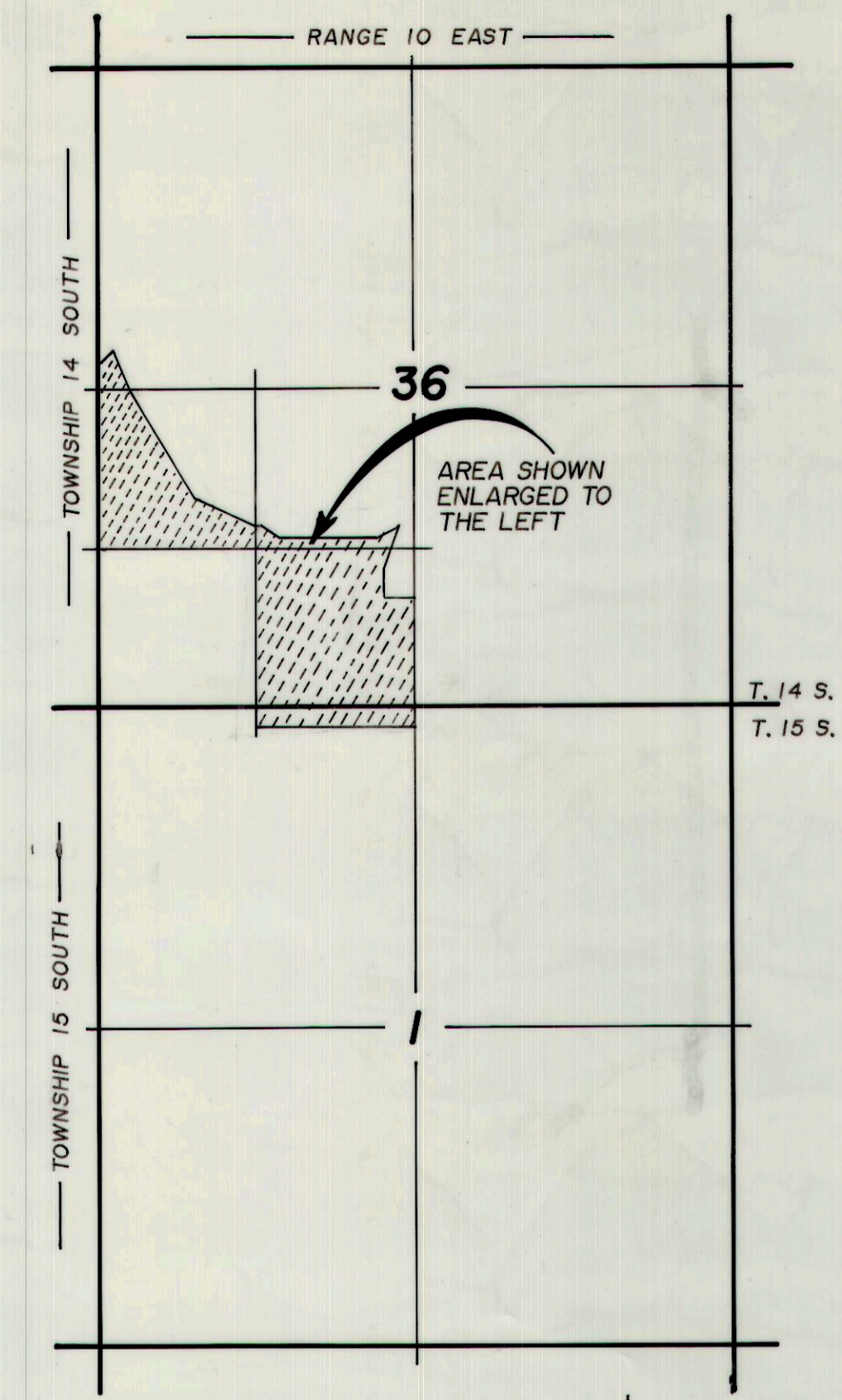

**VICINITY MAP**  
SCALE: 1" = 1320'

**PURPOSE**

THE PURPOSE OF THIS PLAT WAS TO WRITE A LEGAL DESCRIPTION AND TO DETERMINE ACREAGE.

**ENGINEER'S CERTIFICATE**

I, EVAN E. HANSEN DO HEREBY CERTIFY THAT I AM A REGISTERED LAND SURVEYOR AND PROFESSIONAL ENGINEER HOLDING CERTIFICATES NO. 3115 AND NO. 3354 AS PRESCRIBED UNDER THE LAWS OF THE STATE OF UTAH. I FURTHER CERTIFY THAT I HAVE MADE A SURVEY OF THE TRACT OF GROUND SHOWN AND THAT IT IS TRUE AND CORRECT TO THE BEST OF MY KNOWLEDGE.

EVAN E. HANSEN \_\_\_\_\_ DATE \_\_\_\_\_

— TOWNSHIP 14 & 15 SOUTH, RANGE 10 EAST —

**Empire Engineering & Land Surveying**  
1665 E. SAGEWOOD RD. PRICE, UTAH 84501 PHONE (801) 637-7498

**KIAHTIPES PROPERTY - SOUTH HILLCREST SUBDIVISION**

Drawn By: TH	Approved By: EEH	Drawing No.
Date: AUG. 1989	Scale: 1" = 200'	EEPS-103D

ANIXTER REAL ESTATES, INC.