

EVANGELINE ROBERTSON, et al.
38.132 ACRES, LESS EASEMENTS

UTAH DEPARTMENT OF TRANSPORTATION

DENVER & RIO GRANDE WESTERN RAILROAD

NOTE:
LOCATION OF THE HIGHWAY AND
THE RAILROAD ARE APPROXIMATE.
(HIGHWAY DEED WAS NOT FOUND)

DESCRIPTION

A PARCEL OF LAND LOCATED WITHIN EAST CARBON CITY CORPORATE BOUNDARY, COUNTY OF CARBON, STATE OF UTAH, WHICH IS IN THE NORTHEAST QUARTER OF THE NORTHWEST QUARTER OF SECTION 11, TOWNSHIP 15 SOUTH, RANGE 13 EAST, SALT LAKE BASE AND MERIDIAN, BEING FURTHER DESCRIBED AS FOLLOWS WITH A BEARING OF NORTH 89°28'55" EAST BETWEEN THE NORTHWEST CORNER AND THE NORTH QUARTER CORNER OF SAID SECTION 11 USED AS THE BASIS OF BEARING, WHICH IS THE UTAH STATE PLANE COORDINATE SYSTEM.

BEGINNING AT THE NORTHWEST CORNER OF THE NORTHEAST QUARTER OF THE NORTHWEST QUARTER OF SECTION 11, TOWNSHIP 15 SOUTH, RANGE 13 EAST, SALT LAKE BASE AND MERIDIAN; SAID POINT OF BEGINNING IS ALSO LOCATED NORTH 89°28'55" EAST, 1328.35 FEET FROM THE NORTHWEST CORNER OF SAID SECTION 11, WHICH IS A BRASS CAP SET BY THE BUREAU OF LAND MANAGEMENT; AND RUNNING THENCE SOUTH 89°28'55" EAST, 892.75 FEET ALONG THE SECTION LINE; THENCE SOUTH 0°03'38" EAST, 100.00 FEET; THENCE SOUTH 89°28'55" EAST 435.60 FEET TO THE EAST LINE OF THE NORTHEAST QUARTER OF THE NORTHWEST QUARTER OF SAID SECTION 11; THENCE SOUTH 0°03'38" EAST, 165.67 FEET ALONG THE CENTER OF SECTION LINE; THENCE SOUTH 77°31'22" WEST, 128.77 FEET; THENCE SOUTH 12°04'05" EAST, 126.31 FEET; THENCE NORTH 77°31'22" EAST, 101.86 FEET TO THE CENTER OF SECTION LINE; THENCE SOUTH 0°03'38" EAST 911.51 FEET ALONG THE CENTER OF SECTION LINE TO THE SOUTHEAST CORNER OF THE NORTHEAST QUARTER OF THE NORTHWEST QUARTER OF SAID SECTION 11; THENCE NORTH 89°13'30" WEST, 1330.73 FEET ALONG THE FORTY ACRE LINE TO THE SOUTHWEST CORNER OF THE NORTHEAST QUARTER OF THE NORTHWEST QUARTER OF SAID SECTION 11; THENCE NORTH 0°02'29" EAST, 493.26 FEET ALONG THE FORTY ACRE LINE; THENCE NORTH 59°06'21" EAST, 128.06 FEET; THENCE NORTH 23°05'55" WEST, 147.58 FEET; THENCE SOUTH 59°06'05" WEST, 60.45 FEET TO THE FORTY ACRE LINE; THENCE NORTH 0°02'29" EAST, 636.81 FEET TO THE POINT OF BEGINNING.

CONTAINS 38.132 ACRES, MORE OR LESS, LESS APPROXIMATELY 2.83 ACRES FOR AN EASEMENT TO THE DENVER AND RIO GRANDE WESTERN RAILROAD COMPANY; ALSO LESS APPROXIMATELY 1.00 ACRES FOR AN EASEMENT TO THE UTAH DEPARTMENT OF TRANSPORTATIONS.

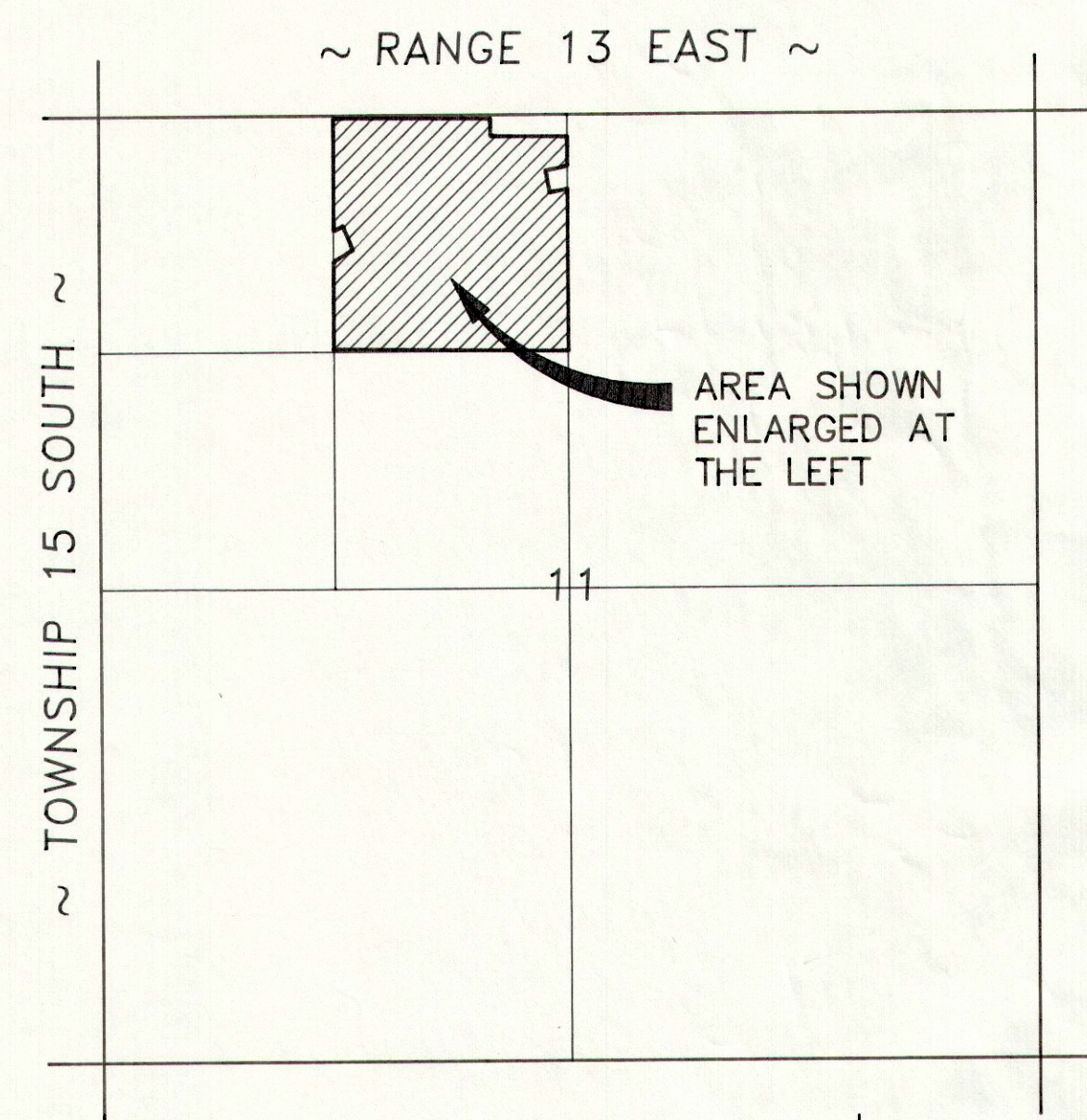

VICINITY MAP

SCALE: 1" = 1000'

LEGEND

- INDICATES 5/8" x 24" REBAR SET W/ CAP
- ⊕ SECTION CORNER
- - - APPROXIMATE RIGHT-OF-WAY LINES
- PROPERTY LINE
- - - SECTION LINE

PURPOSE

THE PURPOSE OF THIS SURVEY WAS TO STAKE THE DESCRIPTION SHOWN BELOW ON THE GROUND.

ENGINEER'S CERTIFICATE

I, EVAN E. HANSEN, DO HEREBY CERTIFY THAT I AM A REGISTERED LAND SURVEYOR AND PROFESSIONAL ENGINEER HOLDING CERTIFICATE NO. 145656 AS PRESCRIBED UNDER THE LAWS OF THE STATE OF UTAH. I FURTHER CERTIFY THAT I HAVE MADE A SURVEY OF THE TRACT OF GROUND SHOWN AND THAT IT IS TRUE AND CORRECT TO THE BEST OF MY KNOWLEDGE.

Evan E. Hansen *MAY 27, 1996*
EVAN E. HANSEN DATE

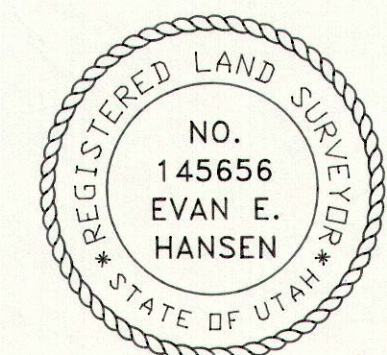

NE1/4 NW1/4 SECTION 11, T 15 S, R 13 E, S.L.B. & M.		
Empire Engineering & Land Surveying		
1665 E. Sagewood Rd. Price, Utah 84501 Phone (801) 637-7498		
Property Survey For:		
JAMES & EVANGELINE ROBERTSON		
Drawn By:	Approved By:	Drawing No.
THK	EEH	EEPS-279 D
Date:	Scale:	
05/27/96	1" = 100'	