

C:/FASTMAP/  
 PRETTYMAN/  
 NEW-SUB/  
 PLOT-MIK

10/04/96 11.42a

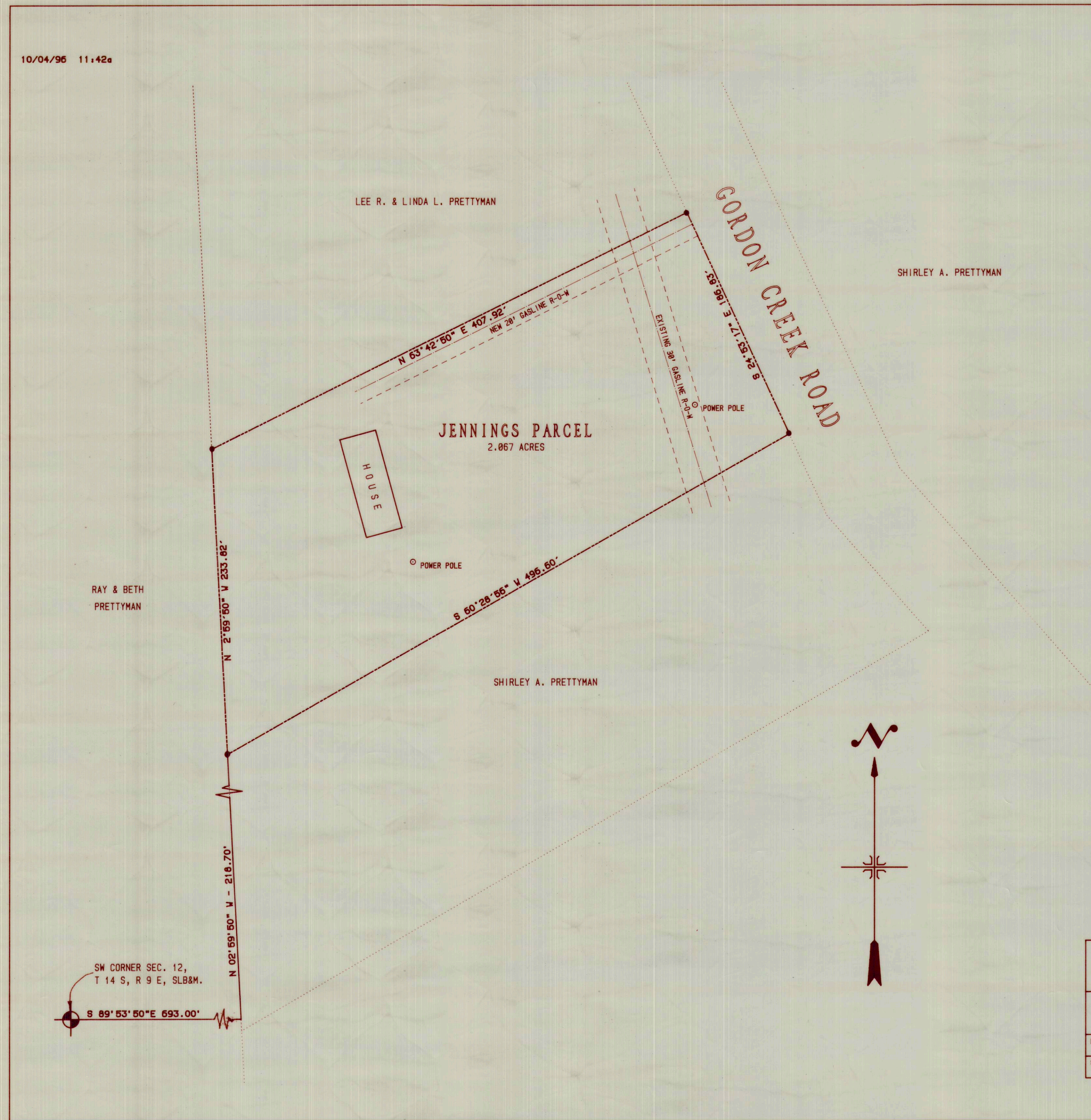

**GASLINE EASEMENT DESCRIPTION:**

AN EASEMENT FOR INSTALLATION, OPERATION, AND MAINTENANCE OF A GAS LINE LYING 10 FEET ON EACH OF THE FOLLOWING DESCRIBED CENTERLINE: BEGINNING AT A POINT WHICH LIES SOUTH 89°53'50" EAST 1029.23 FEET ALONG THE SECTION LINE AND NORTH 835.24 FEET FROM THE SOUTHWEST CORNER OF SECTION 12, TOWNSHIP 14 SOUTH, RANGE 9 EAST, SALT LAKE BASE AND MERIDIAN; AND RUNNING THENCE SOUTH 63°42'50" WEST 289.45 FEET.

**JENNINGS PARCEL DESCRIPTION:**

BEGINNING AT A POINT WHICH LIES SOUTH 89°53'50" EAST 693.00 FEET ALONG THE SECTION LINE AND NORTH 82°59'50" WEST 438.148 FEET FROM THE SOUTHWEST CORNER OF SECTION 12, TOWNSHIP 14 SOUTH, RANGE 9 EAST, SALT LAKE BASE AND MERIDIAN; THENCE NORTH 82°59'50" WEST 233.817 FEET; THENCE NORTH 63°42'50" EAST 487.923 FEET TO THE COUNTY ROAD RIGHT OF WAY; THENCE SOUTH 24°53'17" EAST 186.827 FT ALONG SAID RIGHT OF WAY; THENCE SOUTH 60°28'56" WEST 496.598 FEET TO THE POINT OF BEGINNING. (AREA = 2.867 ACRES)

**BASIS OF BEARING:**

BASIS OF BEARING IS S 89°53'50" E BETWEEN THE SOUTHWEST CORNER AND THE SOUTH 1/4 CORNER OF SECTION 12, TOWNSHIP 14 SOUTH, RANGE 9 EAST, SALT LAKE BASE AND MERIDIAN.

**SURVEYORS CERTIFICATE:**

I, BARRY L. PRETTYMAN, A LICENSED SURVEYOR HOLDING CERTIFICATE No 166406, DO HEREBY CERTIFY THAT THE PLAT SHOWN HEREON WAS PREPARED FROM A FIELD SURVEY MADE UNDER MY DIRECTION AND CORRECTLY SHOWS THE DIMENSIONS AND MONUMENTS OF THE ABOVE DESCRIBED PARCEL OF LAND TO THE BEST OF MY KNOWLEDGE AND BELIEF.

*Barry L. Prettyman*  
 BARRY L. PRETTYMAN DATE Oct. 4, 1996

• = 5/8" REBAR WITH YELLOW CAP MARKED RLS 166406.

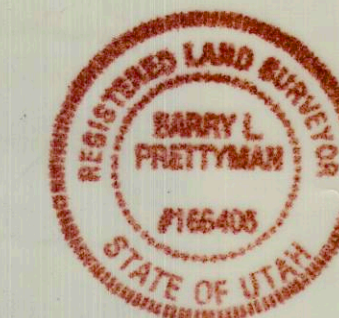

**MIKE AND JENIFER JENNINGS**  
 PROPERTY SURVEY PLAT

**COLE SURVEYING AND ENGINEERING**  
 401 WEST SR 198, SALEM, UTAH 84653 PHONE (801) 423-1040

DRAWN BY: B.L. PRETTYMAN	APPROVED BY: B.L. PRETTYMAN	DRAWING No.: 1 of 1
SCALE: 1" = 50'	DATE: OCT. 4, 1996	