

DESCRIPTION OF LANDS CROSSING UTAH STATE LANDS

AN EASEMENT FOR GAS LINE PURPOSES, 30.00 FEET WIDE LYING 15.00 FEET ON EACH SIDE OF THE FOLLOWING DESCRIBED CENTER LINE.

BEGINNING AT A POINT WHICH IS LOCATED NORTH 00°43'42" WEST, 415.91 FEET ALONG THE SECTION LINE FROM THE EAST QUARTER CORNER OF SECTION 9, TOWNSHIP 15 SOUTH, RANGE 10 EAST, SALT LAKE BASE AND MERIDIAN; AND RUNNING THENCE NORTH 79°24'52" WEST, 1596.40 FEET; THENCE NORTH 54°30'01" WEST, 559.47 FEET; THENCE NORTH 79°37'31" WEST, 2825.21 FEET; THENCE NORTH 82°04'50" WEST, 579.47 FEET CROSSING STATE HIGHWAY 10; THENCE SOUTH 35°56'54" WEST, 115.90 FEET; THENCE SOUTH 41°16'40" WEST, 135.63 FEET; THENCE SOUTH 45°07'53" WEST, 105.96 FEET; THENCE SOUTH 53°31'27" WEST, 108.71 FEET; THENCE SOUTH 68°29'54" WEST, 121.55 FEET; THENCE SOUTH 81°36'49" WEST, 135.28 FEET; THENCE SOUTH 89°35'35" WEST, 175.39 FEET; THENCE NORTH 89°09'20" WEST, 258.19 FEET; THENCE NORTH 87°37'55" WEST, 219.02 FEET; THENCE NORTH 85°18'19" WEST, 90.50 FEET; THENCE NORTH 87°50'54" WEST, 209.58 FEET; THENCE SOUTH 88°15'12" WEST, 103.45 FEET; THENCE SOUTH 85°18'27" WEST, 111.91 FEET; THENCE SOUTH 88°48'36" WEST, 99.78 FEET; THENCE NORTH 82°32'48" WEST, 81.52 FEET; THENCE NORTH 71°03'38" WEST, 110.38 FEET; THENCE NORTH 68°25'10" WEST, 126.29 FEET; THENCE NORTH 77°54'31" WEST, 85.92 FEET; THENCE NORTH 86°58'04" WEST, 103.02 FEET; THENCE SOUTH 86°06'32" WEST, 120.26 FEET; THENCE SOUTH 83°26'57" WEST, 164.41 FEET; THENCE SOUTH 80°59'28" WEST, 141.38 FEET; THENCE SOUTH 79°04'52" WEST, 389.57 FEET; THENCE SOUTH 84°03'21" WEST, 113.16 FEET; THENCE NORTH 89°58'23" WEST, 67.99 FEET; THENCE NORTH 82°51'14" WEST, 109.09 FEET; THENCE NORTH 78°31'12" WEST, 478.20 FEET; THENCE NORTH 89°28'50" WEST, 238.98 FEET; THENCE SOUTH 84°42'13" WEST, 313.43 FEET; THENCE SOUTH 88°59'37" WEST, 75.46 FEET; THENCE NORTH 84°20'42" WEST, 55.64 FEET TO ITS TERMINUS WHERE AN EXISTING GAS PIPELINE LIES BURIED.

WEST, 164.41 FEET; THENCE SOUTH 80°59'28" WEST, 141.38 FEET; THENCE SOUTH 79°04'52" WEST, 389.57 FEET; THENCE SOUTH 84°03'21" WEST, 113.16 FEET; THENCE NORTH 89°58'23" WEST, 67.99 FEET; THENCE NORTH 82°51'14" WEST, 109.09 FEET; THENCE NORTH 78°31'12" WEST, 478.20 FEET; THENCE NORTH 89°28'50" WEST, 238.98 FEET; THENCE SOUTH 84°42'13" WEST, 313.43 FEET; THENCE SOUTH 88°59'37" WEST, 75.46 FEET; THENCE NORTH 84°20'42" WEST, 55.64 FEET TO ITS TERMINUS WHERE AN EXISTING GAS PIPELINE LIES BURIED.

ALSO

BEGINNING AT A POINT WHICH IS LOCATED NORTH 00°43'42" WEST, 415.91 FEET ALONG THE SECTION LINE FROM THE WEST QUARTER CORNER OF SECTION 10, TOWNSHIP 15 SOUTH, RANGE 10 EAST, SALT LAKE BASE AND MERIDIAN; AND RUNNING THENCE SOUTH 79°24'52" EAST, 1288.53 FEET; THENCE SOUTH 76°56'13" EAST, 722.87 FEET TO THE CENTER OF SECTION LINE.

THE BOUNDARY LINES OF SAID EASEMENT SHALL BE PROLONGED OR SHORTENED TO MEET AT ANGLE-POINT INTERSECTIONS AND TO BEGIN AND END ON, AND CONFORM TO THE GRANTOR'S PROPERTY LINES.

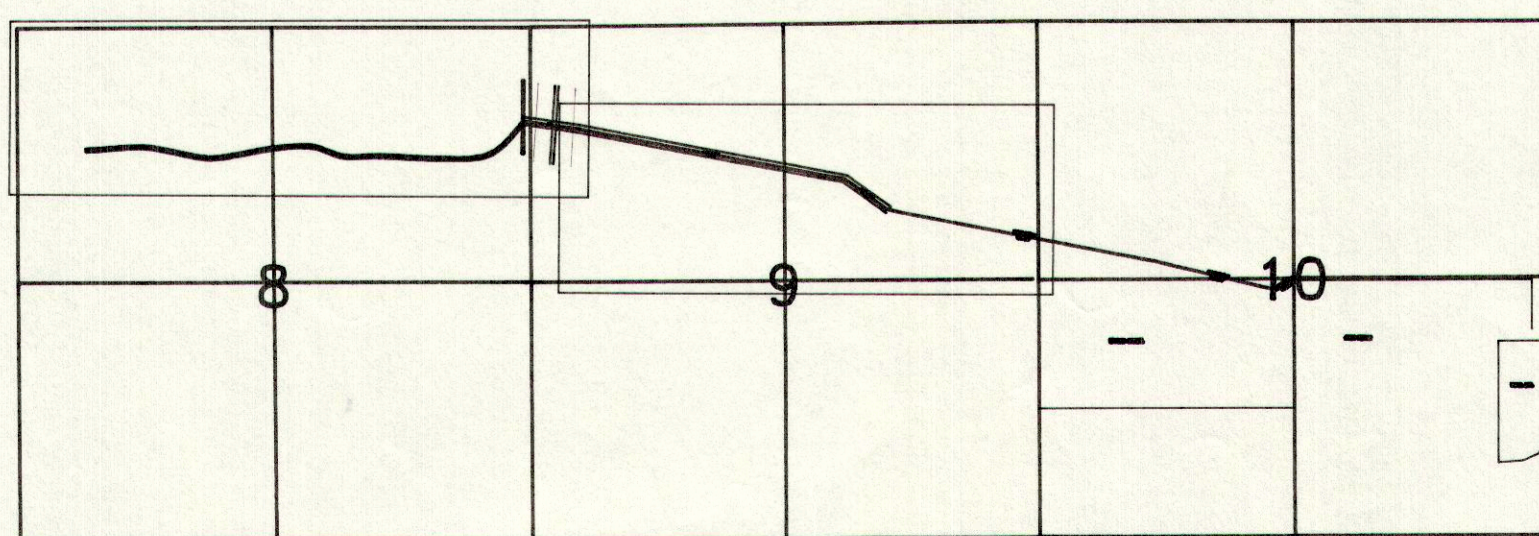

VICINITY MAP

LEGEND

- INDICATES 5/8" x 24" REBAR SET W/ CAP
- ⊕ SECTION CORNER
- x FENCE LINE
- PROPERTY LINE
- SECTION LINE

PURPOSE

ENGINEER'S CERTIFICATE

I, EVAN E. HANSEN, DO HEREBY CERTIFY THAT I AM A REGISTERED LAND SURVEYOR AND PROFESSIONAL ENGINEER HOLDING CERTIFICATE NO. 145656 AS PRESCRIBED UNDER THE LAWS OF THE STATE OF UTAH. I FURTHER CERTIFY THAT I HAVE MADE A SURVEY OF THE TRACT OF GROUND SHOWN AND THAT IT IS TRUE AND CORRECT TO THE BEST OF MY KNOWLEDGE.

Evan E. Hansen
EVAN E. HANSEN

MARCH 10, 1997
DATE

REVISED 3/10/97

	SECTIONS 8, 9, & 10, T 15 S, R 10 E, S.L.B. & M.	
	Empire Engineering & Land Surveying	
	1665 E. Sagewood Rd. Price, Utah 84501 Phone (801) 637-7498	
	Property Survey For: RIVER GAS - COVAL	
Drawn By: BAK	Approved By: EEH	Drawing No. EEPS-
Date: 3/4/97	Scale: 1" = 200'	