

NW CORNER SECTION 22 T 14 S, R 10 E, S.L.B. & M.

EAST 462.00'

SOUTH 957.00'

STATE ROAD 50-6

NOTE: LENGTH ALONG SOUTH SIDE OF SIDEWALK IS 280.58'

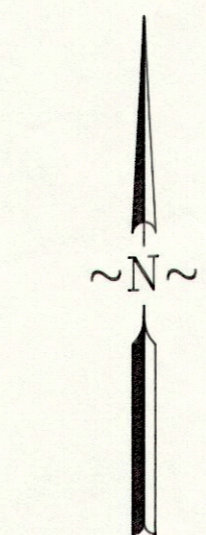

SCALE: 1" = 40'

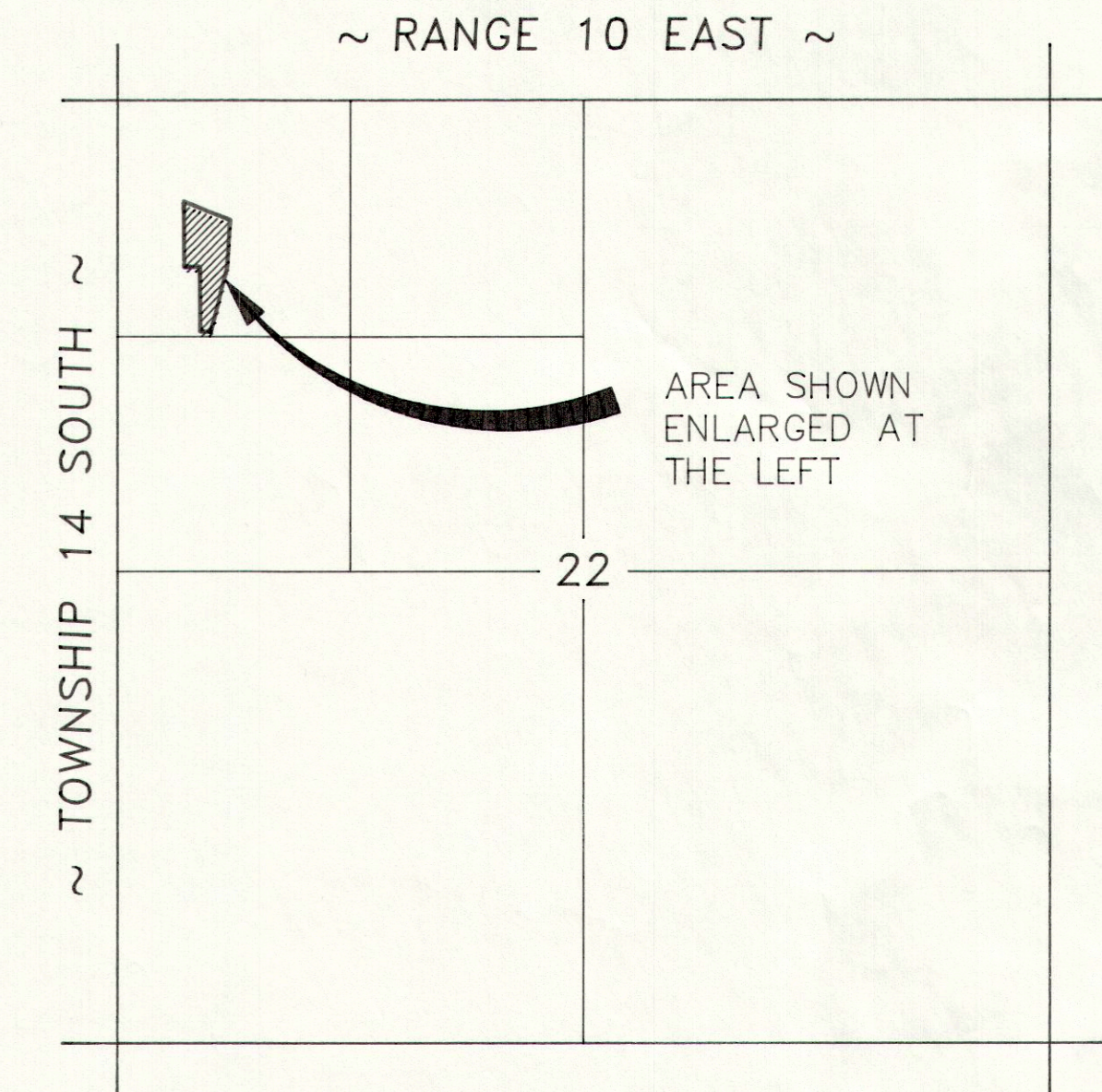

VICINITY MAP

SCALE: 1" = 1000'

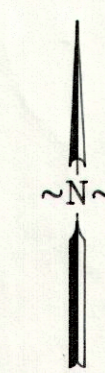

LEGEND

- INDICATES 5/8" x 24" REBAR SET W/ CAP
- ⊕ SECTION CORNER
- x- FENCE LINE
- PROPERTY LINE

PURPOSE

THE PURPOSE OF THIS SURVEY WAS TO STAKE ON THE GROUND THE WARRANTY DEED FOUND IN BOOK 355, PAGE 717-718 IN THE CARBON COUNTY RECORDERS OFFICE.

ENGINEER'S CERTIFICATE

I, EVAN E. HANSEN, DO HEREBY CERTIFY THAT I AM A REGISTERED LAND SURVEYOR AND PROFESSIONAL ENGINEER HOLDING CERTIFICATE NO. 145656 AS PRESCRIBED UNDER THE LAWS OF THE STATE OF UTAH. I FURTHER CERTIFY THAT I HAVE MADE A SURVEY OF THE TRACT OF GROUND SHOWN AND THAT IT IS TRUE AND CORRECT TO THE BEST OF MY KNOWLEDGE.

Evan E. Hansen
EVAN E. HANSEN

SEP 16, 1995
DATE

DESCRIPTION

A PART OF THE NORTHWEST QUARTER OF THE NORTHWEST QUARTER OF SECTION 22, TOWNSHIP 14 SOUTH, RANGE 10 EAST, SALT LAKE BASE AND MERIDIAN, MORE PARTICULARLY DESCRIBED AS FOLLOWS:

BEGINNING AT A POINT NORTH 89°54' EAST, 550.00 FEET FROM THE SOUTHWEST CORNER OF LOT 2, BLOCK 46, PRICE TOWNSITE SURVEY, AND RUNNING THENCE EAST 90.5 FEET, MORE OR LESS, TO A POINT DESCRIBED AS LYING SOUTH 957.00 FEET AND EAST 462.00 FEET FROM THE NORTHWEST CORNER OF SAID SECTION 22, THENCE SOUTH 363.00 FEET; THENCE EAST 58.00 FEET TO THE CENTER OF A WASH; THENCE ALONG THE CENTER OF SAID WASH NORTH 15° EAST, 370.00 FEET; THENCE NORTH 4°30' EAST, 270.00 FEET; MORE OR LESS TO THE SOUTHERLY RIGHT-OF-WAY LINE, OF STATE HIGHWAY 50-6; THENCE WESTERLY ALONG SAID SOUTHERLY RIGHT-OF-WAY LINE, 280.00 FEET, MORE OR LESS, TO A POINT 370.92 FEET NORTH OF THE POINT OF BEGINNING; THENCE SOUTH 370.92 FEET TO THE POINT OF BEGINNING.

RODERICK ENTERPRISES

TERRY FRY & HAROLD MARSTON

PRICE CITY

ISABELLA S. OLIVETO

E.L. PIERCE, TR. & SIAPERAS CONST.

SW CORNER LOT 2, BLOCK 46 PRICE TOWNSITE SURVEY

N 89°54' E - 550.00' (RECORDED)
N 89°24'48" E - 550.00' (MEASURED)

NOTE: SW CORNER LOT 2, BLOCK 46, PRICE TOWNSITE WAS DETERMINED BY SPLITTING CURB & GUTTER ON 500 EAST AND 100 SOUTH

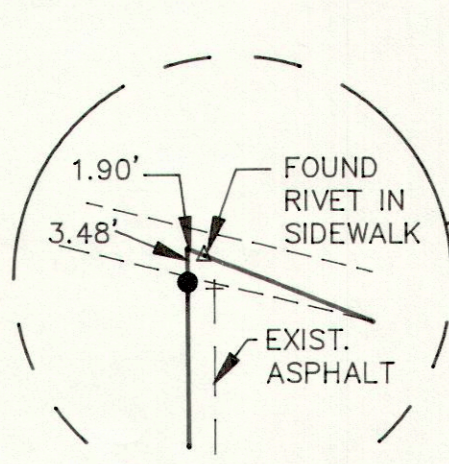

HMARSTON 09/16/95 23:20

	NW1/4 NW1/4 SECTION 22, T 14 S, R 10 E, S.L.B. & M.	
	Empire Engineering & Land Surveying	
	1665 E. Sagewood Rd. Price, Utah 84501 Phone (801) 637-7498	
	Property Survey For: TERRY FRY & HAROLD MARSTON	
Drawn By: THK	Approved By: EEH	Drawing No. EEPS-270 D
Date: 9/16/95	Scale: 1" = 40'	