

**DESCRIPTION**

**PROPERTY DESCRIPTION**

A PARCEL OF LAND LOCATED IN CARBON COUNTY, STATE OF UTAH, WHICH IS IN THE NORTHWEST QUARTER OF THE SOUTHEAST QUARTER OF SECTION 1, TOWNSHIP 15 SOUTH, RANGE 10 EAST, SALT LAKE BASE AND MERIDIAN; BEING FURTHER DESCRIBED AS FOLLOWS WITH A BEARING OF NORTH 89°42'22" EAST BETWEEN THE SOUTH QUARTER CORNER AND THE SOUTHEAST CORNER OF SAID SECTION 1, USED AS THE BASIS OF BEARING.

BEGINNING AT A POINT WHICH IS LOCATED NORTH 89°46'35" EAST, 755.16 FEET ALONG THE CENTER OF SECTION LINE AND SOUTH 01°3'25" EAST, 635.62 FEET FROM THE NORTHWEST CORNER OF THE SOUTHEAST QUARTER OF SECTION 1, TOWNSHIP 15 SOUTH, RANGE 10 EAST, SALT LAKE BASE AND MERIDIAN; (NOTE: SAID NORTHWEST CORNER OF THE SOUTHEAST QUARTER IS LOCATED NORTH 0°26'16" WEST, 2678.25 FEET FROM THE SOUTH QUARTER CORNER OF SAID SECTION 1, WHICH IS A BRASS CAP IN A CONCRETE CYLINDER); AND RUNNING THENCE SOUTH 17°38'53" EAST, 199.39 FEET; THENCE SOUTH 64°02'08" WEST, 198.08 FEET; THENCE NORTH 15°54'38" WEST, 197.14 FEET; THENCE NORTH 63°05'15" EAST, 192.53 FEET TO THE POINT OF BEGINNING.

CONTAINS 0.876 ACRES, MORE OR LESS.

**ROAD EASEMENT**

BEGINNING AT A POINT WHICH IS LOCATED NORTH 89°46'35" EAST, 483.36 FEET ALONG THE CENTER OF SECTION LINE AND SOUTH 01°3'25" EAST, 1019.76 FEET FROM THE NORTHWEST CORNER OF THE SOUTHEAST QUARTER OF SECTION 1, TOWNSHIP 15 SOUTH, RANGE 10 EAST, SALT LAKE BASE AND MERIDIAN; SAID POINT OF BEGINNING IS LOCATED ON THE NORTH RIGHT-OF-WAY LINE OF STATE HIGHWAY NO. 6; AND RUNNING THENCE NORTH 81°12'02" EAST, 310.61 FEET; THENCE NORTH 9°11'48" WEST, 127.78 FEET TO A POINT ON A PARCEL OF LAND TO BE DEEDED TO ROBERT C. AND DALENE P. HOGGATT, HUSBAND AND WIFE; THENCE NORTH 64°02'08" EAST, 20.88 FEET ALONG SAID PROPERTY LINE; THENCE SOUTH 10°09'15" EAST, 153.82 FEET; THENCE SOUTH 81°22'55" WEST, 318.28 FEET TO THE NORTH RIGHT-OF-WAY LINE OF SAID ROAD; THENCE NORTH 47°24'14" WEST, 24.09 FEET TO THE POINT OF BEGINNING.

CONTAINS 0.21 ACRES, MORE OR LESS.

**UTILITY EASEMENT**

BEGINNING AT A POINT WHICH IS LOCATED NORTH 89°46'35" EAST, 430.18 FEET ALONG THE CENTER OF SECTION LINE AND SOUTH 01°3'25" EAST, 969.09 FEET FROM THE NORTHWEST CORNER OF THE SOUTHEAST QUARTER OF SECTION 1, TOWNSHIP 15 SOUTH, RANGE 10 EAST, SALT LAKE BASE AND MERIDIAN; SAID POINT OF BEGINNING IS LOCATED ON THE NORTH RIGHT-OF-WAY LINE OF STATE HIGHWAY NO. 6; AND RUNNING THENCE NORTH 48°27'42" EAST, 208.97 FEET; THENCE NORTH 56°01'10" EAST, 142.01 FEET; THENCE SOUTH 33°58'50" EAST, 20.00 FEET; THENCE SOUTH 56°01'10" WEST, 140.69 FEET; THENCE SOUTH 48°27'42" WEST, 207.65 FEET TO THE NORTH RIGHT-OF-WAY LINE OF SAID ROAD; THENCE NORTH 41°32'18" WEST, 20.00 FEET TO THE POINT OF BEGINNING.

CONTAINS 0.16 ACRES, MORE OR LESS. ETAETA

~ RANGE 10 EAST ~

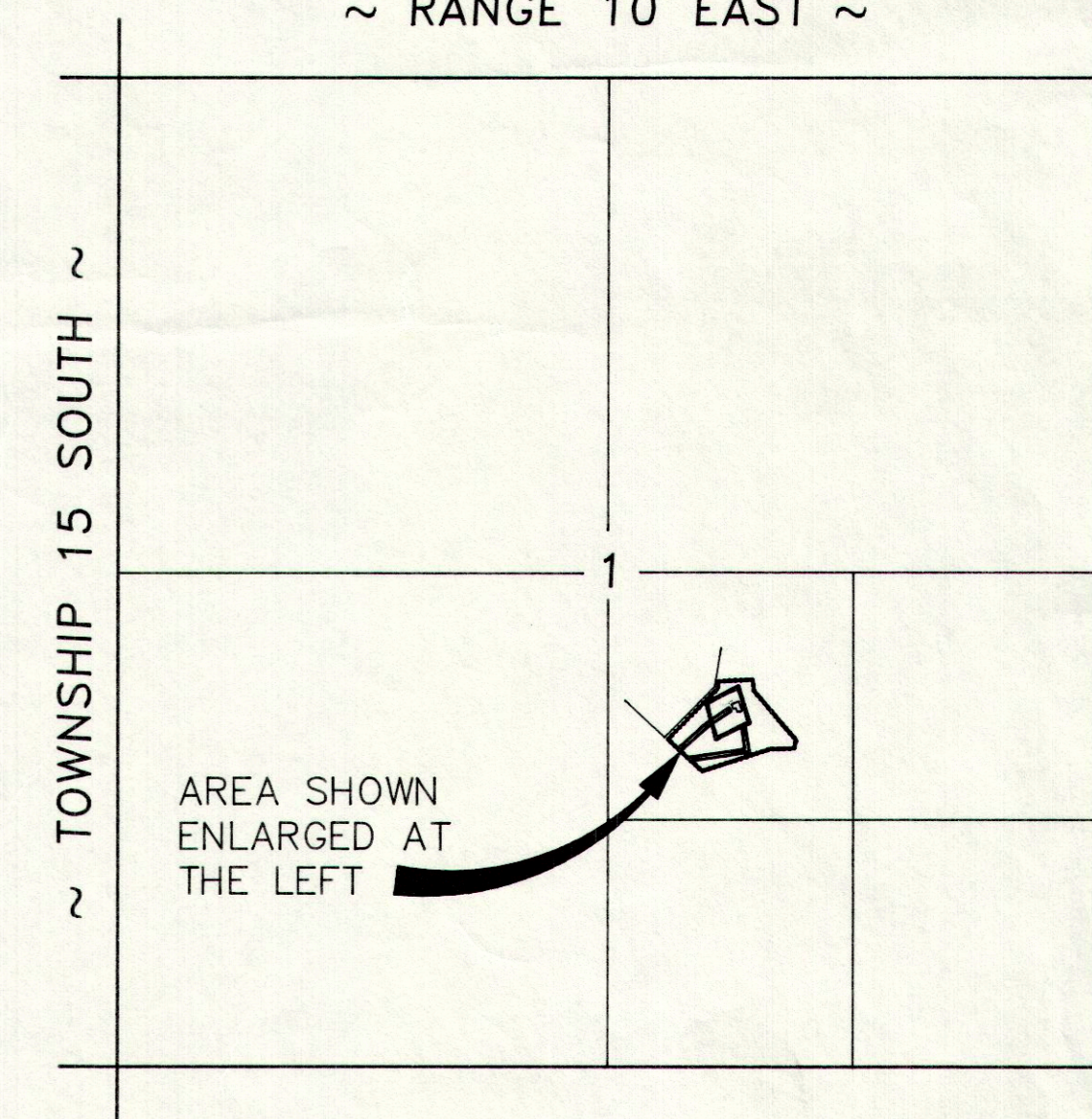

AREA SHOWN ENLARGED AT THE LEFT

**VICINITY MAP**

**LEGEND**

- INDICATES 5/8" x 24" REBAR SET W/ CAP
- ⊕ SECTION CORNER
- x FENCE LINE
- PROPERTY LINE
- - - SECTION LINE OR FORTY ACRE LINE

**PURPOSE**

TO PREPARE A LEGAL DESCRIPTION OF THE 0.826 ACRE PARCEL OF LAND AND ALSO PREPARE ROAD AND UTILITY EASEMENT DESCRIPTIONS.

**ENGINEER'S CERTIFICATE**

I, EVAN E. HANSEN, DO HEREBY CERTIFY THAT I AM A REGISTERED LAND SURVEYOR AND PROFESSIONAL ENGINEER HOLDING CERTIFICATE NO. 145656 AS PRESCRIBED UNDER THE LAWS OF THE STATE OF UTAH. I FURTHER CERTIFY THAT I HAVE MADE A SURVEY OF THE TRACT OF GROUND SHOWN AND THAT IT IS TRUE AND CORRECT TO THE BEST OF MY KNOWLEDGE.

*Evan E. Hansen*  
EVAN E. HANSEN

*Aug. 17, 1998*  
DATE

	NW1/4 SE1/4 SECTION 1, T 15 S, R 10 E, S.L.B. & M.	
	<b>Empire Engineering &amp; Land Surveying</b>	
	1665 E. Sagewood Rd., Price, Utah 84501 Phone (801) 637-5748	
	Property Survey For: <b>DALE PILLING &amp; ROBERT HOGGATT</b>	
Drawn By: THK	Approved By: EEH	Drawing No.
Date: 8/14/98	Scale: 1" = 50'	EEPS-307D