

DESCRIPTION

A PARCEL OF LAND LOCATED IN PRICE CITY, STATE OF UTAH, WHICH IS IN THE SOUTHWEST QUARTER OF THE SOUTHWEST QUARTER OF SECTION 16, TOWNSHIP 14 SOUTH, RANGE 10 EAST, SALT LAKE BASE AND MERIDIAN, WHICH IS ALSO A PORTION OF LOT 7, BLOCK 6, LOCAL SURVEY; BEING FURTHER DESCRIBED AS FOLLOWS WITH A BEARING OF NORTH 89°31'01" EAST, BETWEEN THE SOUTHWEST CORNER AND THE SOUTHEAST CORNER OF SAID SECTION 16 USED AS THE BASIS OF BEARING.

BEGINNING AT THE SOUTHWEST CORNER OF LOT 7, BLOCK 6, LOCAL SURVEY, PRICE, CARBON COUNTY, UTAH; SAID BEGINNING POINT IS ALSO LOCATED NORTH 00°36'35" WEST, 995.00 FEET ALONG THE SECTION LINE FROM THE SOUTHWEST CORNER OF SECTION 16, TOWNSHIP 14 SOUTH, RANGE 10 EAST, SALT LAKE BASE AND MERIDIAN; AND RUNNING THENCE NORTH 89°31'01" EAST, 410.50 FEET; THENCE NORTH 00°36'35" WEST, 149.30 FEET TO THE NORTH LINE OF SAID LOT 7; THENCE SOUTH 89°31'01" WEST, 410.50 FEET ALONG THE NORTH LINE OF SAID LOT 7 TO THE NORTHWEST CORNER OF LOT 7; THENCE SOUTH 00°36'35" EAST, 149.30 FEET TO THE POINT OF BEGINNING.

CONTAINS 1.407 ACRES, MORE OR LESS.

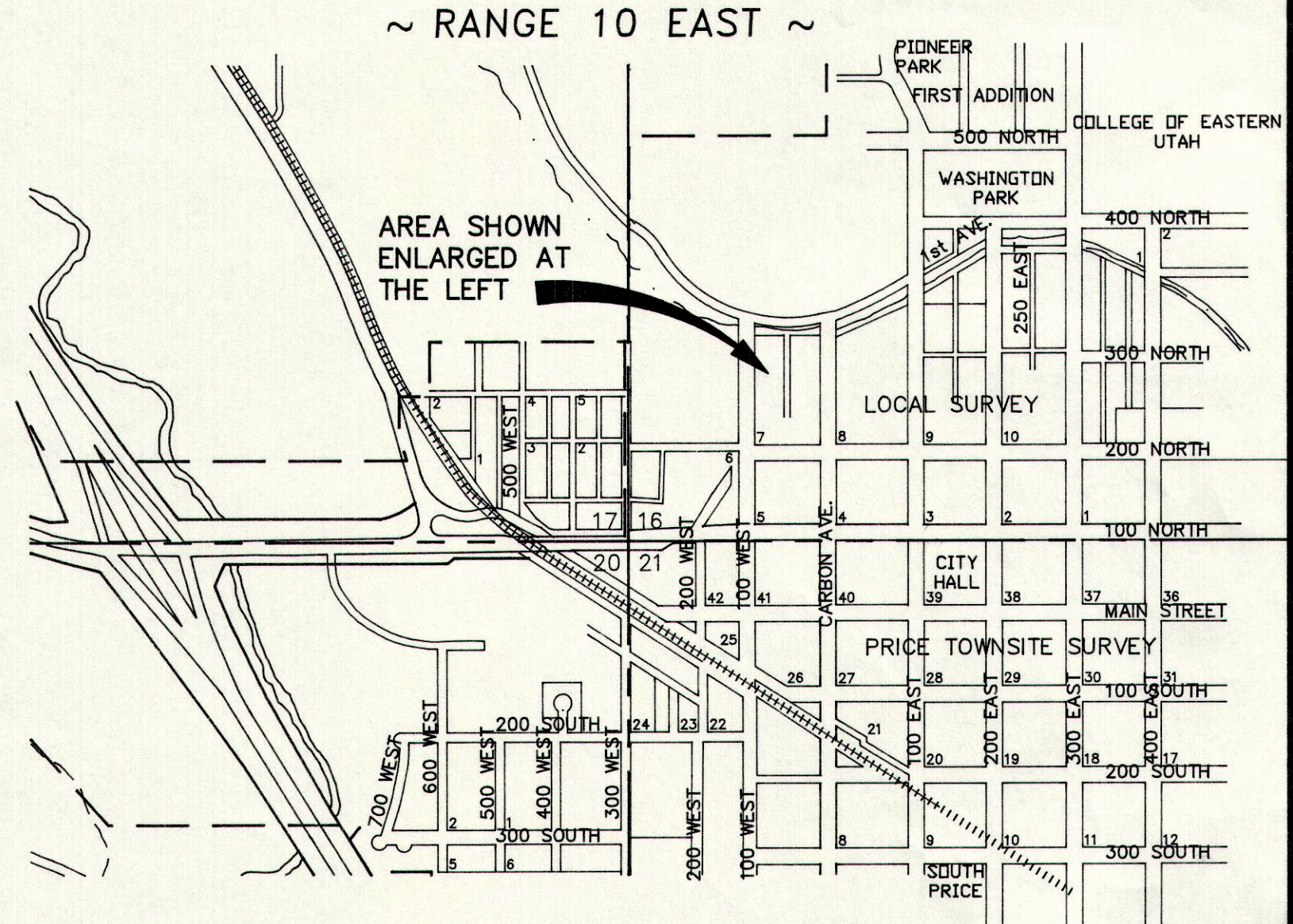
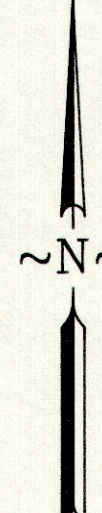

VICINITY MAP

LEGEND

- INDICATES 5/8" x 24" REBAR SET W/ CAP
- ⊕ SECTION CORNER
- x — FENCE LINE
- — — — — PROPERTY LINE
- — — — — SECTION LINE

PURPOSE

THE PURPOSE OF THIS SURVEY WAS TO STAKE ON THE GROUND A PORTION OF THE LAND DESCRIBED IN A DEED FOUND IN BOOK 278, PAGE 415 AS RECORDED IN THE CARBON COUNTY RECORDER'S OFFICE AND PROVIDE PUBLIC UTILITY EASEMENTS, WATER AND SEWER EASEMENTS ALONG WITH INGRESS AND EGRESS.

ENGINEER'S CERTIFICATE

I, EVAN E. HANSEN, DO HEREBY CERTIFY THAT I AM A REGISTERED LAND SURVEYOR AND PROFESSIONAL ENGINEER HOLDING CERTIFICATE NO. 145656 AS PRESCRIBED UNDER THE LAWS OF THE STATE OF UTAH. I FURTHER CERTIFY THAT I HAVE MADE A SURVEY OF THE TRACT OF GROUND SHOWN AND THAT IT IS TRUE AND CORRECT TO THE BEST OF MY KNOWLEDGE.

Evan E. Hansen SEPT. 27, 1997
 EVAN E. HANSEN DATE

SW1/4 SW1/4 SECTION 16, T 14 S, R 10 E, S.L.B. & M.

Empire Engineering & Land Surveying

1665 E. Sagewood Rd. Price, Utah 84501 Phone (801) 637-5748

Property Survey For:
DOMINICK BESSO AND SHAUNA FASSETT

Drawn By: THK	Approved By: EEH	Drawing No.
Date: 9/27/97	Scale: 1" = 30'	EEPS-296 D

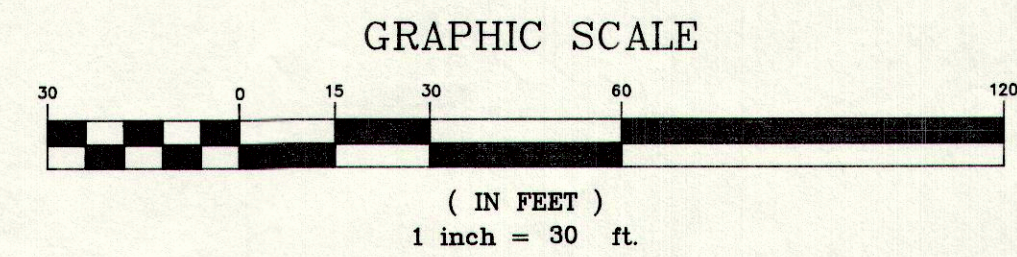
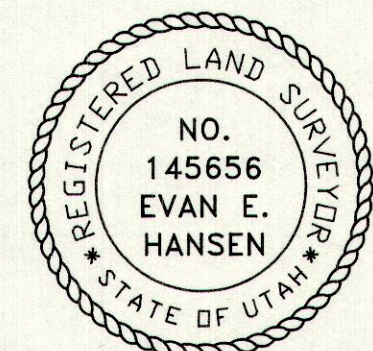

SW CORNER SECTION 16 T 14 S., R 10 E. S.L.B. & M.