

Legend

- Conc. Monument
- Rebar/cap set
- Existing test pit

Description

A 30 foot wide Easement, being part of Lot # 1 in Section 18, Township 15 South, Range 11 East of the Salt Lake Base & Meridian. To be used for Roadway purposes being 15 feet on both sides of the following described Centerline.

Beginning South 89°24'15" West along the North Section line 1292.44 feet and South 87°6.35 feet from the Northeast corner of Section 18, Township 15 South, Range 11 East of the Salt Lake Base & Meridian.

Thence North 37°32'46" East 90.21 feet; thence North 89°29'19" East 204.07 feet; thence North 84°03'32" East 532.64 feet; thence North 88°07'10" East 245.04 feet; thence 69°31'48" East 117.10 feet to the point of Terminus, said point being South 00°49'69" East along the Easterly line of said Section 280.84 feet.

Containing 41,200 sq. ft. 0.95 acres

Surveyor's Certificate

I Art F Barker do hereby depose and say that I am a Registered Land Surveyor as prescribed by the laws of the State of Utah, and that I hold license No. 182812. I further certify that I have made a Survey of the property as shown hereon.

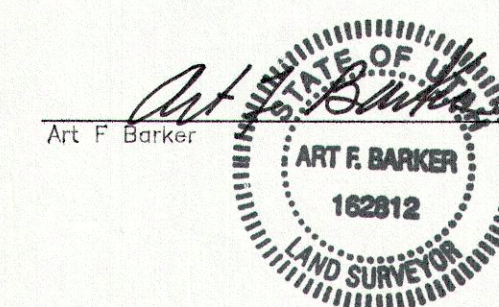

Date: 3/19/96

PROJECT: LOCATION SURVEY	
FOR: WELLINGTON CITY CORPORATION KEN POWELL 150 WEST MAIN P.O. BOX 559 WELLINGTON UTAH (801) 637-5213	PREPARED BY: ART F. BARKER & ASSOCIATES SURVEYING & ENGINEERING 36 WEST MAIN STREET WELLINGTON, UTAH 84542 (801) 637-2394