

ANADARKO PETROLEUM CORP.

PROPERTY SURVEY

LOCATED IN THE SE 1/4 SE 1/4
 OF SECTION 8, T14S, R10E, S.L.B.&M.
 CARBON COUNTY, UTAH

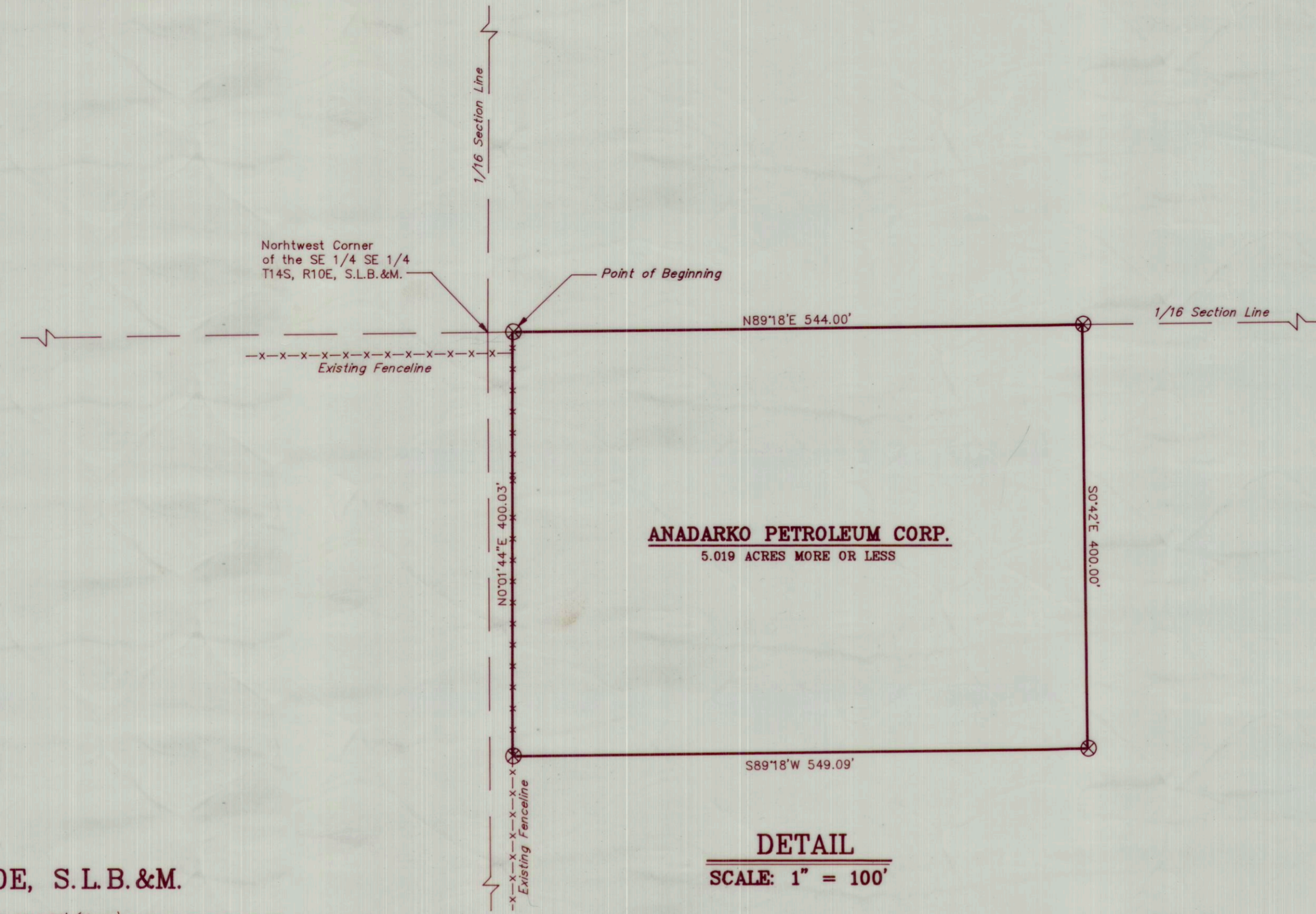
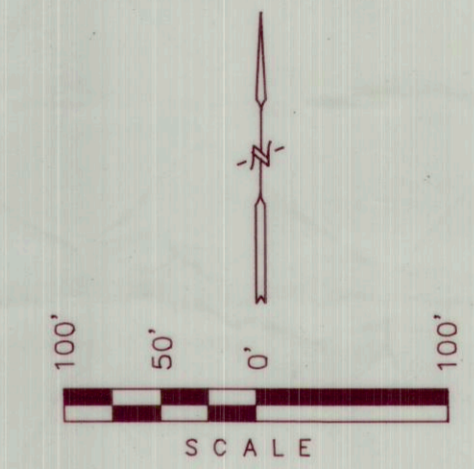

T14S, R10E, S.L.B.&M.

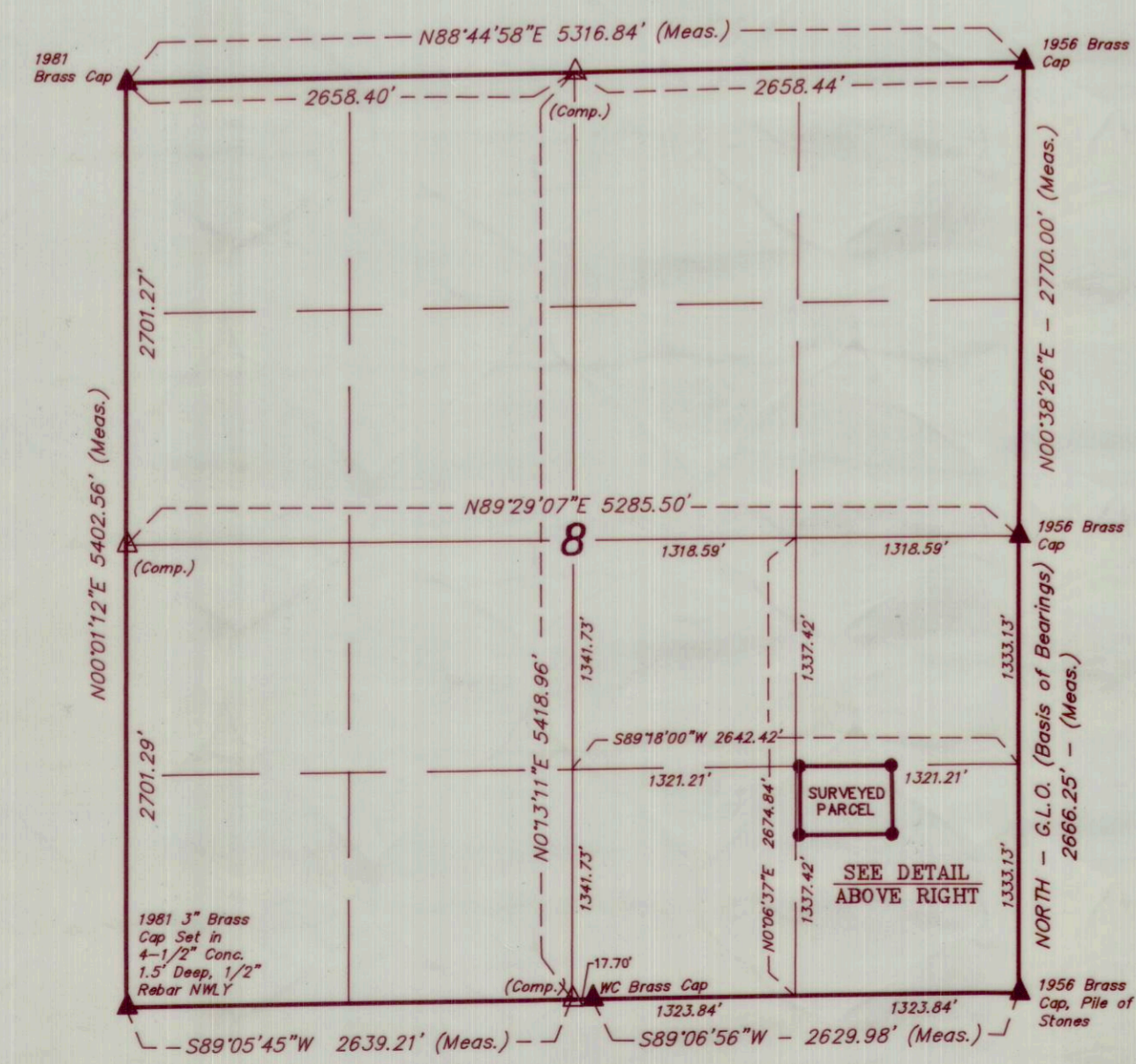

DETAIL
 SCALE: 1" = 100'

PROPERTY DESCRIPTION

BEGINNING AT A POINT IN THE SE 1/4 SE 1/4 OF SECTION 8, T14S, R10E, S.L.B.&M. WHICH BEARS S43°53'07"W 1871.68' FROM THE EAST 1/4 CORNER OF SAID SECTION 8, THENCE N89°18'E 544.00'; THENCE S0°42'E 400.00'; THENCE S89°18'W 549.09' TO AN EXISTING FENCELINE; THENCE N0°01'44"E 400.03' ALONG SAID FENCELINE TO THE POINT OF BEGINNING. CONTAINS 5.019 ACRES MORE OR LESS. BASIS OF BEARINGS IS THE EAST LINE OF THE SE 1/4 OF SECTION 8, T14S, R10E, S.L.B.&M. WHICH IS ASSUMED FROM G.L.O. INFORMATION TO BEAR NORTH.

SURVEYORS NARRATIVE

WE WERE REQUESTED BY ANADARKO PETROLEUM CORP. TO SURVEY A PARCEL OF LAND LOCATED IN THE SE 1/4 SE 1/4 OF SECTION 8, T14S, R10E, S.L.B.&M. AS BASIS OF BEARINGS WE HAVE ASSUMED THE G.L.O. BEARING OF NORTH ALONG THE EAST LINE OF THE SE 1/4 OF SAID SECTION 8.

CERTIFICATE

THIS IS TO CERTIFY THAT THE ABOVE PLAT WAS PREPARED FROM FIELD NOTES OF ACTUAL SURVEYS MADE BY ME, GRINDER MY UNDER MY SUPERVISION AND THAT THE SAME ARE TRUE AND CORRECT TO THE BEST OF MY KNOWLEDGE AND BELIEF.

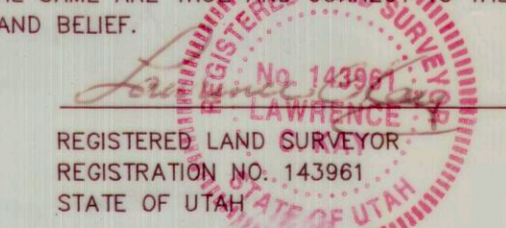

COUNTY SURVEYOR'S CERTIFICATE

THE CARBON COUNTY SURVEYOR HAS CHECKED THIS PLAT FOR FORM AND ADHERANCE TO THE STATE OF UTAH REQUIREMENTS FOR ITEMS TO BE ON A SURVEYOR'S PLAT FOR RECORDING WITH THE COUNTY SURVEYOR'S OFFICE, ON THIS _____ DAY OF _____, 19__.

THE CARBON COUNTY SURVEYOR

REVISED: 6-16-99 D.COX

| | |
|--|--------------------|
| UELS UINTAH ENGINEERING & LAND SURVEYING PHONE: (435) 789-1017 85 SOUTH 200 EAST - VERNAL, UTAH 84078 | |
| SCALE: 1" = 100' | DATE: 6-14-99 |
| SURVEYED BY: L.D.T. S.L. D.COX | DRAWN BY: D.COX |
| WEATHER: WARM | FILE: 3 1 6 9 5 |

- ⊗ = PROPERTY CORNERS SET (1-1/2" A.C. on 5/8" Rebar #2454)
- ▲ = SECTION CORNERS LOCATED.