

NORTH 1/4 CORNER
SECTION 15
T 15 S, R 10 E
S.L.B. & M.

1230.72'
S00°35'24"E

COUNTY ROAD

P.O.B.

356.11'
N00°35'24"W

COUNTY ROAD

SOUTH 1/4 CORNER
SECTION 15
T 15 S, R 10 E
S.L.B. & M.

DESCRIPTION

A PARCEL OF LAND LOCATED IN CARBON COUNTY, STATE OF UTAH, WHICH IS LOCATED IN THE WEST HALF OF THE NORTHEAST QUARTER OF SECTION 15, TOWNSHIP 15 SOUTH, RANGE 10 EAST SALT LAKE BASE AND MERIDIAN, BEING FURTHER DESCRIBED AS FOLLOWS WITH A BEARING OF SOUTH 0°35'24" EAST BETWEEN THE NORTH QUARTER CORNER AND THE SOUTH QUARTER CORNER OF SAID SECTION 15 USED AS THE BASIS OF BEARING.

BEGINNING AT A POINT WHICH IS LOCATED SOUTH 0°35'24" EAST ALONG THE CENTER OF SECTION LINE, 1230.72 FEET FROM THE NORTH QUARTER CORNER OF SECTION 15, TOWNSHIP 15 SOUTH, RANGE 10 EAST, SALT LAKE BASE AND MERIDIAN; AND RUNNING THENCE NORTH 89°24'36" EAST, 727.53 FEET TO AN EXISTING FENCE LINE; THENCE SOUTH 10°46'06" EAST, 361.80 FEET ALONG AN EXISTING FENCE LINE; THENCE SOUTH 89°24'36" WEST, 791.47 FEET TO THE CENTER OF SECTION LINE; THENCE NORTH 0°35'24" WEST ALONG SAID CENTER OF SECTION LINE, 356.11 FEET TO THE POINT OF BEGINNING.
LESS COUNTY ROAD RIGHT-OF-WAY.

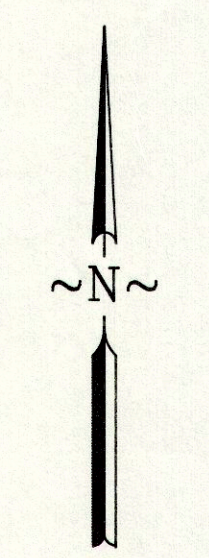

SCALE: 1" = 50'

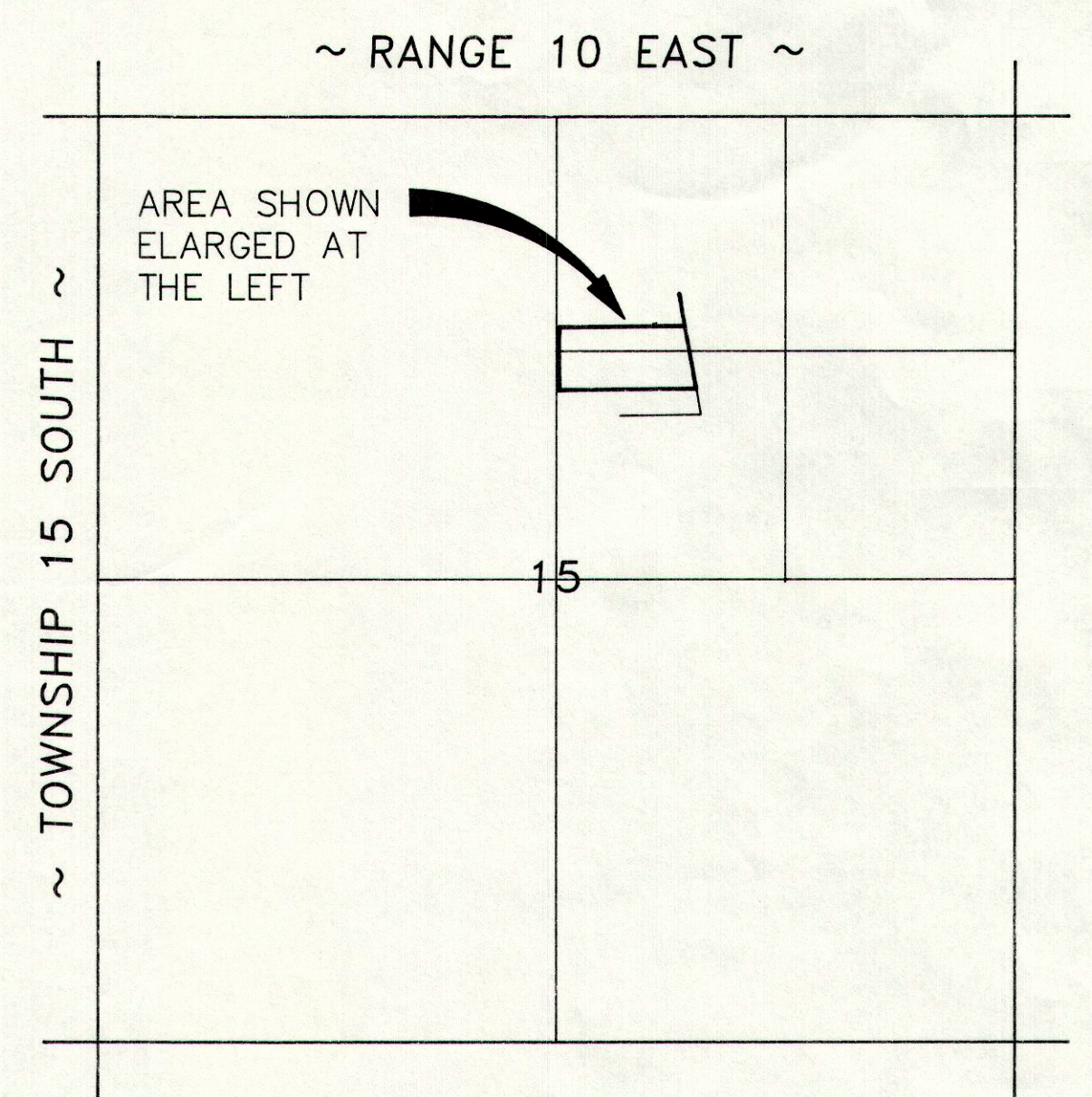
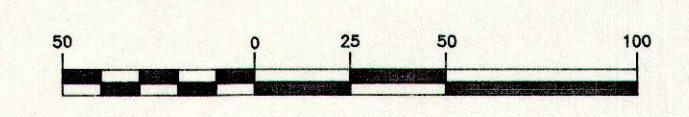

VICINITY MAP

SCALE: 1" = 1000'

LEGEND

- INDICATES 5/8" x 24" REBAR SET W/ CAP
- SECTION CORNER
- FENCE LINE
- PROPERTY LINE
- SECTION LINE

PURPOSE

ROBERT AND TEENA JARAMILLO

6.21 ACRES

N89°24'36"E
727.53'

EXISTING SHED

S10°46'06"E
361.80'

S89°24'36"W
791.47'

ENGINEER'S CERTIFICATE

I, EVAN E. HANSEN, DO HEREBY CERTIFY THAT I AM A REGISTERED LAND SURVEYOR AND PROFESSIONAL ENGINEER HOLDING CERTIFICATES NO. 3115 AND NO. 3354 AS PRESCRIBED UNDER THE LAWS OF THE STATE OF UTAH. I FURTHER CERTIFY THAT I HAVE MADE A SURVEY OF THE TRACT OF SHOWN AND THAT IT IS TRUE AND CORRECT TO THE BEST OF MY KNOWLEDGE.

Evan E. Hansen MARCH 17, 1999
EVAN E. HANSEN DATE

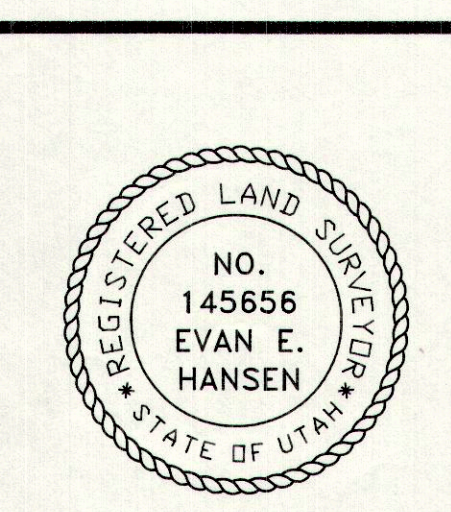

NE1/4 SECTION 15, T 14 S, R 10 E, S.L.B. & M.		
Empire Engineering & Land Surveying		
1665 E. Sagewood Rd. Price, Utah 84501 Phone (801) 637-5748		
Property Survey For: ROBERT AND TEENA JARAMILLO		
Drawn By: THK	Approved By: EEH	Drawing No.
Date: 3/12/99	Scale: 1" = 50'	EEPS-311C