

P.O.B. (FOR PROPERTY DESC.)
NE CORNER; SE 1/4; SW 1/4; SECT. #8

NARRATIVE:
THE PURPOSE OF THIS SURVEY WAS TO DETERMINE THE LOCATION OF THE BOUNDARY LINES FOR THE PARCEL SHOWN ON THE LEFT AND DESCRIBED BELOW. THE BASIS FOR THE DETERMINATION OF THESE BOUNDARY LINES WAS: THE DESCRIPTION RECORDED IN BOOK #28 ON PAGE #148 AT THE CARBON COUNTY COURTHOUSE; ALSO BASED UPON FIELD NOTES OBTAINED FROM A SURVEY MADE ON APRIL 5, 1989. SAID INFORMATION WAS TRANSLATED INTO THE UTAH STATE PLANE COORDINATE SYSTEM.

SURVEY DESCRIPTION:
BEGINNING AT A POINT 1,340.66 FEET SOUTH AND 3.99 FEET EAST OF THE NORTH EAST CORNER OF THE SOUTH WEST 1/4 OF SECTION #8, T 14 S, R 10 E, SLB&M; RUNNING THENCE S 00°12'18" E 779.90 FEET; THENCE S 88°47'06" W 25 FEET; THENCE N 00°10'17" W 200.42 FEET; THENCE S 88°42'00" W 195.12 FEET; THENCE N 00°11'18" W 333.71 FEET; THENCE S 88°50'09" W 481.32 FEET; THENCE N 00°16'00" W 246.72 FEET; THENCE N 88°52'20" E FOR 701.72 FEET TO THE POINT OF BEGINNING...

EASEMENT DESCRIPTION:
THE ABOVE DESCRIBED PARCEL ALSO INCLUDES A RIGHT OF WAY EASEMENT WHICH IS 28 FEET IN WIDTH. THE FOLLOWING IS A DESCRIPTION OF SAID EASEMENT. BEGINNING AT POINT 1,596.87 FEET SOUTH AND 1,319.45 FEET WEST OF THE NE CORNER OF SW 1/4 OF SECT. #8, T 14 S, R 10 E, SLB&M; RUNNING THENCE N 89°06'10" E 623.27 FEET TO A POINT ON THE WEST PROPERTY LINE OF THE PARCEL DESCRIBED ABOVE. FOR CLOSURE PROCEED FROM THIS POINT N 23°41'13" E 1,733.12 FEET TO THE NE CORNER OF THE SW 1/4 OF SECT #8; THENCE S 39°33'58" W 2,071.46 FEET TO THE POINT OF BEGINNING...

EXISTING DEED DESCRIPTION (BOOK #28 PAGE #148)
BEG NE COR OF SE 1/4 SW 1/4, SEC #8, T14S, R10E, SLM;
TH S 76°7.5 FT; TH W 25 FT; TH N 197 FT; TH W 195 FT; TH N 328 FT;
TH W 481 FT; TH N 242.5 FT; TH E 701 FT TO BEG.

SURVEYOR'S CERTIFICATE:
I, ART F. BARKER DO HEREBY DEPOSE AND SAY THAT I AM A REGISTERED LAND SURVEYOR AS PRESCRIBED BY THE LAWS OF THE STATE OF UTAH AND HOLD CERTIFICATE #5981. I FURTHER CERTIFY THAT I HAVE MADE A REASONABLE EXAMINATION OF THE PROPERTY SHOWN HEREWITH.
ART F. BARKER----- DATE: 2/14/89-----

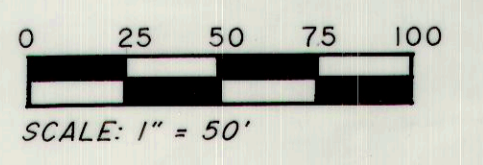
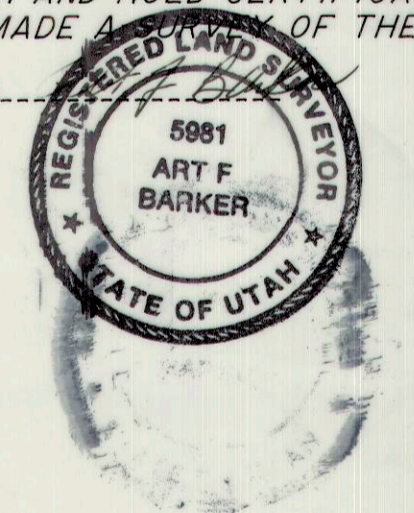

LOT DESCRIPTIONS:
AT THE REQUEST OF THE OWNER THE PARCEL SHOWN ABOVE AND DESCRIBED AT THE RIGHT SIDE OF THIS PLAT WAS DIVIDED TO INCLUDE LOTS #1 AND #2. THEIR DESCRIPTIONS ARE AS FOLLOWS:
LOT #1 BEGINNING AT A POINT 1,573.11 FEET SOUTH AND 696.33 FEET WEST OF THE NE CORNER OF THE SW 1/4 OF SECTION #8, T 14 S, R 10 E, SLB&M; RUNNING THENCE N 00°16'00" W 218.66 FEET; THENCE N 88°52'20" E 199.97 FEET; THENCE S 00°16'22" E 218.52 FEET; THENCE S 88°50'09" W 200.00 FEET TO THE POINT OF BEGINNING...
LOT #2 BEGINNING AT A POINT 1,569.05 FEET SOUTH AND 496.37 FEET WEST OF THE NE CORNER OF THE SW 1/4 OF SECTION #8, T 14 S, R 10 E, SLB&M; RUNNING THENCE N 00°16'22" W 218.52 FEET; THENCE N 88°52'20" E 200.03 FEET; THENCE S 00°15'54" E 218.40 FEET; THENCE S 88°50'09" W 200.00 FEET TO THE POINT OF BEGINNING...

NOTES:
#1 DENOTES "40" CORNERS
#2 DENOTES CORNERS SET WITH REBAR AND A PLASTIC CAP SAYING, "ART BARKER LS #5981" OR A NAIL DRIVEN INTO THE ASPHALT WHERE NECESSARY.
#3 BEARINGS AND DISTANCES AS THEY ARE WRITTEN IN THE EXISTING DEED DESCRIPTION ARE SHOWN IN (PARENTHESES) ON THIS PLAT.

TYPE OF SURVEY BOUNDARY SURVEY	
FOR DAVID and ARLENE CLARK 522 WEST 1100 NORTH CARBONVILLE, UTAH 84501 637-1498	PREPARED BY ART F. BARKER & ASSOCIATES SURVEYING and ENGINEERING 36 WEST MAIN WELLINGTON, UTAH 84542 18011 637-2394