

File: 16629, P: P616, P: 11A
 Date: 07-APR-2006 11:06AM
 Field Book: CH
 SHARON MURDOCK, Recorder
 CARBON COUNTY CORPORATION
 For: EVAN HANSEN

Boundary Description (area surveyed)
 Beginning at the Northwest corner of Lot 7, Block 3 of the Carbon Annex to Price City, and running thence North 90°00'00" East 12.00 feet along the North line of said Lot 7; thence South 00°00'00" West 25.70 feet; thence South 90°00'00" West 1.00 feet; thence South 00°00'00" West 38.80 feet; thence South 90°00'00" West 3.00 feet; thence South 00°00'00" West 114.62 feet more or less to the Price Canal; thence North 41°12'30" West 12.14 feet along the Price Canal to the Southwest Corner of said Lot 7; thence North 00°00'00" East 170.00 feet along the West line of said Lot 7 to the point of beginning.

Contains: 1615.71 square feet, 0.037 acres, more or less, (as described)

Narrative
 The purpose of this survey was to establish the property line between Lots 7 and 8 of the Carbon Annex to Price City.

Surveyor's Certificate
 I, Bruce T. S. Ware, do hereby certify that I am a Registered Land Surveyor, certificate No. 153834 as prescribed under the laws of the state of Utah. I further certify that I have made a survey of the tract of ground shown and that it is true and correct to the best of my knowledge. It does not purport to show all easements of record, nor is it proof of ownership.

Bruce T. S. Ware, Mgr. Date: *Sept. 17, 2000*
 Bruce T. S. Ware, Mgr. Date

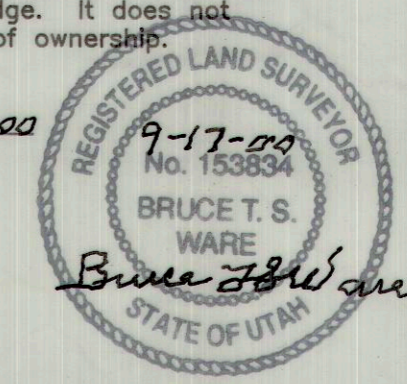

REVISIONS No. DATE BY REVISION			ORDER BY: J.M.G.W. DESIGN BY: B.T.S.W. CHECKED BY: B.T.S.W. DATE: 9/17/00	CLIENT: RICHARD MORLEY DWG: EA/CURRENT/MORLEY JOB No: MORLEY	Bruce Ware Surveying 2223 N. 1200 W. Helper, UT 84526 tel (435) 637-2620	Property Survey for: Richard H. Morley 470 E. College Ave, Price, UT 84501	Lots 7 & 8, Block 3, Carbon Annex to Price City
-----------------------------------	--	--	--	--	--	--	--