

- LEGEND**
- PROPERTY LINE
 - - - SECTION LINE
 - - - 40 ACRE LINE
 - - - BEARING DIRECTION TO POINT OF BEGINNING
 - x x x FENCE LINES
 - SET 5/8" X 24" REBAR WITH CAP
 - ◆ SECTION CORNER FOUND
 - ◆ 1/16 Section Corner
- PURPOSE**
- The purpose of this survey is to stake on the ground selected points of a Quit-Claim Deed in book 395 page 412, recorded in the Carbon County Courthouse on September 24, 1997 to A. Dan Oman and Jacquelyn B. Oman. The basis of bearing is North 01° 23' 03" West, between the West Quarter Corner and the Northwest Corner of Section 17, Township 14 South, Range 10 East, Salt Lake Base and Meridian.
- PARCEL 1:** Beginning at a point 603.5 feet North, (ALONG THE SECTION LINE NORTH 01°23'03" WEST, 603.5 FEET) and 289.00 feet East, (NORTH 88°36'57" EAST, 289.00 FEET MEASURED) of the Southwest Corner of the Northwest Quarter, Section 17, Township 14 South, Range 10 East, Salt Lake Base and Meridian; thence East, 653 feet (NORTH 88°36'57" EAST, 653 FEET MEASURED); thence North 100 feet (NORTH 1°23'03" WEST, 100 FEET MEASURED); thence Northwesterly 162.50 feet (NORTH 59°40'19" WEST, 220.68 FEET) to a point 819.5 feet North (NORTH 1°23'03" EAST, 819.5 FEET MEASURED) and 754.27 feet East (NORTH 88°36'57" EAST, 754.27 FEET MEASURED) of the Southwest Corner of said Northwest Quarter; thence South 84°44' East, 500 feet (SOUTH 86°07'03" EAST 500 FEET, MEASURED) to the Price River; thence Southerly and Southeasterly along the Price River (SOUTH 5°18'52" EAST, 774.34 FEET) to a point East of Southwest Corner of said Northwest Quarter; thence West Approximately 650 feet (SOUTH 88°34'05" WEST, 648.63 FEET, MEASURED) to a point 656.60 feet East (NORTH 88°34'05" EAST, 656.60 FEET) of the Southwest Corner of said Northwest Quarter; thence North 31° 56' West, 695 feet (NORTH 32°45'13" WEST, 706.18 FEET, MEASURED) to the point of beginning.
- PARCEL 2:** Beginning at the Southwest Corner of the Northwest Quarter, Section 17, Township 14 South, Range 10 East, Salt Lake Base and Meridian; thence North 490.5 feet (ALONG THE SECTION LINE NORTH 01°23'03" WEST, 490.5 FEET) to the South boundary of the County Road Right-of-way; thence Northeasterly along County Road Right-of-way (NORTH 55°00'32" EAST 31.94 FEET, MEASURED) to the State Highway Right-of-way; thence Southerly, 145 feet (SOUTH 01°23'03" EAST, 145.00 FEET) along the State Highway Right-of-way; thence South 31°56' West (SHOULD OF BEEN EAST), 426 feet (SOUTH 32°56'57" EAST, 426.00 FEET, MEASURED); more or less to the South line of said Northwest Quarter; thence West, 249.6 feet (SOUTH 88°34'05" WEST, 249.60) more or less to the point of beginning.

ENGINEER'S CERTIFICATE

I, NICK HOUSER, DO HEREBY CERTIFY THAT I AM A PROFESSIONAL LAND SURVEYOR HOLDING CERTIFICATION NO. 316830 AS PRESCRIBED UNDER THE LAWS OF THE STATE OF UTAH. I FURTHER CERTIFY THAT I HAVE MADE A SURVEY OF THE TRACT OF GROUND SHOWN AND THAT IT IS TRUE AND CORRECT TO THE BEST OF MY KNOWLEDGE.

Nick Houser
 NICK HOUSER # 316830
 S. Nick Houser DATE Feb. 6, 2001

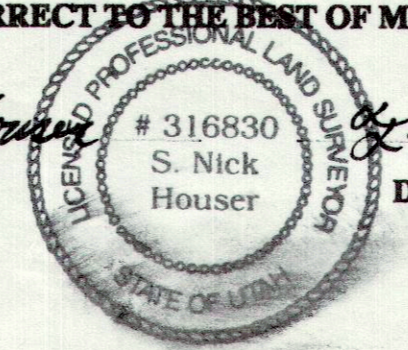

NORTH STAR LAND SURVEYING 490 NORTH EASTRIDGE RD. PRICE, UTAH 84501 PHONE (801) 637- 4918		
PROPERTY SURVEY FOR A. DAN & JACQUELYN B. OMAN 889 W. 760 N. PRICE, UTAH 84501 (435) 637-3331		
DRAWN BY: NH	APPROVED BY: NH	DRAWING NO. 117 NSPS
DATE SURVEYED: OCTOBER 2000	SCALE: 1" = 60'	