

- LEGEND**
- FOUND MONUMENT
 - SET 1/2" REBAR & CAP
 - POWER POLE
 - PROPERTY LINE
 - SECTION LINE
 - FENCE LINE
 - GRAVEL ROAD

NARRATIVE

THE PURPOSE OF THIS SURVEY IS TO LOCATE THE BOUNDARIES OF THE PROPERTY DESCRIBED AT BOOK 431, PAGE 419 IN THE OFFICIAL RECORDS OF THE CARBON COUNTY RECORDER FOR MR. NICK SAMPINOS. THE BASIS OF BEARING USED FOR THIS SURVEY IS SOUTH 00°43'46" EAST BETWEEN THE EAST QUARTER CORNER AND THE SOUTHEAST CORNER OF SECTION 9, TOWNSHIP 15 SOUTH, RANGE 10 EAST, SALT LAKE BASE AND MERIDIAN.

DESCRIPTION

A PARCEL OF LAND SITUATED IN SECTION 9, TOWNSHIP 15 SOUTH, RANGE 10 EAST, SALT LAKE BASE AND MERIDIAN, CARBON COUNTY, STATE OF UTAH, AND BEING MORE PARTICULARLY DESCRIBED AS FOLLOWS:

BEGINNING AT A POINT SOUTH 00°43'46" EAST ALONG THE SECTION LINE 19.99 FEET AND WEST 1084.42 FEET FROM THE EAST QUARTER CORNER OF SECTION 9, TOWNSHIP 15 SOUTH, RANGE 10 EAST OF THE SALT LAKE BASE AND MERIDIAN:

SAID POINT BEING ON THE SOUTHERLY LINE OF AN EXISTING COUNTY ROAD (RIDGE ROAD); THENCE SOUTH 1327.28 FEET; THENCE SOUTH 89°27'03" WEST 1670.29 FEET TO THE WESTERLY LINE OF AN EXISTING ACCESS ROAD (RIGHT OF WAY NO. 2990); THENCE ALONG SAID WESTERLY LINE NORTH 1110.74 FEET TO THE SOUTHERLY LINE OF AN EXISTING COUNTY ROAD (RIDGE ROAD); THENCE ALONG SAID LINE THE FOLLOWING THREE (3) CALLS: NORTH 83°44'55" EAST 349.07 FEET; THENCE NORTH 80°37'45" EAST 992.40 FEET; THENCE NORTH 84°31'54" EAST 345.64 FEET TO THE POINT OF BEGINNING.

CONTAINING 46.81 ACRES, MORE OR LESS.

CERTIFICATE OF SURVEY

I, BRUCE T. S. WARE, DO HEREBY CERTIFY THAT I AM A REGISTERED LAND SURVEYOR, CERTIFICATE NO. 153834 AS PRESCRIBED BY THE LAWS OF THE STATE OF UTAH. I FURTHER CERTIFY THAT I HAVE MADE A SURVEY OF THE TRACT OF GROUND SHOWN AND THAT IT IS TRUE AND CORRECT TO THE BEST OF MY KNOWLEDGE. IT DOES NOT PURPORT TO SHOW ALL EASEMENTS OF RECORD, NOR IS IT PROOF OF OWNERSHIP.

BARRY L. & TONI MILLS
2-2200

DATE: July 12, 2003

Bruce T. S. Ware, Mgr
BRUCE T. S. WARE, MGR.

VICINITY MAP
TOWNSHIP 15 SOUTH, RANGE 10 EAST, S.L.B.&M.

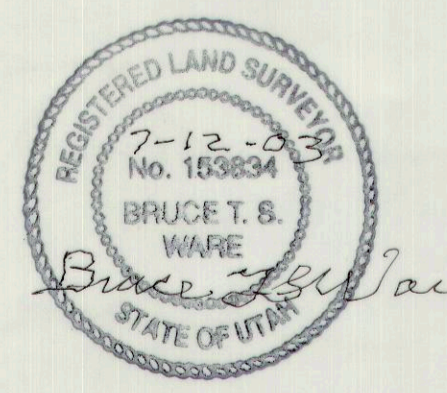
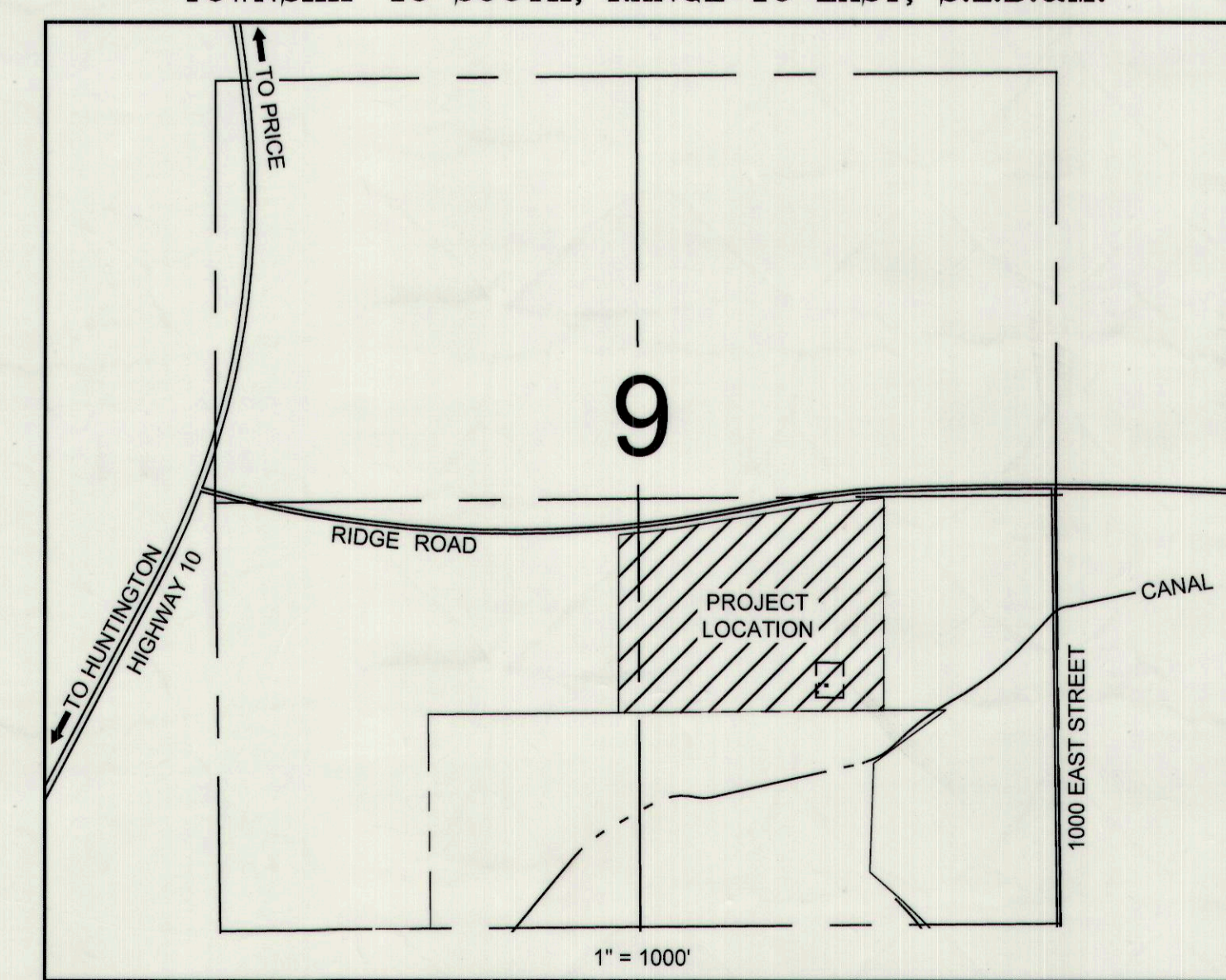

PROPERTY SURVEY FOR:

NICK SAMPINOS
 1/2 MILE EAST OF HIGHWAY 10, RIDGE ROAD
 CARBON COUNTY, UTAH
 SECTION 9, TOWNSHIP 15 S., RANGE 10 E., S. L. B. & M.

NO.	DATE	DESCRIPTION	BY
1	04-11-03	PLOTTED FOR REVIEW	M.C.W.

JOB NO.: SAMP-03-001 DATE OF SURVEY: 04-04-03

WARE SURVEYING & ENGINEERING, L.L.C.
 G.P.S. & CONVENTIONAL SURVEYING - AUTOCAD MAPPING - CIVIL ENGINEERING
 Phone: 435-637-2620 2223 North 1200 West
 Email: waresurveying@castlenet.com Helper, Utah 84526

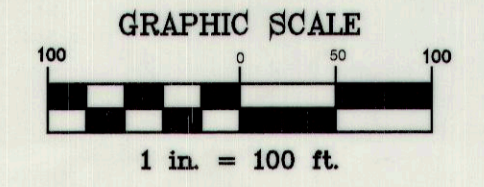

BASIS OF BEARING
S 00°43'46" E 2673.60'
(MEASURED)

SOUTHEAST CORNER,
SECTION 9, T. 15 S.,
R. 10 E., S.L.B. & M.
FOUND COUNTY CAP

STATE OF UTAH
2A-1513-S-9

NICK SAMPINOS
2-2202-4

GAS WELL &
EQUIPMENT

SAMPINOS
2-2200-1