

Basis of Bearing
 N89°16'54\"E

S 89°16'54.0\" W 247.434' N1/4 Cor Sec 32, T12S., R7E.,
 1/4 Cor Fd

Sec Cor
 NE Sec Cor
 Sec 32

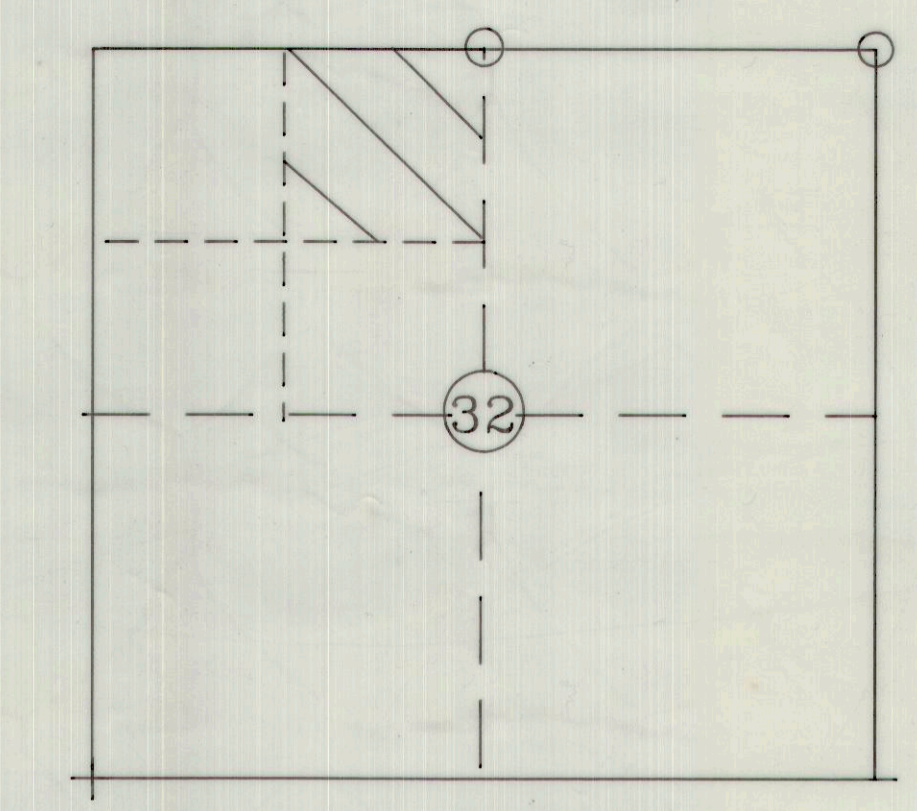

SEC 32, T12S., R7E., SLB&M

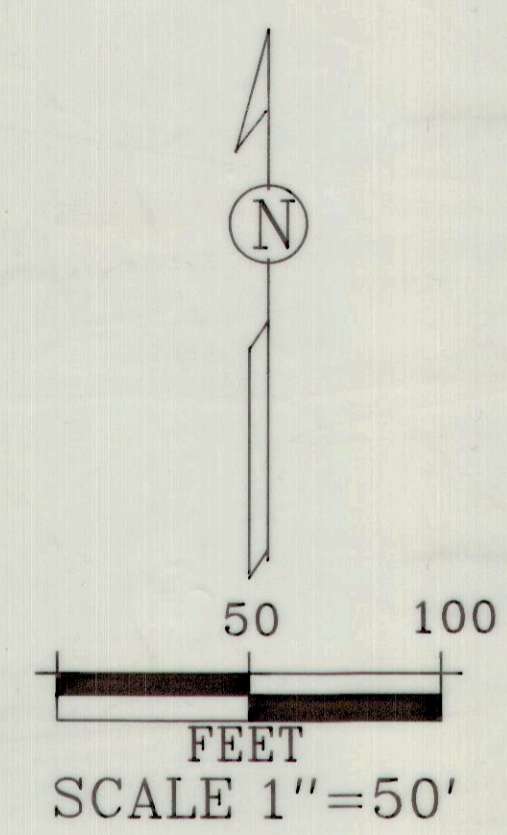

PROPERTY DESCRIPTION

The following described parcel of land is located in Carbon County, State of Utah, in the Northeast quarter of the Northwest quarter of Section 32, Township 12 South, Range 7 East, Salt Lake Base and Meridian, more specically described as follows. Basis of bearing is N89°16'54\"E between the Northeast section corner and the North one quarter corner of Section 32.

Beginning at a point located S89°16'54\"W 247.43 feet along the Section line and South 289.82 feet from the North quarter corner of Section 32, Township 12 South, Range 7 East, Salt Lake Base and Meridian, said beginning point is on an existing fence line west of the County Road, running thence West 365.00 feet, thence S28°17'37\"W 48.83 feet, thence South 556.40 feet more or less to an existing fence line, said fence line being the North boundary of the Rudman Livestock Co., thence N81°53'30\"E 62.45 feet along said fence line, thence N89°40'12\"E 290.11 feet more or less along said fence line to an existing fence line on the West side of the County Road, thence N03°30'34\"E 590.05 feet more or less along said fence line to the point of beginning. 5.00 Ac

SURVEYOR'S CERTIFICATE

I Albert J. Spensko, do hereby certify that I am a registered Land Surveyor in th State of Utah and that I hold Lic No. 146652. I further certify I have conducted this survey as directed by the owners and found the conditions to exist as noted and represents the conditions to the best of my knowledge and data of record.

Albert J. Spensko
 ALBERT J. SPENSKO Date: Oct 15, 2005

- LEGEND
- x-x Existing Fence
 - ⊕ Prop Cor/Rebar
 - RP=Ref Points
 - 1/4 & Sec Cor

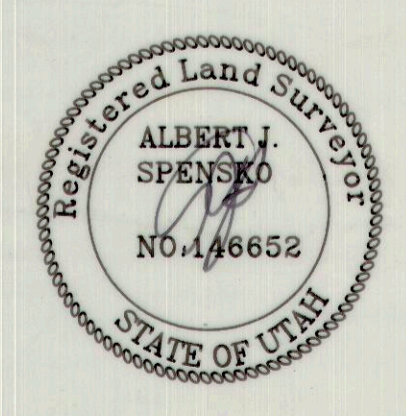

RECORD SURVEY

PREPARED FOR:	
Judy Smith & Scofield, Utah	Gayland Jones (Jones Trust)
PREPARED BY: ALBERT J. SPENSKO 12 SO 5TH AVE HELPER, UTAH 84526	
SCOFIELD, UTAH	
SCALE: 1 INCH=50 FEET	DATE: 10/15/05
DRAWN BY: AJ5	DRAW NO. JONORTH3