

181 253329 86695 41698
 Fee \$410.00 Check
 UJETT BRINLEY, Recorder
 For: EVAN HANSEN

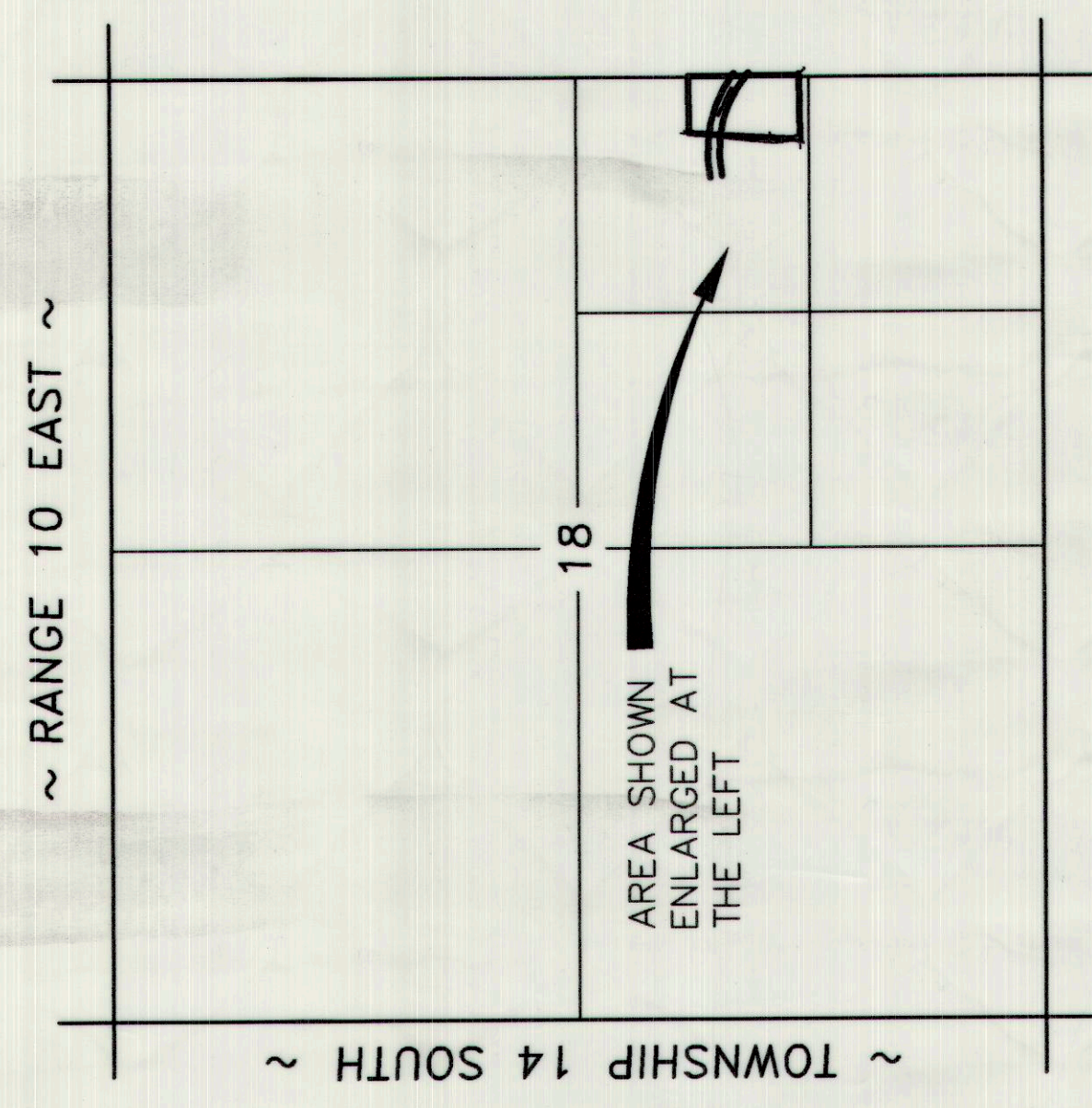

VICINITY MAP
 SCALE: 1" = 1000'

- LEGEND
- INDICATES 5/8" x 24" REBAR SET W/ CAP
 - SECTION CORNER
 - FENCE LINE
 - PROPERTY LINE
 - SECTION LINE
 - - - - - EDGE OF ASPHALT

NARRATIVE

THE PURPOSE OF THIS SURVEY WAS TO USE THE DISTANCES RECORDED IN DEED FOR HEUGLY AND DEED FOR BALLARD TO CORRECT THE DISTANCES RECORDED IN THE CARBON COUNTY RECORDER'S OFFICE. THE RECORDED DISTANCES STARTED AT THE FENCE LINE ON THE WEST SIDE OF "FAIRGROUNDS ROAD" INSTEAD OF USING THE SECTION LINE AND 18TH CORNER FOR CONTROL.

ENGINEER'S CERTIFICATE

I, EVAN E. HANSEN, DO HEREBY CERTIFY THAT I AM A REGISTERED LAND SURVEYOR AND PROFESSIONAL ENGINEER HOLDING CERTIFICATE NO. 449566 IN THE STATE OF UTAH. I HAVE MADE A SURVEY OF THE TRACT OF GROUND SHOWN ON THIS DRAWING AND THAT IT IS TRUE AND CORRECT TO THE BEST OF MY KNOWLEDGE.

Evan E. Hansen
 EVAN E. HANSEN
 DATE: FEB 16, 2007

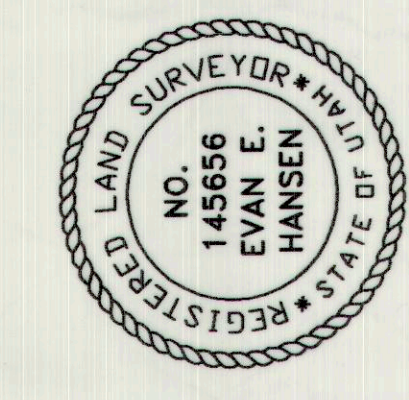

NE 1/4 SE 1/4 SECTION 18, T 14 S, R 10 E, S.L.B. & M.
Empire Engineering & Land Surveying
 1665 E. Sogwood Rd. Price, Utah 84501 Phone (801) 637-5748
 Property Survey For:
HEUGLY AND BALLARD FENCE LINE (BOUNDARY)
 Drawn By: EEH Approved By: EEH Drawing No.: EEPS-372
 Date: 1/30/07 Scale: 1" = 50'

REVISED FEB. 16, 2007

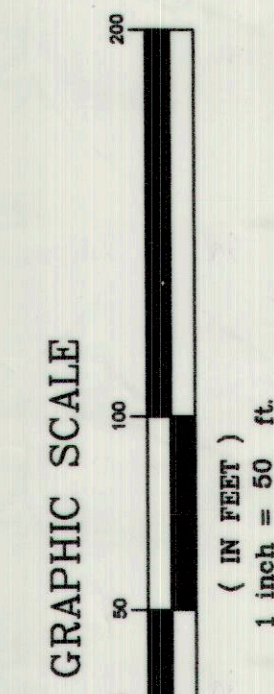

DEED FOR BALLARD

A PARCEL OF LAND LOCATED IN CARBON COUNTY, STATE OF UTAH, WHICH IS IN THE EAST HALF OF THE SOUTHEAST QUARTER OF SECTION 18, TOWNSHIP 14 SOUTH, RANGE 10 EAST, SALT LAKE AND MERIDIAN, AND RUNNING THENCE NORTH 0°25'58" WEST ALONG AN EXISTING FENCE LINE LOCATED ON THE WEST SIDE OF FAIRGROUNDS ROAD, 185.24 FEET TO AN EXISTING FENCE LINE TO A POINT WHICH IS 0.50 FEET WEST OF A PROJECTED LINE ON THE WEST SIDE OF AN EXISTING NORTH-SOUTH CURB; THENCE SOUTH 3°53'22" WEST TO AN EXISTING EAST-WEST FENCE LINE, 63.32 FEET TO AN EXISTING SOUTHWESTLY EXISTING FENCE LINE, 365.34 FEET TO THE POINT OF BEGINNING.

CONTAINS 4.82 ACRES LESS THE RIGHT-OF-WAY AREA FOR A COUNTY ROAD (WESTWOOD BOULEVARD).

DEED FOR HEUGLY

A PARCEL OF LAND LOCATED IN CARBON COUNTY, STATE OF UTAH, WHICH IS IN THE EAST HALF OF THE SOUTHEAST QUARTER OF SECTION 18, TOWNSHIP 14 SOUTH, RANGE 10 EAST, SALT LAKE AND MERIDIAN, AND RUNNING THENCE NORTH 0°25'58" WEST, BETWEEN THE SOUTHEAST CORNER AND THE EAST QUARTER CORNER OF SAID SECTION 18 USED AS THE BASIS OF BEARINGS.

BEGINNING AT A POINT IN AN EXISTING FENCE LINE WHICH IS LOCATED 381.42 FEET SOUTH 88°29'56" WEST FROM THE SOUTHEAST CORNER OF THE NORTHEAST QUARTER OF THE SOUTHEAST QUARTER OF SECTION 18, TOWNSHIP 14 SOUTH, RANGE 10 EAST, SALT LAKE AND MERIDIAN, AND RUNNING THENCE NORTH 0°25'58" WEST ALONG AN EXISTING FENCE LINE TO A POINT ON AN OBLITERATED EAST-WEST FENCE LINE, 632.81 FEET (SAID POINT IS THE INTERSECTION OF AN OBLITERATED EAST-WEST FENCE LINE AND A PROJECTED LINE ON THE WEST SIDE OF AN EXISTING NORTH-SOUTH CURB); THENCE SOUTH 88°29'56" WEST, 9.02 FEET TO AN EXISTING FENCE LINE; THENCE SOUTH 6°26'19" WEST ALONG AN EXISTING FENCE LINE, 116.34 FEET TO THE NORTH SIDE OF WESTWOOD BOULEVARD; THENCE SOUTH 81°10'15" WEST CROSSING WESTWOOD BOULEVARD TO A POINT ON THE SOUTH SIDE OF WESTWOOD BOULEVARD, 126.53 FEET; THENCE SOUTH 42°50'17" EAST TO AN EXISTING FENCE CORNER, 140.37 FEET; THENCE NORTH 88°51'17" EAST ALONG AN EXISTING FENCE LINE, 376 FEET TO THE POINT OF BEGINNING.

CONTAINS 0.26 ACRES LESS THE RIGHT-OF-WAY AREA FOR A COUNTY ROAD (WESTWOOD BOULEVARD).

SOUTHEAST CORNER
 NE 1/4 OF SE 1/4
 SECTION 18
 T 14 S, R 10 E
 S.L.B. & M.
 ~19.5 FT.
 ~16.24'

SOUTHWEST CORNER
 NE 1/4 OF SE 1/4
 SECTION 18
 T 14 S, R 10 E
 S.L.B. & M.
 FORTY ACRE LINE
 140.37'