

FOR 124950A IN 0527
PAGE 17-20
FILED 05/27/07
G.L.H. SR. CHECK
G.L.H. SR. CHECK
CARBON COUNTY COMMISSION
FORT LEWIS HANSEN

PROPERTY SURVEY FOR:
PRICE RIVER WATER IMPROVEMENT DISTRICT

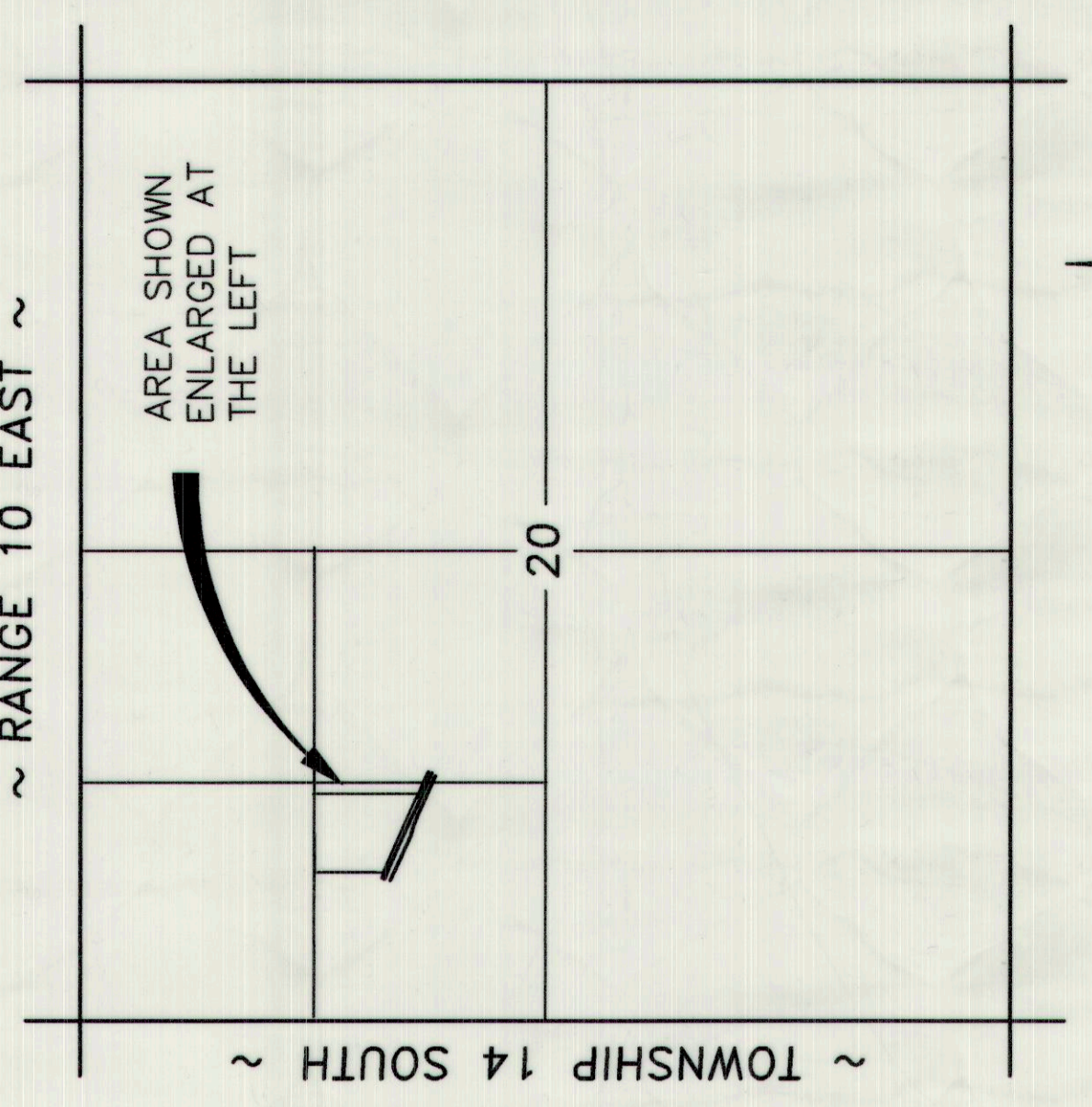

VICINITY MAP
SCALE: 1" = 1000'

LEGEND
 ○ INDICATES 5/8" x 24" REBAR SET W/ CAP
 ⊕ SECTION CORNER
 --- FENCE LINE
 - - - PROPERTY LINE
 - - - SECTION LINE

PURPOSE
THE PURPOSE OF THIS SURVEY WAS TO STAKE ON THE GROUND THE NORTH LINE OF THE SOUTHWEST QUARTER OF SECTION 20, T14S, R10E, S.L.B. & M., LOCATED EAST OF THE PRICE RIVER WATER IMPROVEMENT DISTRICT PROPERTY AND THE NORTH RIGHT-OF-WAY LINE OF A COUNTY ROAD OWNED BY CARBON COUNTY.

NARRATIVE
IT IS UNCLEAR WHAT THE COUNTY WANTS TO RESERVE FOR A ROAD RIGHT OF WAY WIDTH, THE RIGHT OF WAY WIDTH EAST OF THIS AREA IS 100 FEET WIDE, ALSO, THIS ROAD IS ONE OF THE MAIN ROUTES TO THE PRICE RIVER WATER IMPROVEMENT DISTRICT. THE WIDTH OF CENTER LINE OF THE EXISTING ROAD MAY NOT BE UNREASONABLE.

ENGINEER'S CERTIFICATE

I, EVAN E. HANSEN, DO HEREBY CERTIFY THAT I AM A REGISTERED LAND SURVEYOR AND PROFESSIONAL ENGINEER HOLDING CERTIFICATE NO. 145656 AS PRESCRIBED UNDER THE LAWS OF THE STATE OF UTAH. I FURTHER CERTIFY THAT I HAVE MADE A SURVEY OF THE TRACT OF GROUND SHOWN AND THAT IT IS TRUE AND CORRECT TO THE BEST OF MY KNOWLEDGE.

EVAN E. HANSEN
DATE: 06/11/2007

SURVEYED DESCRIPTION

A PARCEL OF LAND LOCATED IN CARBON COUNTY, STATE OF UTAH, WHICH IS IN THE SOUTHWEST QUARTER OF THE NORTHWEST QUARTER OF SECTION 20, TOWNSHIP 14 SOUTH, RANGE 10 EAST, SALT LAKE BASE AND MERIDIAN, BEING FURTHER DESCRIBED AS FOLLOWS WITH A BEARING OF NORTH 01°03'1" WEST, 385.23' WEST BETWEEN THE SOUTHWEST CORNER AND THE NORTHWEST CORNER OF SAID SECTION 20 USED AS THE BASIS OF BEARING.

BEGINNING AT A POINT WHICH IS LOCATED 3866.04 FEET NORTH 01°03'1" WEST ALONG THE SECTION LINE AND 827.30 FEET ALONG THE NORTH LINE OF THE SOUTHWEST QUARTER OF THE NORTHWEST QUARTER NORTH 88°50'03" EAST FROM THE POINT OF BEGINNING TO THE POINT OF BEGINNING; THENCE NORTH 88°50'03" EAST ALONG THE SECTION LINE 440.81 FEET TO THE POINT OF BEGINNING; THENCE NORTH 88°50'03" EAST ALONG THE NORTH RIGHT-OF-WAY LINE OF A COUNTY ROAD, 485.15 FEET TO THE POINT OF BEGINNING; THENCE NORTH 65°56'24" WEST, 485.15 FEET ALONG THE NORTH RIGHT-OF-WAY LINE OF A COUNTY ROAD; THENCE NORTH 01°03'1" WEST ALONG THE EAST LINE OF A PARCEL OF LAND OWNED BY PRICE RIVER WATER IMPROVEMENT DISTRICT, 385.23 FEET TO THE POINT OF BEGINNING.

CONTAINS 4.95 ACRES, MORE OR LESS.

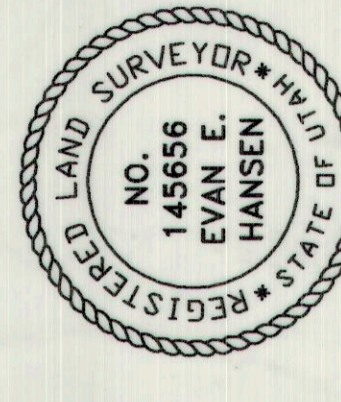

SW1/4 NW1/4 SECTION 20, T 14 S, R 10 E, S.L.B. & M.

Empire Engineering & Land Surveying
1665 E. Sagewood Rd. Price, Utah 84501 Phone (801) 637-5748

Property Survey For:
PRICE RIVER WATER IMPROVEMENT DISTRICT

Drawn By: EEH
Approved By: EEH
Date: 06/11/2007
Scale: 1" = 50'

Drawing No. EEPS-375