

PURPOSE FOR THE SURVEY

The purpose of the survey is to stake the corners of Parcel No. 2-828.

SURVEYOR'S CERTIFICATE

I, BENJAMIN A. GRIMES, DO HEREBY CERTIFY THAT I AM A REGISTERED LAND SURVEYOR HOLDING LICENSE NUMBER 167246 IN ACCORDANCE WITH UTAH CODE TITLE 58, CHAPTER 22, PROFESSIONAL ENGINEER AND PROFESSIONAL SURVEYOR LICENSING ACT, AND THAT THIS PLAT HAS BEEN PREPARED BY ME ON BEHALF OF THE OWNERS, AND THAT THIS PLAT REPRESENTS TO THE BEST OF MY KNOWLEDGE THE EXISTING PROPERTY AS IT EXISTS ON THIS DATE.

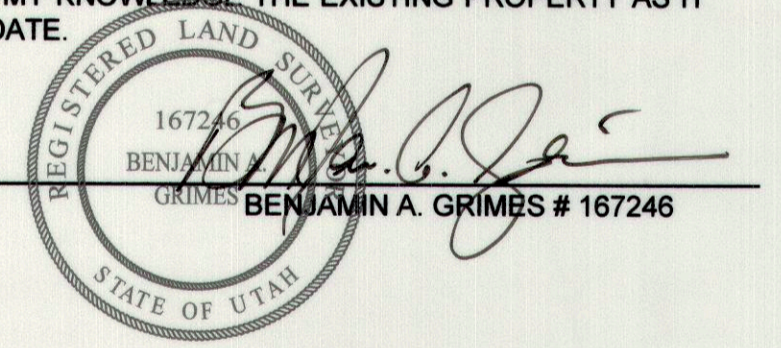

LEGAL DESCRIPTION

Beginning at a point which is located S0°15'28"E 725.94 feet along the center line and East 1028.44 feet from the North Quarter corner of Section 7, Township 14 South, Range 10 East, Salt Lake Base & Meridian, said point being on the east right-of-way line of the Union Pacific Railroad property; thence N48°50'48"E 115.04 feet; thence S50°12'12"E 208.57 feet; thence S48°50'48"W 138.05 feet along the north line parcel Number 2-829 to the east line of said Union Pacific Railroad property; thence along said east right-of-way line of said Union Pacific Railroad property N44°09'12"W 208.57 feet to the point of beginning.

Containing 0.60 acres.

Together with all improvements thereon and subject to any easements, rights-of-way and restrictions of record.

Basis of bearing is N00°15'28"W between the South Quarter Corner and the North Quarter Corner of Section 7, Township 14 South, Range 10 East.

NOTES

1. THE DESCRIPTION IN THE DEED IS NOT CORRECT. THE ACTUAL DEEDED LOCATION ON-THE-GROUND WAS DETERMINED BY OCCUPATION EVIDENCED BY FENCES IN THE AREA, AND THE ADJOINING DEEDS.

LEGEND

- ◆ = SECTION MONUMENT FOUND
- = PROPERTY CORNER SET - PLS #167246
- = SET MAG NAIL IN PAVEMENT

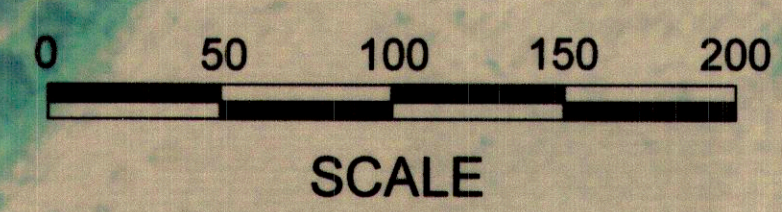
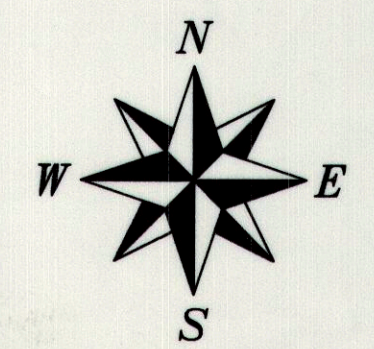

| | | | | | | | | | | |
|----------|---------|-----|--|------|--|--|--|-----------|----|-------|
| DESIGNED | B.G. | 3 | | | | | | | | SCALE |
| DRAFTED | B.G. | 2 | | | | | | | | |
| CHECKED | | 1 | | | | | | | | |
| DATE | 1-25-10 | NO. | | DATE | | | | REVISIONS | BY | APVD. |