

VICINITY MAP

Ent 806576 Bk 726 Pg 432
 Date: 26-JUL-2010 9:21:00AM
 Fee: \$15.00 Check
 Filed By: VB
 VIKKI BARNETT, Recorder
 CARSON COUNTY CORPORATION
 For: DEBBIE KOBE

PARCEL No. 1 RECORD DESCRIPTION

BEGINNING AT THE NORTHEAST CORNER OF LOT 3, SECTION 31, TOWNSHIP 13 SOUTH, RANGE 10 EAST, SALT LAKE BASE AND MERIDIAN; THENCE WEST 104 FEET; THENCE SOUTH 288.00 FEET; THENCE EAST 104 FEET; THENCE NORTH 288 FEET TO THE POINT OF BEGINNING.

PARCEL No. 1 SURVEYED BOUNDARY DESCRIPTION

BEGINNING AT A POINT WHICH LIES NORTH 89°05'00" EAST 1217.58 FEET ALONG THE QUARTER SECTION LINE FROM THE WEST 1/4 CORNER OF SECTION 31, TOWNSHIP 13 SOUTH, RANGE 10 EAST, SALT LAKE BASE AND MERIDIAN; AND RUNNING THENCE SOUTH 0°07'48" EAST 288.00 FEET ALONG A FENCE TO A FENCE CORNER; THENCE NORTH 89°05'00" EAST 104.00 FEET ALONG A FENCE TO A FENCE INTERSECTION; THENCE NORTH 0°07'48" WEST 288.00 FEET TO THE QUARTER SECTION LINE; THENCE SOUTH 89°05'00" WEST 104.00 FEET ALONG THE QUARTER SECTION LINE TO THE POINT OF BEGINNING. (AREA = 0.50 ACRES)

PARCEL No. 2 RECORD DESCRIPTION

BEGINNING AT A POINT 125 FEET EAST OF THE NORTHWEST CORNER OF THE NORTHEAST 1/4 OF THE SOUTHWEST 1/4 OF SECTION 31, TOWNSHIP 13 SOUTH, RANGE 10 EAST, SALT LAKE BASE AND MERIDIAN; THENCE SOUTH 417 FEET; THENCE EAST 106 FEET; THENCE NORTH 417 FEET; THENCE WEST 106 FEET TO THE POINT OF BEGINNING.

LESS ANY PORTION THAT MAY LIE WITHIN THE COUNTY ROAD.

PARCEL No. 2 SURVEYED BOUNDARY DESCRIPTION

BEGINNING AT A POINT WHICH LIES NORTH 89°05'00" EAST 1448.83 FEET ALONG THE QUARTER SECTION LINE FROM THE WEST 1/4 CORNER OF SECTION 31, TOWNSHIP 13 SOUTH, RANGE 10 EAST, SALT LAKE BASE AND MERIDIAN; AND RUNNING THENCE SOUTH 0°55'00" EAST 417.00 FEET; THENCE NORTH 89°05'00" EAST 113.51 FEET TO AN EXISTING FENCE; THENCE NORTH 0°22'19" WEST 417.02 FEET ALONG SAID FENCE AND ITS EXTENSION TO THE QUARTER SECTION LINE; THENCE SOUTH 89°05'00" WEST 117.48 FEET ALONG THE QUARTER SECTION LINE TO THE POINT OF BEGINNING. (AREA = 1.11 ACRES)

NARRATIVE:

BASIS OF BEARING IS UTAH COORDINATE BEARINGS, CENTRAL ZONE. (N 0°23'21" BETWEEN THE WEST 1/4 CORNER AND THE NORTHWEST CORNER OF SECTION 31, TOWNSHIP 13 SOUTH, RANGE 10 EAST, SLB&M.)

PURPOSE OF SURVEY IS TO COMPARE DEEDED PROPERTY AGAINST EXISTING PROPERTY IN ACTUAL POSSESSION AND PREPARE A SURVEYED BOUNDARY DESCRIPTION.

SURVEYORS CERTIFICATE:

I, BARRY L. PRETTYMAN, A LICENSED SURVEYOR HOLDING CERTIFICATE No 166406, DO HEREBY CERTIFY THAT THE PLAT SHOWN HEREON WAS PREPARED FROM A FIELD SURVEY MADE UNDER MY DIRECTION AND CORRECTLY SHOWS THE DIMENSIONS AND MONUMENTS OF THE ABOVE DESCRIBED PARCEL OF LAND TO THE BEST OF MY KNOWLEDGE AND BELIEF.

Barry L. Prettyman DATE: May 28, 2010
 BARRY L. PRETTYMAN

LEGEND:

- = 5/8" REBAR WITH ORANGE CAP MARKED RLS 166406.
- = KOBE DEED LINES
- - - - = ADJACENT LAND OWNER DEED LINES
- × × × = EXISTING FENCES

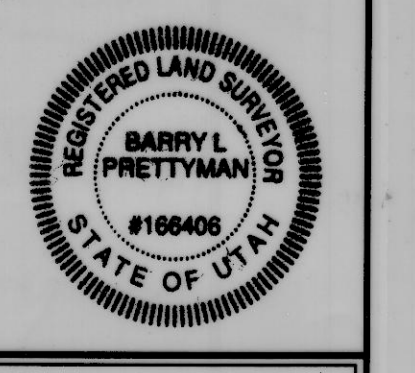

NOTE:

MANY OF THE DEED DESCRIPTIONS INVOLVED IN THIS SURVEY ARE WRITTEN FROM AN INTERIOR 1/16TH CORNER AND THEY DO NOT MATCH THE EXISTING LINES OF POSSESSION. THE "SURVEYED BOUNDARY" DESCRIPTIONS AT THE RIGHT DESCRIBE THE ACTUAL LINES OF POSSESSION.



SCALE: 1" = 30'

DAVID KOBE
RECORD OF SURVEY PLAT

COLE SURVEYING AND ENGINEERING
251 WEST SR 198, SU 1E 42 - SALEM, UTAH 84653 - (801) 423-1848

DRAWN BY: B.L. PRETTYMAN	APPROVED BY: B.L. PRETTYMAN	DRAWING No.:
SCALE: 1" = 30'	DATE: MAY 28, 2010	1 of 1

#507