

A.L.T.A./A.C.S.M. LAND TITLE SURVEY FOR  
**PACIFICORP**  
 (UTAH POWER & LIGHT COMPANY)  
 COLTON WELLS 1 & 2  
 UTAH COUNTY, UTAH  
 LOCATED IN THE S1/2 NW1/4 & SW1/4 SE1/4 OF SECTION 22, T. 11 S., R. 8 E., S.L.B.&M.  
 SHEET 3 OF 3

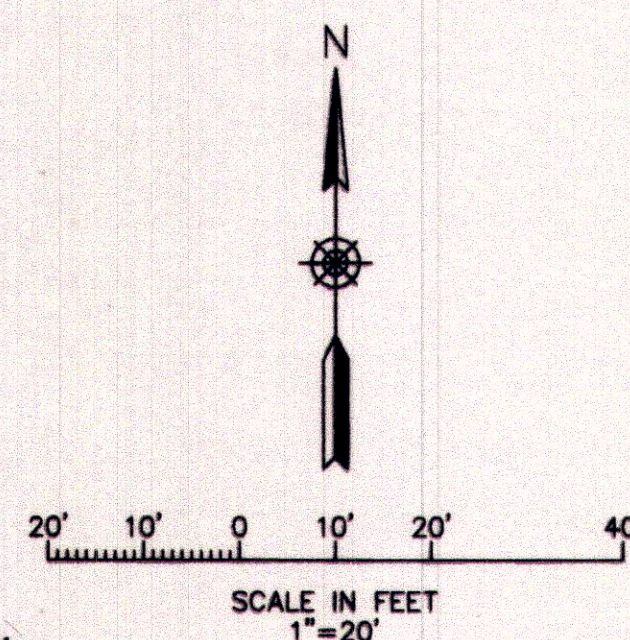

**RECORD (DEED) DESCRIPTIONS:**

**SURVEY PARCEL (ENTRY #6226:1953)**  
 A TRACT OF LAND IN THE SOUTH ONE-HALF OF THE NORTHWEST QUARTER OF SECTION 22, TOWNSHIP 11 SOUTH, RANGE 8 EAST, S.L.B.& M., DESCRIBED AS FOLLOWS:

BEGINNING AT A POINT 882.41 FEET NORTH AND 1341.33 FEET EAST FROM THE WEST QUARTER CORNER OF SAID SECTION 22, THENCE RUNNING N. 39° 56' E. 210 FEET, THENCE N. 48° 12' W. 210 FEET, THENCE S. 39° 56' W. 210 FEET, THENCE S. 48° 12' E. 210 FEET TO BEGINNING, CONTAINING 1.01 ACRES.

**LEASE AREA (ENTRY #2601:1953)**  
 A TRACT OF LAND IN THE SOUTHWEST QUARTER OF THE SOUTHEAST QUARTER OF SECTION 22, T. 11 S., R. 8 E., S.L.B.& M., DESCRIBED AS FOLLOWS:

BEGINNING AT A POINT 903.6 FEET NORTH AND 486.69 FEET EAST FROM THE SOUTH QUARTER CORNER OF SAID SECTION 22, THENCE RUNNING NORTH 208.71, THENCE EAST 208.71 FEET, THENCE SOUTH 208.71 FEET, THENCE WEST 208.71 FEET TO BEGINNING, CONTAINING ONE ACRE.

**SURVEY DESCRIPTIONS:**

**SURVEY PARCEL**  
 A TRACT OF LAND IN THE SOUTH ONE-HALF OF THE NORTHWEST QUARTER OF SECTION 22, TOWNSHIP 11 SOUTH, RANGE 8 EAST, S.L.B.& M., DESCRIBED AS FOLLOWS:

BEGINNING AT A POINT 869.49 FEET NORTH AND 1347.89 FEET EAST FROM THE WEST QUARTER CORNER OF SAID SECTION 22, RUNNING THENCE N. 39° 56' 00" E. 210.00 FEET; THENCE N. 48° 12' 00" W. 210.00 FEET, THENCE S. 39° 56' 00" W. 210.00 FEET, THENCE S. 48° 12' 00" E. 210.00 FEET TO THE POINT OF BEGINNING, CONTAINING 1.01 ACRES.

**LEASE AREA**  
 (SAME AS RECORD - SEE ABOVE)

**SURVEYOR'S CERTIFICATE:**

TO PACIFICORP, UTAH POWER & LIGHT COMPANY, AND SOUTH EASTERN UTAH TITLE COMPANY:

THIS IS TO CERTIFY THAT THIS MAP OR PLAT AND THE SURVEY ON WHICH IT IS BASED WERE MADE IN ACCORDANCE WITH THE 2011 MINIMUM STANDARD DETAIL REQUIREMENTS FOR ALTA/ACSM LAND TITLE SURVEYS, JOINTLY ESTABLISHED AND ADOPTED BY ALTA AND NSPS, AND INCLUDES ITEMS 1-4, 7, 11(b), AND 13 OF TABLE A THEREOF. THE FIELD WORK WAS COMPLETED ON JANUARY 29, 2014.

DATE OF PLAT: FEBRUARY 14, 2014

G. THOMAS TORGERSEN, PLS #8205593  
 TORGERSEN ENGINEERING, INC.  
 180 N. 100 E. SUITE E, RICHFIELD, UT 84701  
 (435) 893-0081  
 Tom@TorgEng.com

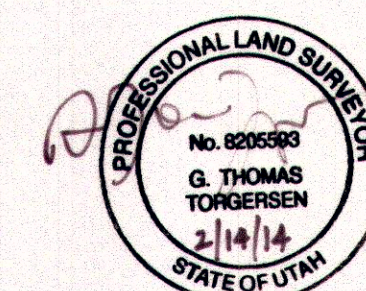

**TORGERSEN ENGINEERING**  
 180 N. 100 E. SUITE E  
 RICHFIELD, UTAH 84701  
 OFFICE (435) 893-0081  
 FAX (435) 896-8797

A.L.T.A./A.C.S.M. LAND TITLE SURVEY FOR  
**PACIFICORP**  
 (UTAH POWER & LIGHT COMPANY)  
 COLTON WELLS 1 & 2  
 UTAH COUNTY, UTAH

LOCATED IN THE S1/2 NW1/4 & SW1/4 SE1/4 OF SECTION 22, T. 11 S., R. 8 E., S.L.B.&M.

SURVEY BY: GTT	DRAWING BY: GTT	CHECKED BY: RKT
DATE: 1/29/2014	DATE: 2/14/2014	DATE: 2/14/2014

SHEET 3 OF 3	1312RMP-CP_S22
--------------	----------------

BOUNDARY & SITE FEATURES VIEW  
 SURVEY PARCEL

JOHN HOUSTON, TRUSTEE  
 33:056:0005  
 ENTRY #5246:2001

JOHN HOUSTON, TRUSTEE  
 33:056:0025  
 ENTRY #5246:2001

UTAH POWER & LIGHT COMPANY  
 33:056:0017  
 ENTRY #6226:1953

JOHN HOUSTON, TRUSTEE  
 33:056:0006  
 ENTRY #5246:2001

