

DESCRIPTION - NORTH PORTION

A PARCEL OF LAND LOCATED IN PRICE, CARBON COUNTY, STATE OF UTAH, WHICH IS IN THE WEST HALF OF THE SOUTHEAST QUARTER OF SECTION 22, TOWNSHIP 14 SOUTH, RANGE 10 EAST, SALT LAKE BASE AND MERIDIAN, BEING FURTHER DESCRIBED AS FOLLOWS WITH A BEARING OF NORTH 89°57'52" EAST BETWEEN THE SOUTH QUARTER CORNER AND THE SOUTHEAST CORNER OF SAID SECTION 22 USED AS THE BASIS OF BEARING, WHICH IS THE UTAH STATE PLANE COORDINATE SYSTEM AS ESTABLISHED BY THE CARBON COUNTY SURVEYORS OFFICE.

AN EASEMENT FOR ROAD AND WATERLINE PURPOSES, APPROXIMATELY 30.00 FEET WIDE AS DESCRIBED BELOW.

BEGINNING AT A POINT WHICH IS LOCATED 217.99 FEET NORTH AND 358.19 FEET WEST FROM THE INTERSECTION OF AN EAST - WEST AND A NORTH - SOUTH FENCE LINE, SAID INTERSECTION BEING THE SOUTHEAST CORNER OF THE NORTHWEST QUARTER OF THE SOUTHEAST QUARTER OF SECTION 22, TOWNSHIP 14 SOUTH, RANGE 10 EAST, SALT LAKE BASE AND MERIDIAN, THE POINT OF BEGINNING IS ALSO LOCATED NORTH 30°52'45" EAST, 1930.41 FEET FROM THE SOUTH QUARTER CORNER (BRASS CAP) OF SAID SECTION 22 AND RUNNING THENCE DUE WEST, 28.69 FEET; THENCE NORTH 01°04'23" WEST, 406.06 FEET; THENCE DUE EAST, 30.40 FEET; THENCE SOUTH 00° 49'59" EAST, 406.03 FEET TO THE POINT OF BEGINNING.

CONTAINS 0.275 ACRES, MORE OR LESS.

**DESCRIPTION CROSSING
TED K. & MARGARET WELLS**

A PARCEL OF LAND LOCATED IN PRICE, CARBON COUNTY, STATE OF UTAH, WHICH IS IN THE WEST HALF OF THE SOUTHEAST QUARTER OF SECTION 22, TOWNSHIP 14 SOUTH, RANGE 10 EAST, SALT LAKE BASE AND MERIDIAN, BEING FURTHER DESCRIBED AS FOLLOWS WITH A BEARING OF NORTH 89°57'52" EAST BETWEEN THE SOUTH QUARTER CORNER AND THE SOUTHEAST CORNER OF SAID SECTION 22 USED AS THE BASIS OF BEARING, WHICH IS THE UTAH STATE PLANE COORDINATE SYSTEM AS ESTABLISHED BY THE CARBON COUNTY SURVEYORS OFFICE.

AN EASEMENT FOR ROAD AND WATERLINE PURPOSES, 60.00 FEET WIDE AS DESCRIBED BELOW.

BEGINNING AT A POINT WHICH IS LOCATED 217.99 FEET NORTH AND 358.19 FEET WEST FROM THE INTERSECTION OF AN EAST - WEST AND A NORTH - SOUTH FENCE LINE, SAID INTERSECTION BEING THE SOUTHEAST CORNER OF THE NORTHWEST QUARTER OF THE SOUTHEAST QUARTER OF SECTION 22, TOWNSHIP 14 SOUTH, RANGE 10 EAST, SALT LAKE BASE AND MERIDIAN, THE POINT OF BEGINNING IS ALSO LOCATED NORTH 30°52'45" EAST, 1930.41 FEET FROM THE SOUTH QUARTER CORNER (BRASS CAP) OF SAID SECTION 22 AND RUNNING THENCE SOUTH 0°49'59" EAST, 454.55 FEET TO THE GRANTORS SOUTH PROPERTY LINE; THENCE SOUTH 89°05'14" WEST, 60.00 FEET ALONG THE GRANTORS SOUTH PROPERTY LINE; THENCE NORTH 0°49'59" WEST 455.50 FEET TO THE GRANTORS NORTH PROPERTY LINE; THENCE DUE EAST, 60.01 FEET ALONG THE GRANTORS NORTH PROPERTY LINE TO THE POINT OF BEGINNING.

CONTAINS 0.63 ACRES, MORE OR LESS.

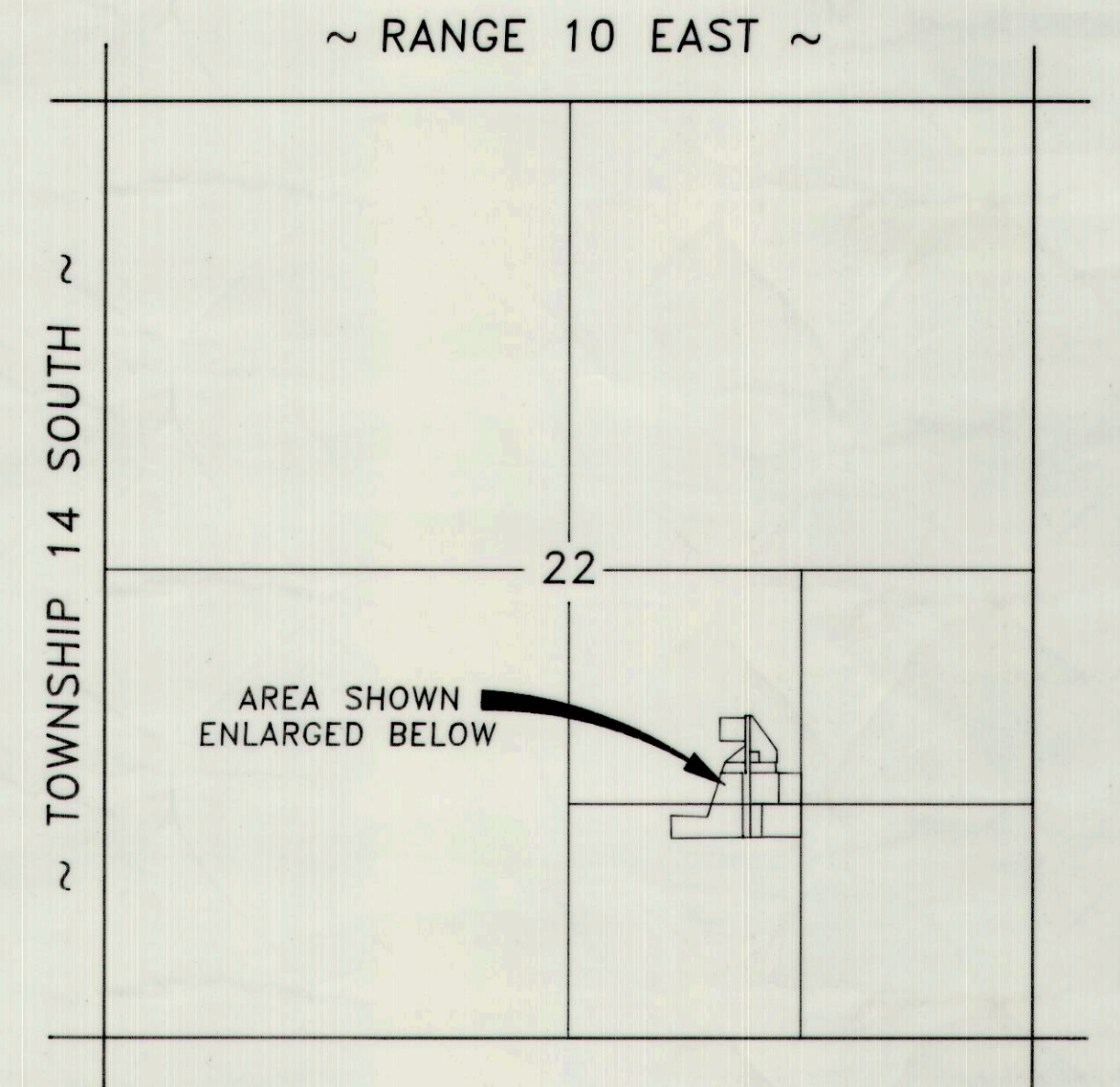
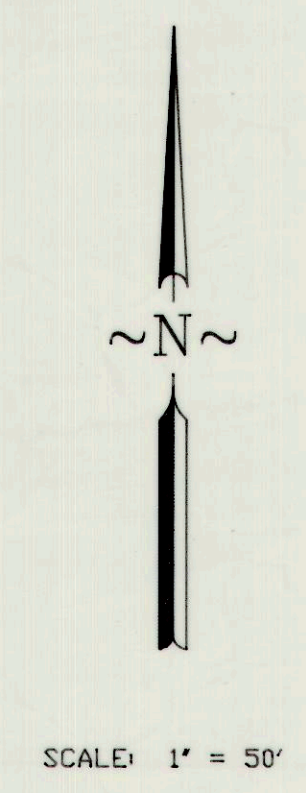
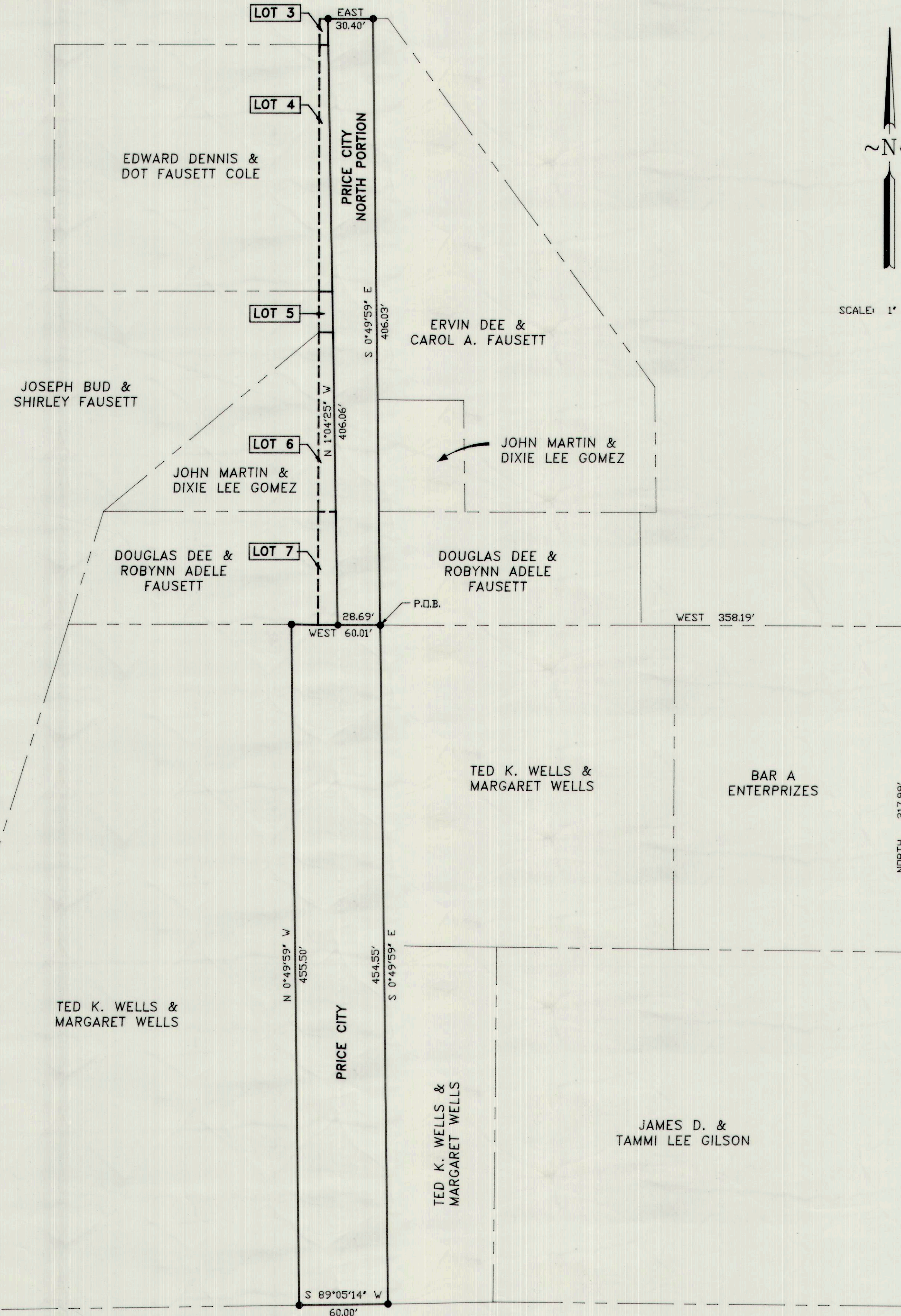

VICINITY MAP

SCALE: 1" = 1000'

LEGEND

- INDICATES 5/8" x 24" REBAR SET W/ CAP
- △ CENTER SE1/4 CORNER
- PROPERTY LINE
- ROAD EASEMENT LINE
- - - LOT EASEMENT LINE

ENGINEER'S CERTIFICATE

I, EVAN E. HANSEN, DO HEREBY CERTIFY THAT I AM A REGISTERED LAND SURVEYOR AND PROFESSIONAL ENGINEER HOLDING CERTIFICATES NO. 3115 AND NO. 3354 AS PRESCRIBED UNDER THE LAWS OF THE STATE OF UTAH. I FURTHER CERTIFY THAT I HAVE MADE A SURVEY OF THE TRACT OF GROUND SHOWN AND THAT IT IS TRUE AND CORRECT TO THE BEST OF MY KNOWLEDGE.

Evan E. Hansen
EVAN E. HANSEN DATE JUNE 10, 1994

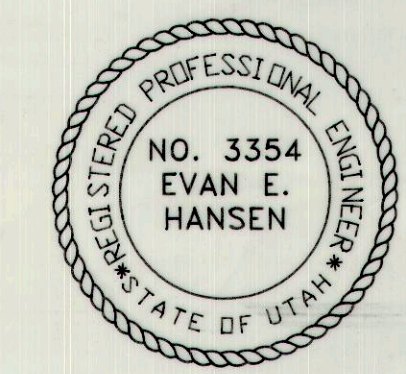
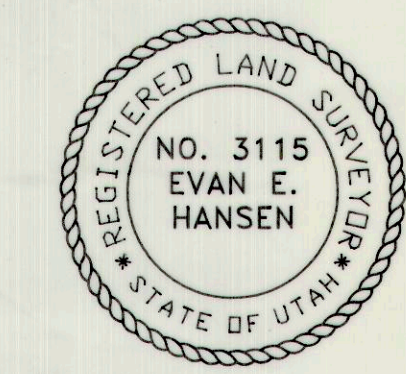

E1/2 SE1/4 SEC. 22, T 14 S, R 10 E, S.L.B.& M.

Empire Engineering & Land Surveying

1665 E. Sagewood Rd. Price, Utah 84501 Phone (801) 637-7498

Property Survey For:
PRICE CITY - FAUSETT LANE

Drawn By: THK	Approved By: EEH	Approved By: EEPS-247 D
Date: 6-10-94	Scale: 1" = 50'	