

- LEGEND**
- Property line
  - x x x Fence
  - Overhead power
  - Overhead cable
  - Gas
  - Water
  - Sewer
- CONTOUR INTERVAL = 1 FOOT
- Vertical Datum - GPS observations using PUC1 published data with Geoid 03 vertical adjustment.
- Elevations are shown on selected property corner monuments for reference.
- Note: PUC1 GPS control point was abandoned during the course of this survey and replaced with PUC2 near Airport Road in Price. Selected survey control on this project has been checked using PUC2 and verified as accurate.

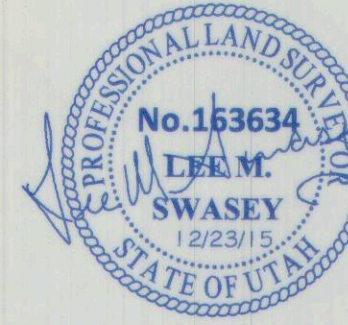

**COMMITMENT FOR TITLE INSURANCE  
SCHEDULE B PART II (cont.)**

18. Project Ground Lease Agreement dated March 1, 2008, by and between MUNICIPAL BUILDING AUTHORITY OF CARBON COUNTY, UTAH, as lessee, a nonprofit corporation organized under the laws of the State of Utah, and CARBON COUNTY, UTAH, as lessor, a political subdivision and body politic of the State of Utah, recorded March 21, 2008, as Entry No. 128285, in Book 668, at Page 394, of Official Records. Amendment thereto, dated April 1, 2014, and recorded April 25, 2014, as Entry No. 824124, in Book 821, at Page 121, of Official Records. (NOTE: Affects a portion of said land and other lands.)

See Item 21 below.

19. Substitute Collateral Ground Lease Agreement dated March 1, 2008, by and between MUNICIPAL BUILDING AUTHORITY OF CARBON COUNTY, UTAH, as lessee, a nonprofit corporation organized under the laws of the State of Utah, and CARBON COUNTY, UTAH, as lessor, a political subdivision and body politic of the State of Utah, recorded March 21, 2008, as Entry No. 128286, in Book 668, at Page 418, of Official Records.

Assignment thereof, dated March 1, 2008, from and by THE MUNICIPAL BUILDING AUTHORITY OF CARBON COUNTY, UTAH, a Utah nonprofit corporation, assignor, to and in favor of THE STATE OF UTAH PERMANENT COMMUNITY IMPACT FUND BOARD, or any successor thereof, assignee, recorded March 21, 2008, as Entry No. 128287, in Book 668, at Page 439, of Official Records.

Amendment thereto, dated April 1, 2014, and recorded April 25, 2014, as Entry No. 824125, in Book 821, at Page 136, of Official Records.

Assignment thereof, dated March 1, 2014, THE MUNICIPAL BUILDING AUTHORITY OF CARBON COUNTY, UTAH, a Utah nonprofit corporation, assignor, to and in favor of THE STATE OF UTAH PERMANENT COMMUNITY IMPACT FUND BOARD, or any successor thereof, recorded April 25, 2014, as Entry No. 824126, Book 821, at Page 144, of Official Records.

See Item 21 below.

20. Notice of Lease Agreement dated March 1, 2008, by and between THE MUNICIPAL BUILDING AUTHORITY OF CARBON COUNTY, UTAH, a nonprofit corporation organized and existing under the laws of the State of Utah and CARBON COUNTY, UTAH, a political subdivision and body politic of the State of Utah, recorded March 21, 2008, as Entry No. 128288, in Book 668, at page 446, of Official Records.

Notice of Amendment thereto, dated April 1, 2014, and recorded April 25, 2014, as Entry No. 824127, in Book 821, at Page 153, of Official Records. (NOTE: Affects a portion of said land and other lands.)

See Item 21 below.

21. A Leasehold Deed of Trust, Assignment of Rents and Security Agreement to secure an indebtedness of the amount stated herein and any other amounts payable under the terms thereof.

Dated: March 1, 2008

Trustor: MUNICIPAL BUILDING AUTHORITY OF CARBON COUNTY, UTAH, a nonprofit corporation duly organized under the laws of the State of Utah

Amount: \$1,000,000.00

Trustee: PROFESSIONAL TITLE SERVICES

Beneficiary: STATE OF UTAH PERMANENT COMMUNITY IMPACT FUND BOARD, or any successor thereof

Recorded: March 21, 2008, as Entry No. 128289, in Book 557, at Page 453, of Official Records. Supporting Document

Amendment and Restatement thereto, dated April 1, 2014, in the amount \$6,500,000.00 and any other amounts payable under the terms thereof, and recorded April 25, 2014, as Entry No. 824128, in Book 821, at Page 164, of Official Records. (NOTE: Affects a portion of said land other lands.)

The foregoing items 18 through 21 reference a "Substitute Collateral" consisting in part of sub-parcels 2, 3, 5, 6, 7 and 8 of this survey as shown on Sheets 1 and 2.

22. Said property lies within the boundaries of Price City, and is subject to any charges and assessments levied thereunder.

Not addressed by this survey.

DESIGNED	CHECKED	DATE
DRAWN	CHECKED	DATE
SURVEYED	CHECKED	DATE
R.O.V.	CHECKED	DATE

PROJECT FILE: TYP0201000M ALTA OLD CARBON COUNTY...

**LEE M. SWASEY**  
PROFESSIONAL LAND SURVEYOR 163634

**ALTA / ACSM LAND TITLE SURVEY  
CARBON COUNTY COURTHOUSE**

SECTION	TOWNSHIP	RANGE	DATE	SCALE
21	14 S.	10 E.	1/22/15	1" = 20'
LOTS 3 and 4	BLOCK 28	TOWNSHIP	DRAWN BY JLK	

PROJECT No. \_\_\_\_\_  
SHEET No. 3 of 4