



SCALE: 1" = 60'

PURPOSE

THE PURPOSE OF THIS SURVEY WAS TO STAKE THE GIVEN DESCRIPTION AT THE DESCRIBED SITE.

N 0°09'32" E
650.00'

Proposed Detention Basin

N 89°47'16" E
550.00'

S 0°09'32" W
650.00'

N 89°47'16" E
296.00'

S 89°47'16" W
550.00'

BASIS OF BEARING
N 0°09'32" E 1347.79'

SOUTH 1/4 CORNER
SECTION 9
T 14 S, R 10 E,
S.L.B. & M.

DESCRIPTION

A PARCEL OF LAND LOCATED IN PRICE CITY, STATE OF UTAH, WHICH IS IN THE NORTHWEST QUARTER OF THE SOUTHEAST QUARTER OF SECTION 9, TOWNSHIP 14 SOUTH, RANGE 10 EAST, SALT LAKE BASE AND MERIDIAN AND BEING MORE PARTICULARLY DESCRIBED ACCORDING TO THE FOLLOWING COURSES AND DISTANCES, TO-WIT:

BEGINNING AT A POINT WHICH IS LOCATED NORTH 0°09'32" EAST, 1347.79 FEET AND NORTH 89°47'16" EAST 296.00 FEET FROM THE SOUTH QUARTER CORNER OF SECTION 9, TOWNSHIP 14 SOUTH, RANGE 10 EAST, SALT LAKE BASE AND MERIDIAN; RUNNING THENCE NORTH 0°09'32" EAST 650.00 FEET; THENCE NORTH 89°47'16" EAST, 550.00 FEET; THENCE SOUTH 0°09'32" WEST 650.00 FEET; THENCE SOUTH 89°47'16" WEST 550.00 FEET TO THE POINT OF BEGINNING.

CONTAINS 8.21 ACRES, MORE OR LESS.

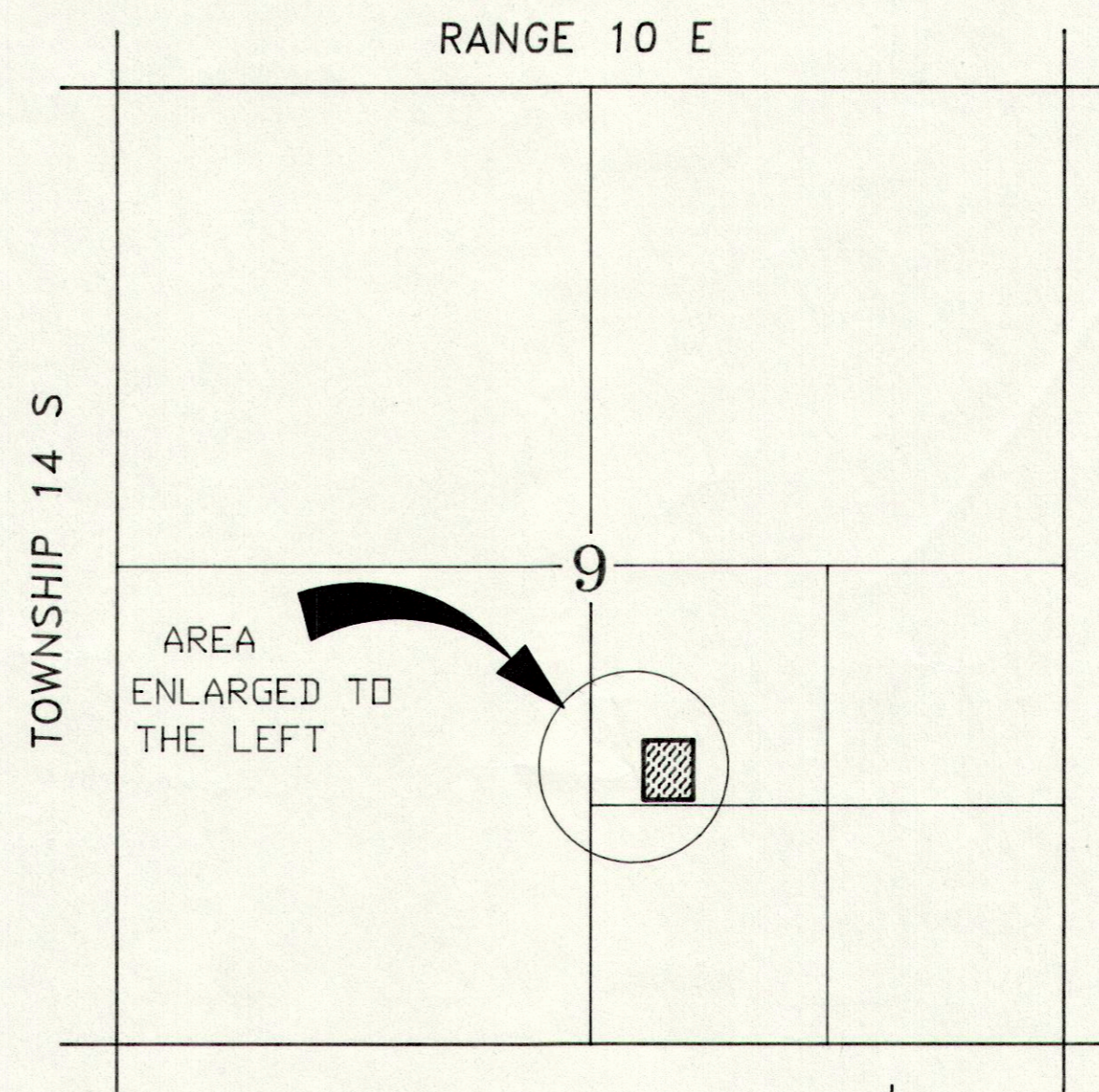

VICINITY MAP

SCALE: 1" = 1000'

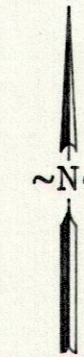

LEGEND

- INDICATES 5/8" x 24" REBAR SET W/ CAP
- 1/4 SECTION CORNER
- PROPERTY LINE
- SECTION LINE

ENGINEER'S CERTIFICATE

I, EVAN E. HANSEN, DO HEREBY CERTIFY THAT I AM A REGISTERED LAND SURVEYOR AND PROFESSIONAL ENGINEER HOLDING CERTIFICATES NO. 3115 AND NO. 3354 AS PRESCRIBED UNDER THE LAWS OF THE STATE OF UTAH. I FURTHER CERTIFY THAT I HAVE MADE A SURVEY OF THE TRACT OF GROUND SHOWN AND THAT IT IS TRUE AND CORRECT TO THE BEST OF MY KNOWLEDGE.

Evan E. Hansen
EVAN E. HANSEN

JUNE 27, 1994
DATE

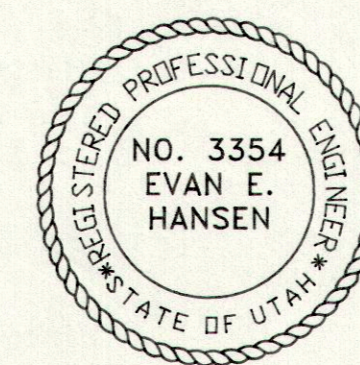
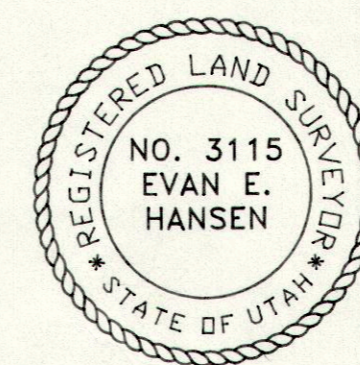

Empire Engineering & Land Surveying

1665 E. Sagewood Rd. Price, Utah 84301 Phone (801) 637-7498

Property Survey For:
PRICE CITY PROPOSED DETENTION BASIN

Drawn By: TLH	Approved By: EEH	Drawing No. EEPS-248
Date: 6/27/94	Scale: 1" = 60'	