

NARRATIVE

THE PURPOSE OF THIS SURVEY IS TO LOCATE A PORTION OF PARCELS 02-2200-0001 AND 02-2253-0000. AN UNRECORDED SURVEY BY EVAN HANSEN DATED NOVEMBER 16, 1991 WAS USED TO REESTABLISH THE CORNERS SHOWN HEREON. THE BASIS OF BEARING USED FOR THIS SURVEY IS N 00°35'04\"/>

CERTIFICATE OF SURVEY

I, M. CODY WARE, DO HEREBY CERTIFY THAT I AM A REGISTERED LAND SURVEYOR, CERTIFICATE NO. 4940688 AS PRESCRIBED BY THE LAWS OF THE STATE OF UTAH. I FURTHER CERTIFY THAT I HAVE MADE A SURVEY OF THE TRACT OF GROUND SHOWN AND THAT IT IS TRUE AND CORRECT TO THE BEST OF MY KNOWLEDGE. IT DOES NOT PURPORT TO SHOW ALL EASEMENTS OF RECORD, NOR IS IT PROOF OF OWNERSHIP.

DATE: March 7, 2017

M. Cody Ware
M. CODY WARE

737
E# 840857 & 903 by 757
Date: 12-MAR-2018 11:42:18AM
Fee: \$15.00 Check Filed By: CR
CARBON COUNTY RECORDER, Recorder
CARBON COUNTY CORPORATION
For: CODY WARE

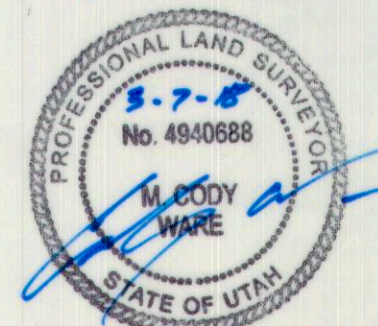

LEGEND

- PROPERTY LINE
- SECTION LINE
- SET 5/8\"/>

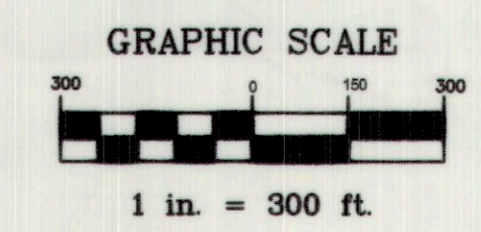

SURVEY FOR:		
SAMPINOS		
CARBON COUNTY, UTAH		
SECTIONS 9 & 16, TOWNSHIP 15 S., RANGE 10 E., S. L. B. & M.		
DRAWING RECORD		
NO.	DATE	DESCRIPTION
1	08-17-17	PLOTTED FOR REVIEW
		BY
		M.C.W.
WARE SURVEYING, L.L.C.		
Phone: 435-820-4335 Email: waresurveying@emerytel.com.net		1344 North 1000 West Price, Utah 84501