

CALCULATED  
NORTH QUARTER  
SEC. 7, T 15 S, R 11 E

BASIS OF BEARING S 0° 59' 03" E

CERTIFICATE

I, WACEY R. ALLRED, A PROFESSIONAL LAND SURVEYOR  
HOLDING UTAH CERTIFICATE NO. 11179291, DO HEREBY  
CERTIFY THAT THE PLAT SHOWN HEREON HAS BEEN  
PREPARED FROM A FIELD SURVEY MADE UNDER MY  
DIRECTION AND CORRECTLY SHOWS THE DIMENSIONS AND  
MONUMENTS OF THE PROPERTY DESCRIBED TO THE BEST  
OF MY KNOWLEDGE AND BELIEF.

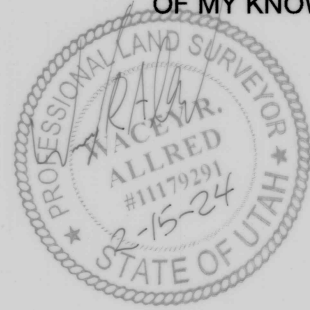

LEGEND

- SURVEYED BOUNDARY LINE
- SECTION LINE
- QUARTER SECTION LINE
- 40 ACRE LINE
- ADJOINING PARCELS
- EXISTING FENCE LINE
- DENVER & RIO GRANDE RAILROAD R.O.W
- CENTERLINE RAIL ROAD TRACK
- EXISTING ROAD
- WELLINGTON CITY LIMITS
- FOUND SECTION CORNER MONUMENT
- CALCULATED SECTION CORNER MONUMENT
- SET 5/8" REBAR WITH 1 1/2" RED PLASTIC CAP MARKED J&T ENG WRA LS 11179291

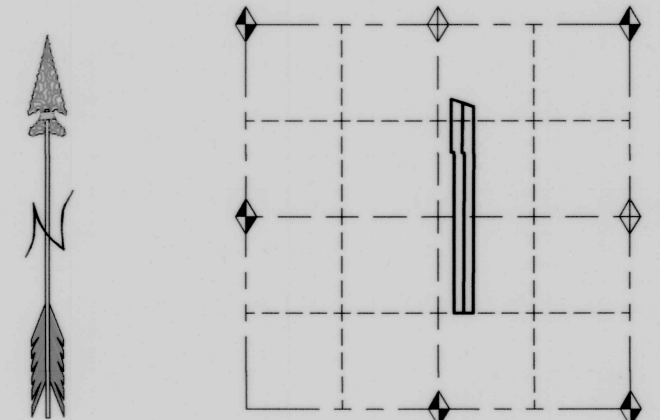

KEY MAP:  
SECTION 7, TOWNSHIP 15 SOUTH, RANGE 11 EAST

SURVEYOR'S NARRATIVE:

See sheet 1 of 2 for narrative.

SURVEYED DESCRIPTION:

Beginning at a point which is located N 89°17'07" E, 184.72 feet along the South line of the Northwest Quarter of the Northeast Quarter and N 00°46'06" W, 88.42 feet from the Southwest Corner of the Northwest Quarter of the Northeast Quarter of Section 7, Township 15 South, Range 11 East, SLB&M, said point being on the West boundary line of Tax Parcel No. 1B-0239-0001, Official Records of the Carbon County Recorder; thence N 89°17'07" E, 181.95 feet; thence N 00°46'06" W, 151.52 feet to the Southerly line of the Denver & Rio Gande Railroad right-of-way; thence N 71°37'59" W, 192.59 feet along said right-of-way to the Northwesterly corner of said Tax Parcel; thence S 00°46'06" E, 214.48 feet to the point of beginning. Containing 0.76 acre, more or less.

BASIS OF BEARING:

S 00°59'03" E, between the North Quarter Corner and the South Quarter Corner of Section 7, T 15 S, R 11 E, SLB&M. Based on GPS Observations.

1B-0240-0000  
CLINTON D. PRETTYMAN

1B-0239-0000  
BRIAN & CHELSEE  
EVANS

1B-0239-0001  
EDWARD &  
JAYLYNN PELL

1B-0239-0002  
EDWARD &  
JAYLYNN PELL

1B-0243-0001  
EDWARD &  
JAYLYNN PELL

FOUND CCS ALUMINUM CAP  
SOUTH QUARTER CORNER  
SEC. 7, T 15 S, R 11 E

SECTION	TOWNSHIP	RANGE	DATE	SCALE
7	15 S.	11 E.	2-5-24	1" = 50'
LOTS	BLOCK	SURVEY	DRAWN BY	
			WRA	

JD PELL  
P.O. BOX 783  
WELLINGTON, UTAH 84542

**phansen & tittle** ENGINEERING INC.  
P.O. Box 487, Castle Dale, UT 84513  
(435) 381-2523 Fax (435) 381-2522, e-mail jt@etv.net

WACEY R. ALLRED  
PROFESSIONAL LAND SURVEYOR 11179291

DESIGNED	CHECKED		
DRAWN WRA 2-24	CHECKED BHT W-24		
SURVEYED WRA 1-24	CHECKED TLT 2-24		
R.O.W.	CHECKED		
PROJECT FILE: T/PPS/2024 / JD Pell			