

WISSMAR SUBDIVISION

WEST QUARTER
 CORNER
 SECTION 31
 T-13-S R-10-E

N89°04'13"E 895.0'

HAYCOCK LANE

BASIS OF BEARING
 (2656.72)

CENTER
 SECTION 31
 T-13-S R-10-E

LYNN & NANCY
 THOMAS

LYNN & NANCY
 THOMAS

LOT #1
 DAN WISSMAR

THOMAS W HAYCOCK

BILL W. MARSTON

35' COUNTY ROAD

P.O.B.



TOWNSHIP 13 SOUTH

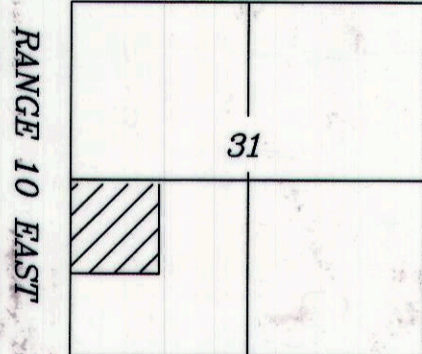

VICINITY MAP

LEGEND

- = PROPERTY LINE
- = 1/2" IRON PIN SET W/ CAP
- ⊕ = SECTION CORNER / QUARTER CORNER

SPECIAL NOTES

THIS SUBDIVISION WAS APPROVED WITH NO MAINTENANCE OF ROADS OR IMPROVEMENTS BY CARBON COUNTY. LOT OWNERS SHOULD LOOK TO ANY HOMEOWNERS ASSOCIATION OR THEMSELVES FOR ROAD AND IMPROVEMENTS MAINTENANCE.

GRAPHIC SCALE



SURVEYOR'S CERTIFICATE

I, ART F. BARKER DO HEREBY CERTIFY THAT I AM A REGISTERED LAND SURVEYOR, AND THAT I HOLD CERTIFICATE NO. 162812, AS PRESCRIBED BY THE LAWS OF THE STATE OF UTAH. I FURTHER CERTIFY THAT BY AUTHORITY OF THE OWNERS, I HAVE MADE A SURVEY OF THE TRACT OF LAND SHOWN ON THIS PLAT AND DESCRIBED BELOW, AND SUBDIVIDED SAID TRACT OF LAND INTO LOTS AND STREETS, HEREAFTER TO BE KNOWN AS:

WISSMAR SUBDIVISION

AND THAT THE SAME HAS BEEN CORRECTLY SURVEYED AND STAKED ON THE GROUND AS SHOWN ON THIS PLAT.

DESCRIPTION

BEGINNING AT A POINT LYING N89°04'13"E 895.0 FEET ALONG THE CENTER SECTION LINE AND S00°44'34"E 245.19 FEET FROM THE NORTHWEST CORNER OF THE SOUTH WEST QUARTER OF SECTION 31 TOWNSHIP 13 SOUTH RANGE 10 EAST OF THE SALT LAKE BASE AND MERIDIAN. RUNNING THENCE S00°44'34"E 250.0 FEET; THENCE N88°40'49"W 81.0 FEET; THENCE N55°32'20"W 133.46 FEET TO AN EXISTING COUNTY ROAD; THENCE ALONG SAID ROAD N00°44'34"W 169.52 FEET; THENCE N89°04'13"E 190.0 FEET TO THE POINT OF BEGINNING.

CONTAINING 42,813 SQ- FEET

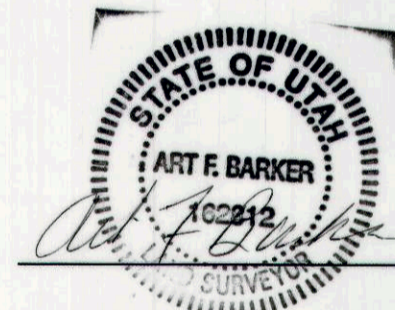

6/11/03
 DATE

OWNER'S ACKNOWLEDGMENT AND DEDICATION

KNOW ALL MEN BY THESE PRESENTS THAT we, THE 2 UNDERSIGNED OWNER(S) OF THE ABOVE DESCRIBED TRACT OF LAND, HAVING CAUSED SAME TO BE SUBDIVIDED INTO LOTS AND STREETS TO HEREAFTER BE KNOWN AS THE

WISSMAR SUBDIVISION

DO HEREBY APPROVE THIS PLAT AND DEDICATE FOR THE PERPETUAL USE OF THE PUBLIC ANY PARCELS OF LAND SHOWN ON THIS PLAT AS INTENDED FOR PUBLIC USE.

IN WITNESS WHEREBY we HAVE HERETO SET our hand THIS 15th DAY OF August A.D. 20 03

D. Dan Wissmar
Laura Wissmar

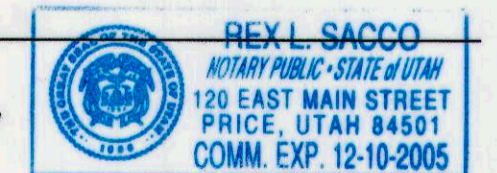

ACKNOWLEDGEMENT

STATE OF UTAH Carbon S.S.
 County of Carbon, City of Price
 On the 15th day of August A.D. 20 03, personally appeared before me, the undersigned Notary Public, in and for said County of Carbon, City of Price in said State of Utah, the signer(s) of the above Owner's Dedication, 2 in number, who duly acknowledged to me that they signed it freely and voluntarily and for the uses and purposes therein mentioned.

MY COMMISSION EXPIRES 12-10-2005 Rex L. Sacco
 NOTARY PUBLIC
 RESIDING IN Price CITY

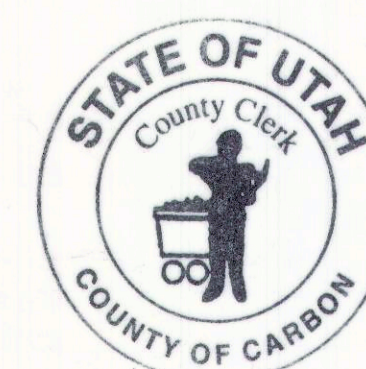

CARBON COUNTY PLANNING COMMISSION
 APPROVED THIS 15th DAY OF August A.D. 20 03
 BY THE COUNTY PLANNING COMMISSION
Richard Tatton CHAIRMAN

OFFICE OF CARBON COUNTY ENGINEER
 I HEREBY CERTIFY THAT THIS OFFICE HAS EXAMINED THIS PLAT AND IT IS CORRECT IN ACCORDANCE WITH INFORMATION ON FILE IN THIS OFFICE.
July 16, 2003
Evan E. Hansen
 EVAN E. HANSEN

APPROVAL AS TO FORM
 APPROVED AS TO FORM THIS 20th DAY OF August A.D. 20 03
Gene Strate
 GENE STRATE COUNTY ATTORNEY

COUNTY COMMISSIONER SURVEYOR
Steven D. Burge
 STEVEN D. BURGE COMMISSIONER SURVEYOR DATE: 8-20-03

COUNTY COMMISSION PRESENTED TO THE SITE PLAN REVIEW COMMITTEE ON THIS 20th DAY OF August A.D. 20 03, AT WHICH TIME THIS SUBDIVISION WAS APPROVED AND ACCEPTED.
Michael S. Melovich
 MICHAEL S. MELOVICH CHAIRMAN DATE: 8-20-2003
Robert P. Pero
 ATTEST: ROBERT P. PERO COUNTY CLERK

RECORDED #101029
 STATE OF UTAH, COUNTY OF CARBON, COUNTY OF CARBON
 RECORDED AND FILED AT THE REQUEST OF Sharon Murdock
 DATE 8/19/03 TIME 2:26 PM BOOK 5 PAGE 63
3000 FEE \$
 SHARON MURDOCK COUNTY RECORDER

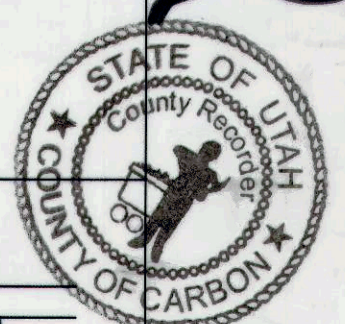

WISSMAR